



THE SYSTEM AT A GLANCE

VIVARES LIGHT MANAGEMENT

MAY 2021



LEDVANCE.COM



LEDVANCE

LEDVANCE: ADVANCING LIGHT

WHAT MAKES US DIFFERENT? COMFORT. WE'VE NAILED IT

With over 100 years of experience in general lighting, LEDVANCE combines traditional lighting technology with pioneering lighting innovations for almost any application. In addition to this unique know-how, we particularly rely on long-term customer relationships and a strong global sales network.

As technology trend experts, we are leading the way in meeting the rapidly changing demands for high-quality and long-lasting light. And as a strong local partner, we are always reliably at your side in over 140 countries.

Whether it's luminaires, lamps, our LED Strip System or state-of-the-art light management solutions, our teams of specialists are focused on the specific needs of our customers. We are making a decisive contribution to increasing your competitiveness with technical innovations and easy-to-use, intelligent lighting solutions compliant with EU regulations.

With LEDVANCE VIVARES, our future-proof IoT light management system for office solutions, we now provide significantly more comfort in every respect. From configuration and installation to operation, VIVARES makes it easier than ever to bring connected light to life. The optional use of the VIVARES Cloud services offers convenient remote diagnosis and energy monitoring for additional savings.

We always focus on the benefit for you as a lighting professional. That's why we do everything we can to make our products and systems particularly easy to plan, install and combine.

Based on these principles, we will continue to develop sophisticated products and provide you with optimum support in your personal fight against bad light.



CONTENTS

LEDVANCE: ADVANCING LIGHT	02
VIVARES: LIGHT MANAGEMENT, MORE COMFORTABLE THAN EVER	04
VIVARES CLOUD SERVICES: MONITORING AND OPTIMIZATION	06
CASE STUDY: OFFICE BUILDING, MOLLSHEIM/FRANCE	08

VIVARES ZIGBEE

VIVARES ZIGBEE – WIRELESS: FUNCTION AND OPERATION	10
COMMISSIONING	12
PRODUCT RANGE	
– LMS COMPONENTS	14
– LUMINAIRES/ACCESSORIES	20
BIOLUX HCL – BENEFITS AND APPLICATION	36
BIOLUX HCL AND VIVARES ZIGBEE HCL	37
BIOLUX HCL PRODUCT RANGE	39



VIVARES DALI

VIVARES DALI – WIRED: FUNCTION AND OPERATION	40
COMMISSIONING	42
PRODUCT RANGE	
– LMS COMPONENTS	44
– LUMINAIRES/ACCESSORIES	58
FURTHER INFORMATION ON SERVICES, LEDVANCE AND ABBREVIATIONS	76



VIVARES: LIGHT MANAGEMENT,

VIVARES, the future-proof IoT light management system (LMS) from LEDVANCE, brings light to life. It makes it easier and more flexible than ever to always produce optimum lighting conditions for defined requirements. The system is suitable for all office solutions and is extremely reliable and compatible. LEDVANCE offers you everything from one source: all LMS components and matching LED luminaires.

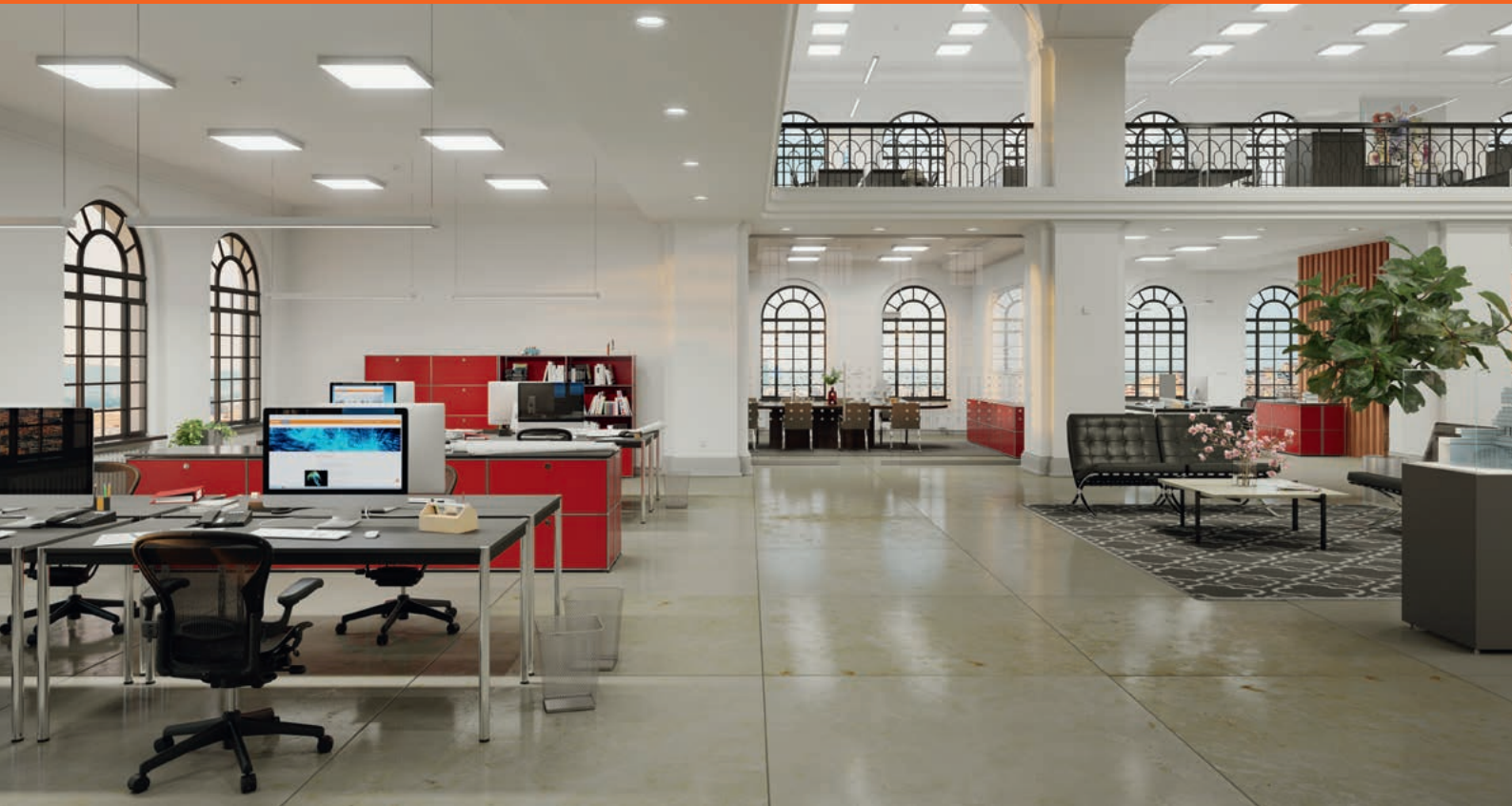

WIRELESS, MODERN, FLEXIBLE: VIVARES ZIGBEE

YOUR IDEAL SOLUTION IF YOU CAN'T MAKE TOO MANY STRUCTURAL CHANGES AND/OR ARE LOOKING FOR FLEXIBLE ROOM SITUATIONS.

The wireless VIVARES Zigbee system is ideal for modernizing existing buildings where rewiring is often not an option. If a building is listed or has no suspended ceilings, you will need products that require no additional control lines. Even in situations where the distribution of light needs changing more often, VIVARES Zigbee is the perfect choice because the system is easy to adapt.

LEDVANCE offers you the necessary components and a well-assorted selection of compatible LED luminaires which allow the VIVARES Zigbee system to provide energy-saving lighting in existing buildings. As an option, the system can be connected to a cloud application to generate maintenance and energy consumption reports.

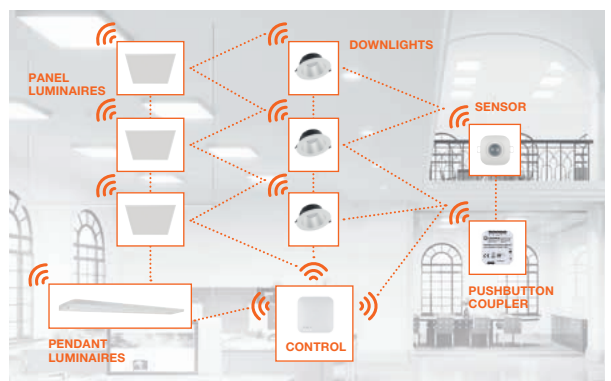

VIVARES Zigbee in an existing building: panel luminaires, downlights and pendant luminaires are wirelessly connected to the VIVARES Zigbee controller and sensors.

MORE COMFORTABLE THAN EVER

Another advantage of the portfolio is its great flexibility. Whether you go for the wireless option via VIVARES Zigbee or the wired version based on DALI technology, we always have the right solution for you and support you every step of the way. But what you can expect from both technologies is that they are extremely comfortable and easy to install by anyone.

WIRED INDUSTRY STANDARD REDEFINED: VIVARES DALI

VIVARES DALI IS IDEAL FOR NEW BUILDINGS AND RENOVATIONS, WITH ROOM FOR ADDITIONAL CONTROL LINES.

The system is suitable if the control lines can be wired and the requirements for assigning the light distribution are long-term. All VIVARES DALI products are DALI-2-certified and technically matched to perfection. Since this is an open system, it is also compatible with other DALI-2 products.

Commissioning is simple and self-explanatory via a browser-based commissioning tool. And of course VIVARES DALI is also ready for the Internet of Things (IoT) – and therefore capable of generating maintenance and energy consumption reports via the VIVARES Cloud.

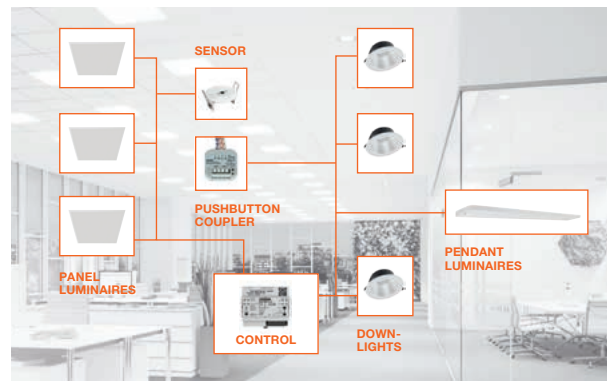

VIVARES DALI in a new office building: panel luminaires and downlights are integrated into the suspended ceilings and, using cables, are connected to the LMS components such as sensors. Additionally, pendant luminaires were installed in the conference room.



KEEP AN EYE ON EVERYTHING: CLOUD SERVICES FOR VIVARES DALI AND VIVARES ZIGBEE



Welcome to the Internet of Things! Using the VIVARES Cloud, you now have access to the data of your lighting system from anywhere. This allows you to make its operation even more efficient, reliable, energy-saving and cost-effective.

The cloud services for VIVARES DALI and VIVARES Zigbee enable you to optimize your lighting system wherever you are. With the intuitive dashboard you can monitor energy consumption, the operating hours of the drivers and the relevant lighting data, among other things. Various filter functions give you the option of analyzing the data according to your needs.

SERVICE THAT IS WELL WORTH IT

- Optimize your energy consumption
 - Reduce maintenance costs – adapt the maintenance cycle to actual demand
 - Diagnose faults from any location.
- All you need is internet access and a tablet/PC
- Future-proof with the option of new services

VIVARES CLOUD SERVICES: ACCESS IN A FEW STEPS



BEFORE YOU START

- Make a note of the serial number (ID number) of your VIVARES Zigbee or DALI controller
- Electrify all the installed luminaires and components



START REGISTRATION

To do this, go to:
ledvance.com/vivares-cloudservice



ORDER FORM

Enter the required information in the order form

SERVICES FOR EVEN MORE EFFICIENT OPERATION



ENERGY MONITORING

Get detailed insights into the energy consumption of the lighting system. Its energy costs can be reduced even further through monitoring.

A selling point that will convince price-conscious and eco-friendly customers in particular.



DASHBOARD

The dashboard is the central tool for accessing the VIVARES Cloud services.

Everything is clearly laid out and very user-friendly, which makes using services such as energy monitoring and predictive remote diagnosis very comfortable.



MAINTENANCE ASSISTANT

Via remote access, you can keep an eye on the status of the system and its components.

Fault diagnosis and information on lifetime allow maintenance to be predictive, cost-saving and particularly reliable.

This service is not required for operating the VIVARES systems. It is an optional service that offers you additional possibilities.



RECEIVE CONFIRMATION

You will receive your registration confirmation by email within a few business days.

This email contains a link for your secure access to the cloud services.



NEED ANY HELP?

Our support team will be happy to assist you. Just send an email to:

shop.vivares@ledvance.com



FREE TRIAL ACCESS

Would you like to learn more about our cloud services – with no strings attached? Then take advantage of our free trial.

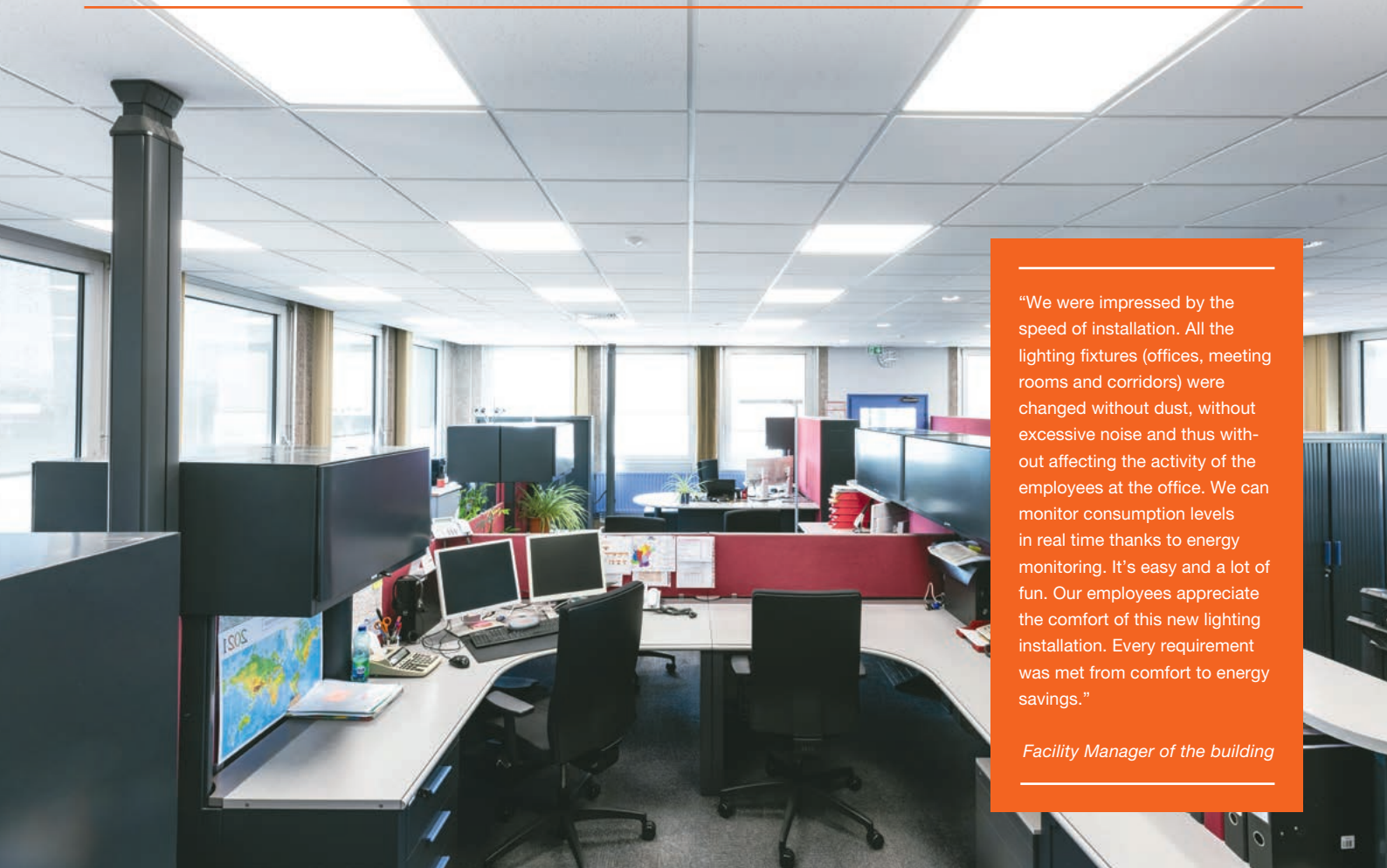

“We were impressed by the speed of installation. All the lighting fixtures (offices, meeting rooms and corridors) were changed without dust, without excessive noise and thus without affecting the activity of the employees at the office. We can monitor consumption levels in real time thanks to energy monitoring. It’s easy and a lot of fun. Our employees appreciate the comfort of this new lighting installation. Every requirement was met from comfort to energy savings.”

Facility Manager of the building

COMFORT – SAVINGS – SIMPLICITY

A 100 % AUTOMATED SYSTEM

LEDVANCE LUMINAIRES COUPLED WITH VIVARES ZIGBEE GUARANTEE QUALITY OF LIGHT AND COMFORT OF USE.



THE CHALLENGE

Achieving energy savings while ensuring a high level of illumination, modernizing the existing traditional lighting with state-of-the-art technology as simply as possible – these were the objectives of this renovation. This renewal also had to meet the requirements of the 2019 tertiary decree and the lighting pollution decree which aim to reduce energy consumption and automatically turn off the lights at night.

THE SOLUTION

All traditional luminaires were replaced with an LED lighting solution in combination with VIVARES Zigbee. This light management system, coupled with presence and light sensors, ensures a significant reduction in energy consumption and offers functionalities such as the creation of maintenance and energy consumption reports via the VIVARES Cloud. In one of the open-plan offices 105 PANEL PERFORMANCE and 10 DOWNLIGHT PERFORMANCE luminaires were installed.

The meeting room has been modernized with 11 DOWNLIGHT PERFORMANCE and 4 PANEL DIRECT/INDIRECT luminaires.

All luminaires installed are in UGR < 19 and with Zigbee technology. With VIVARES Zigbee, scenarios have been predefined so that the user can choose lighting scenes according to their activity (work meeting, presentation). The corridors were refurbished with 30 DOWNLIGHT PERFORMANCE luminaires. To allow full automation of the lighting system, 38 VIVARES Zigbee sensors were installed in the offices, corridors and stairs.

The lighting automatically turns on when the first employee arrives and turns off when the premises are unoccupied. Pushbutton-couplers have also been installed to allow users to dim the lighting as required or select a predefined scene. The last person to leave the building in the evening can also manually turn off the lights. However, the system automatically turns off the lights if no person is detected.

THE BENEFITS

VIVARES Zigbee offers many advantages.

► FOR PROJECT INSTALLERS:

The luminaires were replaced 1:1 and the system is controlled through a wireless Zigbee connection between luminaires, VIVARES controller and sensors. Thanks to the online configuration tool, VIVARES Portal, the project could be configured in advance of the installation. This saved valuable time for commissioning on the day of installation. Pairing was done easily and intuitively via QR codes: they were simply placed on the installation tab available in the VIVARES Portal and then scanned via the VIVARES application. Simple and efficient!

► FOR USERS:

The system automatically adjusts the light level, regardless of how much natural light is available during the day or in the evening. This ensures a constant brightness level at all times. It also saves energy and guarantees comfort. In addition, automatic switch-on thanks to presence detection is an interesting aspect. Each employee can also select predefined scenes according to the current activity, for example a presentation scene during a meeting. The right lighting at the right time!

► FOR BUILDING OWNERS/FACILITY MANAGERS:

Thanks to the monitoring function, the facility manager can view the status of each luminaire in real time via a dashboard (lifetime, turn-on time, level of consumption). On the one hand, this makes it easier to anticipate maintenance operations and, on the other, to obtain a detailed report of the consumption information to be sent to the government agency. Remotely, the technician can also change the parameters on the sensors, the lighting timings and the switch-on times, if necessary.

COMPONENTS

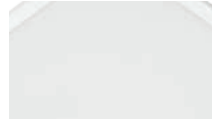

PANEL PERFORMANCE
ZIGBEE



PANEL DIRECT/INDIRECT
1200 UGR < 19 ZIGBEE



DOWNLIGHT
UGR19 ZIGBEE



VIVARES ZB
Control



VIVARES ZB L/O
SENS 220-240

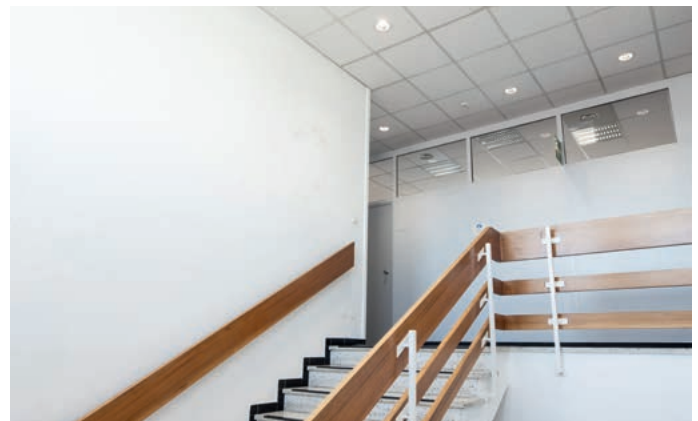

SUMMARY

The LEDVANCE VIVARES Zigbee wireless light management system allowed direct and easy replacement of the luminaires without any structural modification of the building or complex rewiring. Coupled with a detection system, the energy savings for the company are high.

This light management system also meets the requirements of the tertiary decree which mandates a reduction in energy consumption in buildings, as well as the french lighting pollution decree, which requires automatic turn-off at night when the building is not occupied.

In addition, the monitoring function of the VIVARES Cloud enables detailed reports on energy consumption and an overview of the status of all devices. With VIVARES, it is so easy to enter the age of connectivity.

VIVARES ZIGBEE: FUNCTIONALITY, INSTALLATION

THE KEY COMPONENT OF VIVARES ZIGBEE IS THE CONTROLLER.

VIVARES Zigbee Control communicates wirelessly with up to 200 Zigbee-ready devices via Zigbee 3.0. These include the VIVARES Zigbee luminaires, sensors, pushbutton couplers and a Zigbee DALI converter for the additional integration of DALI-2 luminaires.

Potential applications range from small lighting projects to complete floor solutions. And even after commissioning, expanding the system with additional components is no problem at all. The system and its components are very easy to configure and commission via the VIVARES Portal (p. 12). And it can also be maintained remotely using the VIVARES Portal.

New software features are continually integrated into the system through online updates. But it doesn't need an internet connection for commissioning and operation.



3D view of balanced positioning of sensors and light sources to achieve the desired light distribution.

VIVARES ZIGBEE IN USE

Application	L/O sensor ¹	O sensor ²	Function	Setting	Pushbutton coupler	Function	Arrangement
Open-plan office	✓	–	Daylight control and presence detection	Sensor delay 5 min. Daylight control active	✓	ON/OFF/DIM/scenes	One sensor per luminaire group (workplace)
Meeting room	✓	✓	Optional daylight control (e.g. for rooms with glass walls) and presence detection	Sensor delay 5 min. Daylight control active	✓	ON/OFF/DIM/scenes	Depending on the detection range of the sensor (the sensor is usually positioned in such a way that the entrance area and the conference table are detected at the same time. If both are not detected at the same time, install a second sensor.)
Restrooms	–	✓	Motion and presence detection	Sensor delay 5 min.	✓	ON/OFF	A separate sensor for each toilet cubicle. Other than that, cover the entrance areas and common areas (sinks, urinals, etc.).
Kitchen	✓	–	Motion and presence detection	Sensor delay 5 min. Daylight control active	✓	ON/OFF/DIM	Cover areas by the window with L/O sensor (same requirement as for open-plan offices)
Corridor	✓	✓	Motion and presence detection	Sensor delay 5 min.	✓	ON/OFF/DIM	
Warehouse, lab, etc.	✓	✓	Motion and presence detection	Sensor delay 5 min.	✓		

Project size	up to 200 devices		
Distance from ZB products (indoors)	10 m max. for stable and reliable operation		
Installation tools	router	LAN cable	mobile device
VIVARES Portal	Contains templates for the above-mentioned rooms. The products matching the room are automatically suggested in the VIVARES Portal.		

¹ L/O = light and occupancy | ² O = occupancy

AND OPERATION

Good reasons for choosing VIVARES Zigbee:

- Ideal for modernizing existing buildings where no rewiring is needed
- Based on the international Zigbee 3.0 standard
- Quick and easy installation and QR code-based commissioning
- Simple reconfiguration of the components when the use of rooms changes
- Maintenance and energy consumption reports from anywhere

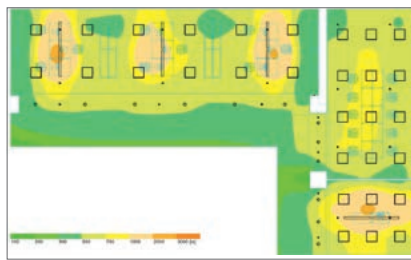
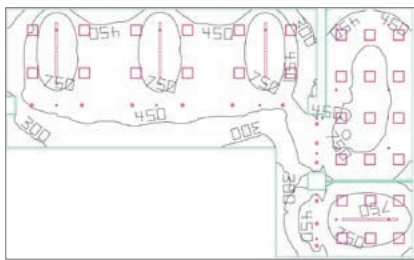

Lighting calculation from LEDVANCE combines matching LMS components and luminaires for optimal lighting. These are illustrative layouts with isolines or lux values.

FUTURE-PROOF OPTIONS

Thanks to its gateway function, the controller also provides the option of using LEDVANCE VIVARES Cloud services to generate maintenance and energy consumption reports.

Our experts are happy to support you in planning and implementing your light management system. Just get in touch at: kundenservice@ledvance.com

TRAIN HARD, REAP THE REWARD: LEDVANCE TRAINING FOR PROFESSIONALS

LEDVANCE gives you the option of deepening your expertise in light management. You can choose from different courses:

1. Our online training center includes training modules where you can learn all about Zigbee technology and individual light management components. Visit training.ledvance.com for our online training courses.
2. Our YouTube channel is packed with product training videos, commissioning instructions and more. Check them out at ledvance.com/zigbeevideos

VIVARES ZIGBEE: WIRELESSLY CONNECTED AND READY FOR THE INTERNET OF THINGS (IOT)

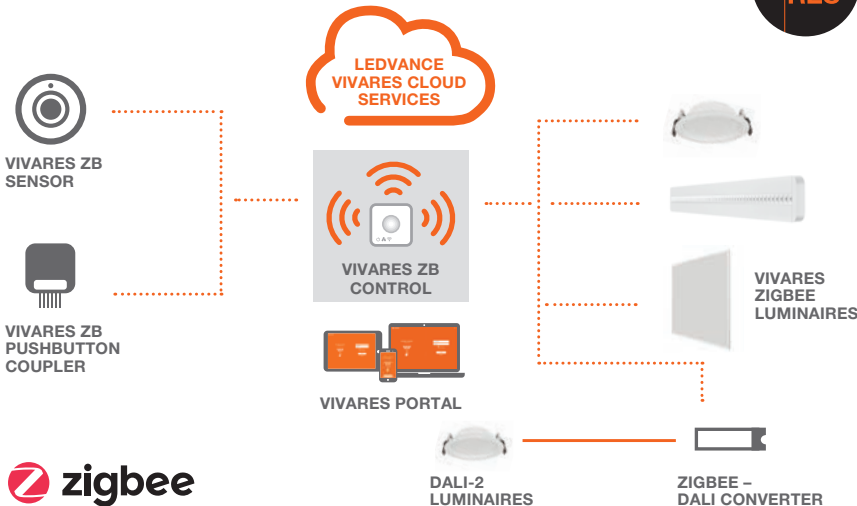

Take advantage of this opportunity and gain valuable knowledge that keeps you ahead of the competition.

MAKE YOURSELF COMFORTABLE CONFIGURING AND COMMISSIONING USING THE VIVARES PORTAL

Projects, rooms, devices or groups can be adjusted very quickly and from anywhere with VIVARES Zigbee. What's more, it requires no complicated programming because you work with predefined rooms or situations. And commissioning itself is as quick as a flash with the support of QR codes.

To ensure a smooth workflow, you can also invite all participants to the project. The portal is self-explanatory and intuitive. It is available for iOS and Android mobile devices as well as for PCs. Simply download the free VIVARES app from the respective app store or log into the browser-based PC version!



The VIVARES Zigbee installation video (ledvance.com/zigbeevideos) shows you how easy it is to commission the system components. Be inspired!

FROM PROJECT PLANNING TO OPERATION IN 5 STEPS



1. CREATE AN ACCOUNT

Register on the VIVARES Portal, create your account and log in:
portal.vivares.ledvance.com



2. PLAN AND PRECONFIGURE IN THE VIVARES PORTAL

- Create a project
- Upload the building plan
- Create rooms
- Add luminaires and components
- Configure groups, scenes and schedules



3. ORDER

- Download the parts list from the portal
- Order the products through the trade partner



4. COMMISSION

- Download the QR code installation booklet
- Install the luminaires/components on site, pull off the QR codes and stick them in the QR code installation booklet
- Scan the QR codes using a mobile device and the VIVARES app
- Connect the VIVARES Zigbee control and mobile device to the local network
- Upload the preconfiguration from step 2 to the VIVARES Zigbee control
- The network is set up automatically in the background



5. FINALIZE AND OPERATE

- Test the lighting system and get customer acceptance
- Remote access for post installation adjustments
- Optional VIVARES Cloud services: create maintenance and energy consumption reports (find out more from page 6)

INTUITIVE AND SELF-EXPLANATORY: WORKING WITH THE VIVARES PORTAL

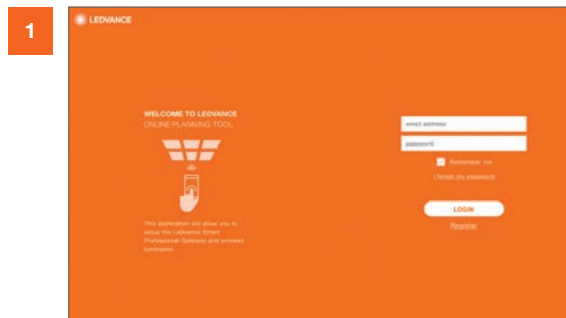

Registration and login



Projects and project status

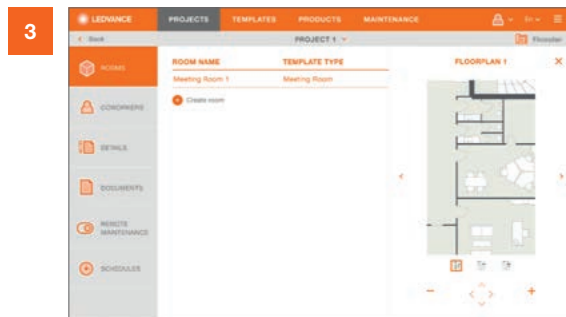

Create rooms

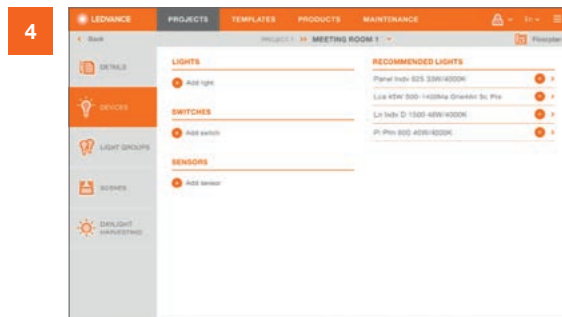

Add luminaires and components

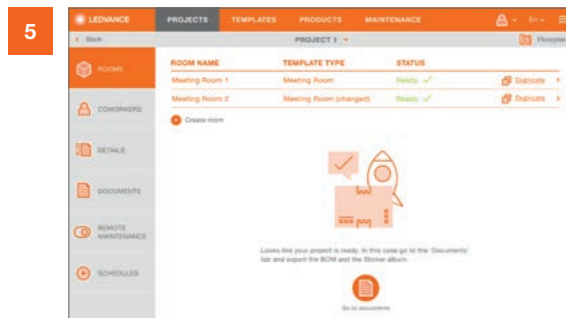

Configuration complete:
The parts list is available.

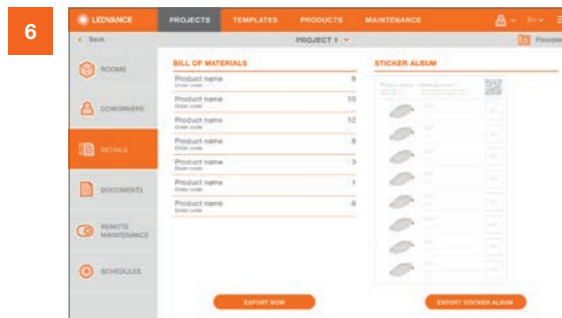

Parts list and QR code installation booklet



Scan the QR codes using a mobile device and the VIVARES app

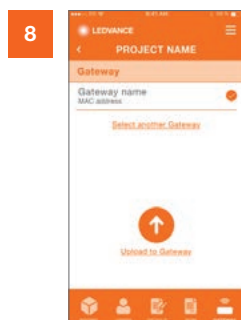

Upload the pre-configuration to the VIVARES control

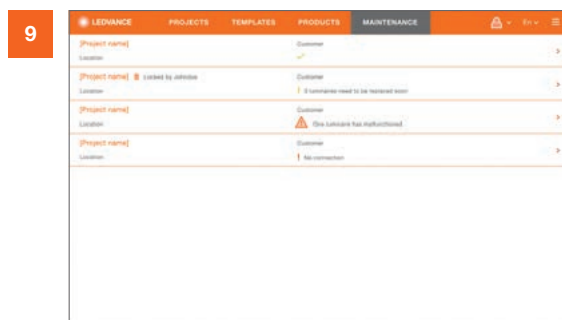

Remote access for post installation adjustments

CONTROLLER ZIGBEE

Zigbee 3.0 controller with integrated gateway for small to mid size projects up to 200 endpoints



PRODUCT FEATURES

- Lighting control unit based on wireless Zigbee 3.0 technology
- IoT ready thanks to built-in gateway
- Connect up to 200 endpoints in one network
- Built-in Human Centric Lighting control
- QR-Code based commissioning of all lighting system components

PRODUCT BENEFITS

- Pre-configuration allows efficient planning & configuration of entire project remotely
- QR-code based commissioning enables automatic configuration of system
- Local operation of system even without active internet connection possible
- Remote access functionality saves time for post-installation adjustments
- Wireless communication avoids re-wiring in case of renovations

AREAS OF APPLICATION

- Room control, floor control, daylight-dependent control
- Connection of light and presence sensors in Zigbee systems
- Conference rooms
- Offices: Individual and group workplaces
- Suitable for indoor applications

FURTHER PRODUCT DETAILS

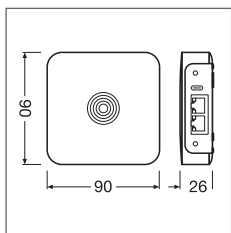

TECHNICAL DATA

Product name	GTIN (EAN)	V _{IN}	Hz	I _{IN}	T _a	Mounting/Wall/ Mounting/Ceiling	COLOR	L × W × H [mm] Ø × H [mm]
VIVARES ZB CONTROL	4058075427488	5	0	1	-20...+45 °C	Mounting/Wall/ Mounting/Ceiling	Signal white	90 × 90 × 26

¹ Refer to www.ledvance.com/guarantee for precise conditions

SENSOR ZIGBEE

Zigbee 3.0 light and presence sensor, ceiling integration



IP 20



PRODUCT FEATURES

- Wireless Zigbee 3.0 light and presence sensor for ceiling integration
- Perfect fit for office application
- Presence detection via passive IR element
- AC mains powered 220–240V
- Mounting height: 2...5m

PRODUCT BENEFITS

- Works together with VIVARES ZB Control & Components
- Easy installation and no control wires needed
- 5 years guarantee

AREAS OF APPLICATION

- Offices
- Corridors
- Classrooms
- Training rooms
- Stairways
- Sanitary areas

FURTHER PRODUCT DETAILS

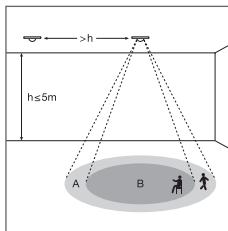
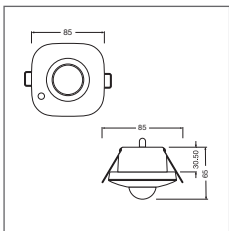

Detection area of the sensor in meter

h	2.5	3.0	3.5	4.0	5.0
A	6.5	7.5	8.0	8.5	9.0
B	3.5	4.5	4.5	4.0	–

FITTING COMPONENTS



VIVARES ZB SENS ADAPTER
4058075650107

Zigbee Sensor adapter for surface mounted ceiling installation

TECHNICAL DATA

Product name	GTIN (EAN)	V _N	Hz	Beam angle	Beam diameter	Lx	ihm	Ta	Mounting	COLOR	L x W x H [mm] Ø x H [mm]
VIVARES ZB L/O SENS 220-240	4058075446182	220–240	50/60	90°	7m	10...2000	2...5	–20...+50 °C	Recessed	White	85 × 85 × 64

¹ Refer to www.ledvance.com/guarantee for precise conditions

The pictures shown in the catalog are for illustration purposes only. For information on size and color, please refer to the product table.

SENSOR ZIGBEE

Zigbee 3.0 presence sensor, ceiling integration



IP 20



PRODUCT FEATURES

- Wireless Zigbee 3.0 presence sensor for ceiling integration
- Perfect fit for office application
- Presence detection via passive IR element
- AC mains powered 220–240V
- Mounting height: 2...5m

PRODUCT BENEFITS

- Works together with VIVARES ZB Control & Components
- Easy installation and no control wires needed
- 5 years guarantee

AREAS OF APPLICATION

- Offices
- Corridors
- Classrooms
- Training rooms
- Stairways
- Sanitary areas

FURTHER PRODUCT DETAILS

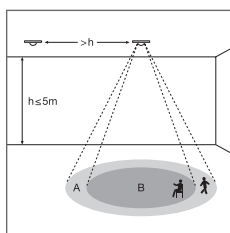
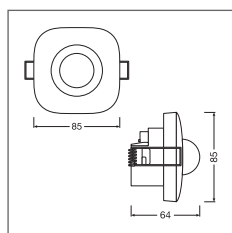

Detection area of the sensor in meter

h	2.5	3.0	3.5	4.0	5.0
A	6.5	7.5	8.0	8.5	9.0
B	3.5	4.5	4.5	4.0	–

FITTING COMPONENTS



VIVARES ZB SENS ADAPTER
4058075650107

Zigbee Sensor adapter for surface mounted ceiling installation

TECHNICAL DATA

Product name	GTIN (EAN)	V _{IN}	Hz	Beam angle	Lx	Beam diameter	Ta	Mounting	COLOR	L × W × H [mm]	
VIVARES ZB 0 SENS 220-240	4058075 544222	220–240	50/60	90°	7m	–	5	–20...+50 °C	Recessed	White	85 × 85 × 64

¹ Refer to www.ledvance.com/guarantee for precise conditions

The pictures shown in the catalog are for illustration purposes only. For information on size and color, please refer to the product table.

CONTROL ELEMENT ZIGBEE

Zigbee 3.0 pushbutton coupler to integrate standard switches into a wireless lighting system



IP20



PRODUCT FEATURES

- Pushbutton coupler with wireless Zigbee 3.0 technology
- AC mains or DC operation possible

PRODUCT BENEFITS

- Works together with VIVARES ZB Control & Components
- 4 fully programmable inputs for individual control
- Control rooms, groups, devices and recall scenes
- Small dimensions allow mounting in standard flush box
- Quick and easy installation without additional control cables

AREAS OF APPLICATION

- Offices
- Corridors
- Classrooms
- Training rooms
- Stairways
- Sanitary areas

FURTHER PRODUCT DETAILS

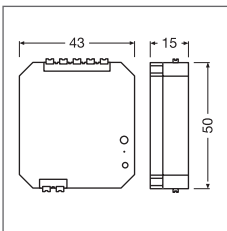

TECHNICAL DATA

Product name	GTIN (EAN)	V _{IN}	Hz	T _a	Installation	No. of OUTPUTS	L × W × H [mm] Ø × H [mm]
VIVARES ZB COUPLER	4058075463806	100–240	50/60	–20...+50 °C	Recessed	4	50 × 43 × 15

¹ Refer to www.ledvance.com/guarantee for precise conditions

ZIGBEE 3.0 DALI CONV LI

Converter to integrate DALI luminaires into Zigbee-based control systems



PRODUCT FEATURES

- Integrated Zigbee transceiver module
- DALI interface for addressed or broadcast operation
- Outputs with electrical reversible overtemperature, short-circuit, overload protection
- 1–2 DALI control gears in addressed mode
- 3–8 DALI control gears in broadcast mode

PRODUCT BENEFITS

- Support standard DALI and DALI DT8 (Tunable White) control gears
- Automatic operating mode detection after each restart
- Zigbee 3.0 certified including enhanced security standard
- Synchron switching and dimming of up to 8 DALI control gears
- Reliable dimming through digital control of the drivers

AREAS OF APPLICATION

- Smart Homes
- Offices

EQUIPMENT/ACCESSORIES

- Ceiling or independent installation via ECO CI KIT possible

FURTHER PRODUCT DETAILS

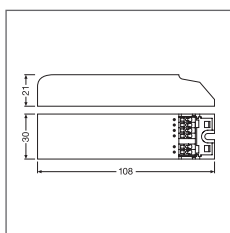

TECHNICAL DATA

Product name	GTIN (EAN)	V _N	Hz	T _a	No. of OUTPUTS	L × W × H [mm] Ø × H [mm]
Zigbee 3.0 DALI CONV LI	4062172044776	220–240	50/60	–20...+60 °C	Luminaire integration/ Independent mounting	1 108 × 30 × 21

SENSOR ZIGBEE ADAPTER

Zigbee Sensor adapter for surface mounted ceiling installation



Adapter with sensor

FITTING COMPONENTS



**VIVARES ZB
L/O SENS 220-240**
4058075446182

Light and presence
sensor



**VIVARES ZB
O SENS 220-240**
4058075544222

Presence sensor

TECHNICAL DATA

Product name	GTIN (EAN)	MATERIAL	COLOR	L × W × H [mm] Ø × H [mm]
VIVARES ZB SENS ADAPTER	4058075 650107	PC	White	83 × 83 × 40

PANEL INDIVILED® ZIGBEE

Square recessed luminaire with IndiviLED® optics, with Zigbee 3.0 technology



PRODUCT FEATURES

- IoT-ready luminaire with Zigbee 3.0 technology
- Each LED with individual lens and reflector for UGR < 16 and homogenous light distribution
- Lifetime (L80/B50): up to 50 000 h (at 25 °C)
- Metal housing, polycarbonate (PC) lenses and reflectors
- Luminous flux: up to 4 000 lm

PRODUCT BENEFITS

- Suitable luminaire for VIVARES and other Zigbee 3.0 Light Management Systems
- Homogenous light distribution and reduced glare thanks to the IndiviLED® optics
- Energy savings of up to 50 % (compared to luminaires that use fluorescent lamps)
- Robust structure with IK08
- Low flicker light thanks to special electronic control gear

AREAS OF APPLICATION

- Direct replacement for luminaires with fluorescent lamps
- Corridors
- Offices
- Conference rooms
- Reception areas

EQUIPMENT/ACCESSORIES

- Accessories for several mounting options available
- Security rope for luminaire included
- External control gear included

FURTHER PRODUCT DETAILS

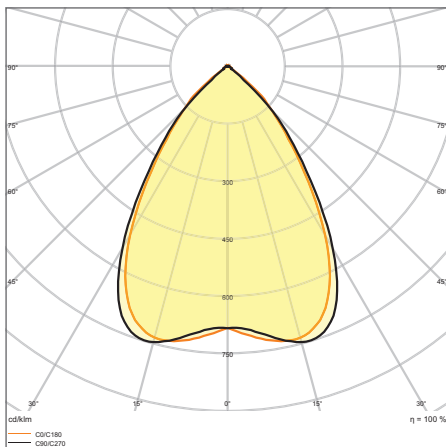

PL INDV 625 33W4000K ZBVR

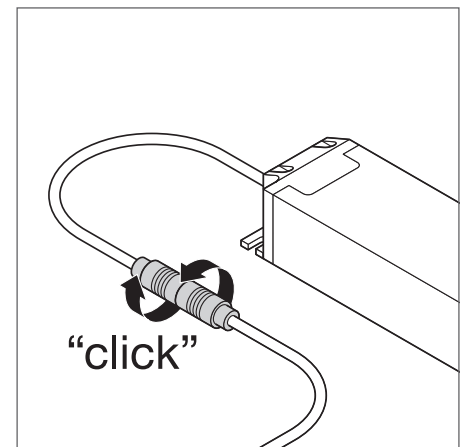
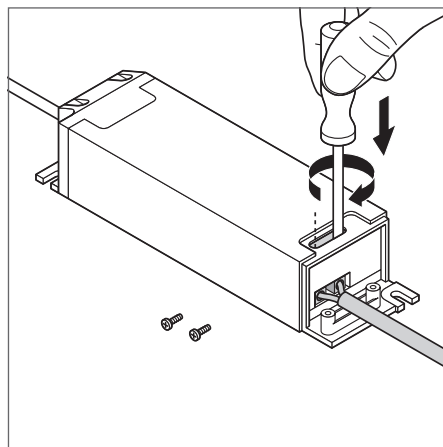

¹ Refer to www.ledvance.com/guarantee for precise conditions

The pictures shown in the catalog are for illustration purposes only. For information on size and color, please refer to the product table.

PANEL INDIVILED® ZIGBEE

Square recessed luminaire with IndiviLED® optics, with Zigbee 3.0 technology

Product name	Segmentation	GTIN (EAN)	RE-PLACEMENT FOR	W	lm	lm/W	K	L70 ¹	L80 ¹		
PL INDV 600 ZIGBEE 33W 4000 K	■	4058075521841	4 x 18W/4 x 14W FL	33	4 000	115	4 000	80 000	60 000	70	✓
PL INDV 625 ZIGBEE 33W 4000 K	■	4058075521865	4 x 18W/4 x 14W FL	33	4 000	115	4 000	80 000	60 000	70	✓

Product name	CRI	UGR	FLICKER VALUE	IK		L x W x H [mm] ∅ x H [mm]
PL INDV 600 ZIGBEE 33W 4000 K	≥ 80	< 16	< 10%	IK08	3 500	595 x 595 x 13
PL INDV 625 ZIGBEE 33W 4000 K	≥ 80	< 16	< 10%	IK08	3 600	620 x 620 x 13

¹ t [h]: L70/B50 @ 25 °C (T_a)/t [h]: L80/B10 @ 25 °C (T_a)

PANEL PERFORMANCE ZIGBEE

Square recessed panel luminaires, tool-free installation and low glare, for ceiling systems with Zigbee 3.0 technology

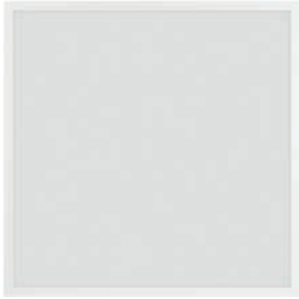

PRODUCT FEATURES

- IoT-ready luminaire with Zigbee 3.0 technology
- Extruded aluminum frame
- Polystyrene diffuser
- 5-pole terminal block, cable cross section up to 5 × 2.5 mm²

PRODUCT BENEFITS

- Suitable luminaire for VIVARES and other Zigbee 3.0 Light Management Systems
- Tool-free electrical connection due to push button connector
- Through-wiring possible with included connector box
- Energy savings thanks to high system efficacy: up to 120 lm/W
- Good glare reduction (UGR < 19)

AREAS OF APPLICATION

- Direct replacement for luminaires with fluorescent lamps
- Offices, conference rooms
- Reception areas, foyers, corridors, elevators

EQUIPMENT/ACCESSORIES

- Accessories for several mounting options available
- Connector box with 5-pole terminal included
- Security rope for luminaire included

FURTHER PRODUCT DETAILS

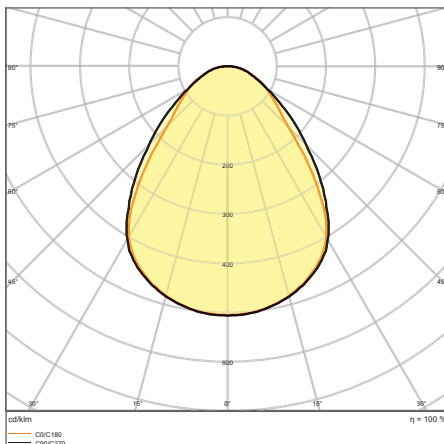

PL PFM 600 36W4000K UGR19 ZBVR

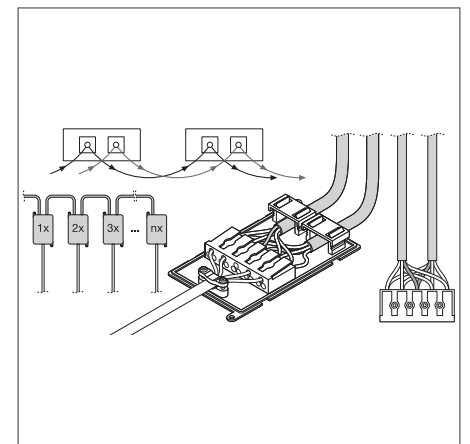
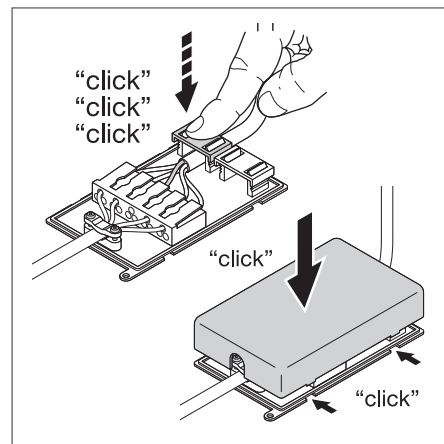

¹ Refer to www.ledvance.com/guarantee for precise conditions

The pictures shown in the catalog are for illustration purposes only. For information on size and color, please refer to the product table.

PANEL PERFORMANCE UGR<19 ZIGBEE

Square recessed panel luminaires, tool-free installation and low glare, for ceiling systems with Zigbee 3.0 technology

Product name	Segmentation	GTIN (EAN)	RE-PLACEMENT FOR	W	lm	lm/W	K	L70 ¹	L80 ¹	°	✓
PL PFM 600 UGR<19 ZIGBEE 36W 4000 K	■	4058075522862	4 x 18W/4 x 14W FL	36	4 320	120	4 000	100000	60 000	90	✓
PL PFM 625 UGR<19 ZIGBEE 36W 4000 K	■	4058075522886	4 x 18W/4 x 14W FL	36	4 320	120	4 000	100000	60 000	90	✓

Product name	CRI	UGR	FLICKER VALUE	IK	IK02	L x W x H [mm] ∅ x H [mm]
PL PFM 600 UGR<19 ZIGBEE 36W 4000 K	>80	<19	<5%	IK02	1 900	595 x 595 x 32
PL PFM 625 UGR<19 ZIGBEE 36W 4000 K	>80	<19	<5%	IK02	2 100	620 x 620 x 32

PANEL PERFORMANCE ZIGBEE

Square recessed panel luminaires, tool-free installation, for ceiling systems with Zigbee 3.0 technology

Product name	Segmentation	GTIN (EAN)	RE-PLACEMENT FOR	W	lm	lm/W	K	L70 ¹	L80 ¹	°	✓
PL PFM 600 ZIGBEE 36W 4000 K	■	4058075522824	4 x 18W/4 x 14W FL	36	4 320	120	4 000	100000	60 000	120	✓
PL PFM 625 ZIGBEE 36W 4000 K	■	4058075522848	4 x 18W/4 x 14W FL	36	4 320	120	4 000	100000	60 000	120	✓

Product name	CRI	UGR	FLICKER VALUE	IK	IK02	L x W x H [mm] ∅ x H [mm]
PL PFM 600 ZIGBEE 36W 4000 K	>80	<22	<5%	IK02	1 650	595 x 595 x 32
PL PFM 625 ZIGBEE 36W 4000 K	>80	<22	<5%	IK02	1 800	620 x 620 x 32

¹ t [h]: L70/B50 @ 25 °C (T_a)/t [h]: L80/B10 @ 25 °C (T_a)

■ SUPERIOR CLASS ■ PERFORMANCE CLASS ■ VALUE CLASS

COMPATIBILITY OF PANEL ACCESSORIES WITH PANEL FAMILIES¹

1. SURFACE MOUNT KIT



- Pre-assembled ready to install
- Simple fixing with magnets
- Cross brace for greater stability
- Material: aluminum

2. SURFACE MOUNT KIT VALUE



- Kit for tool-free mounting with corner clips
- Material: aluminum

3. EMERGENCY CONVERSION BOX



- Conversion of a selection of panels to safety luminaires
- Reduces warehousing complexity
- Plug-and-play system for easy installation

4. SUSPENSION KIT



- Suspension length: 1500 mm
- Material: steel

5. RECESSED MOUNT CLIPS



- Ceiling thickness: 10 to 20 mm
- Material: steel

6. RECESSED MOUNT FRAME



- Pre-assembled ready to install
- Seamless recessed mounting
- Ceiling thickness: 8 to 30 mm
- Material: aluminum

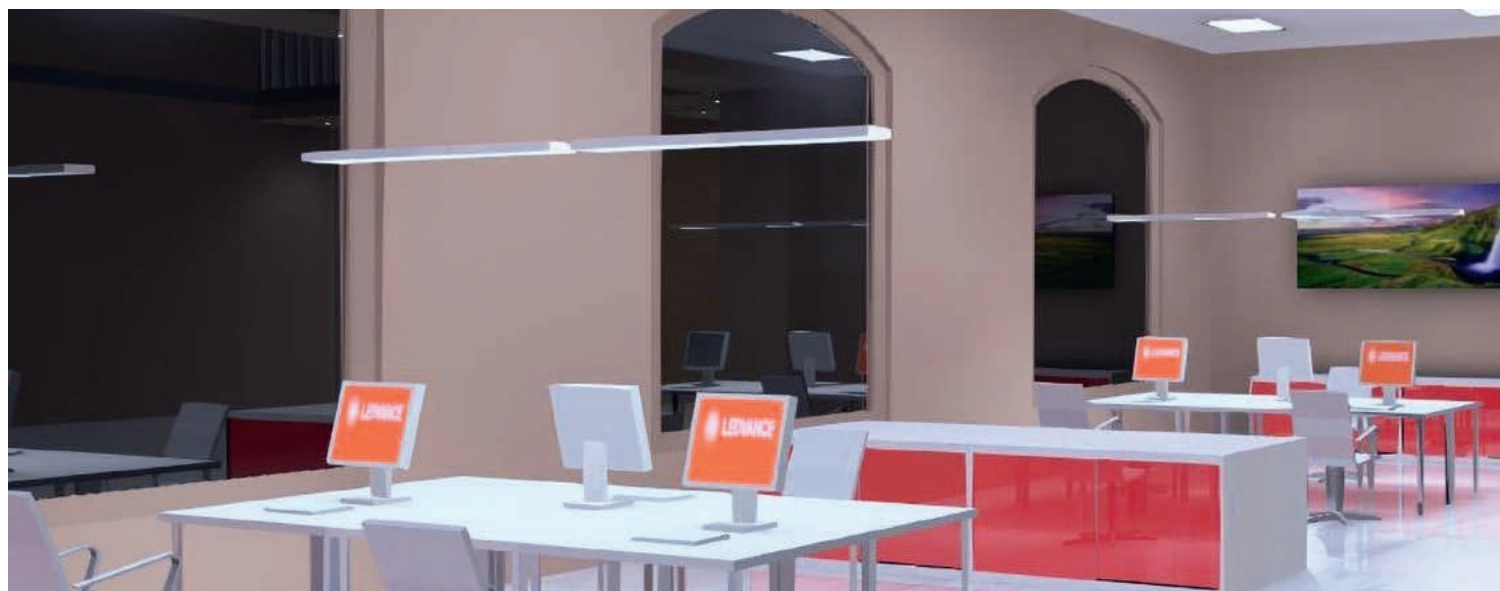

COMPATIBILITIES AT A GLANCE

Accessories	GTIN (EAN)	Panel IndiviLED	Panel Performance
1 Panel 600 Surface Mount Kit H75	4058075472914		✓
	4058075472938		✓
	4058075108820		✓
2 Panel 600 Surface Mount Kit H70 Value	4058075402843		✓
	4058075402867		✓
	4058075472952		✓
3 Emergency Conversion Box AT 3H	4058075237025	✓ ²	✓ ³
4 Panel Suspension Kit	4058075402928	✓ ²	✓
5 Panel Recessed Mount Clips Value 4x	4058075409859	✓	✓
6 Panel 600 Recessed Mount Frame	4058075402881		✓
	4058075402904		✓
	4058075472976		✓

¹ The accessories are compatible with the Panels in the respectively matching size. For details refer to the User Instructions. | ² Not in combination with Panel IndiviLED Emergency

³ Not in combination with Surface Mount Kits, Surface Mount Clips or Suspension Kit

Technical product details
for panel accessories
found on next page



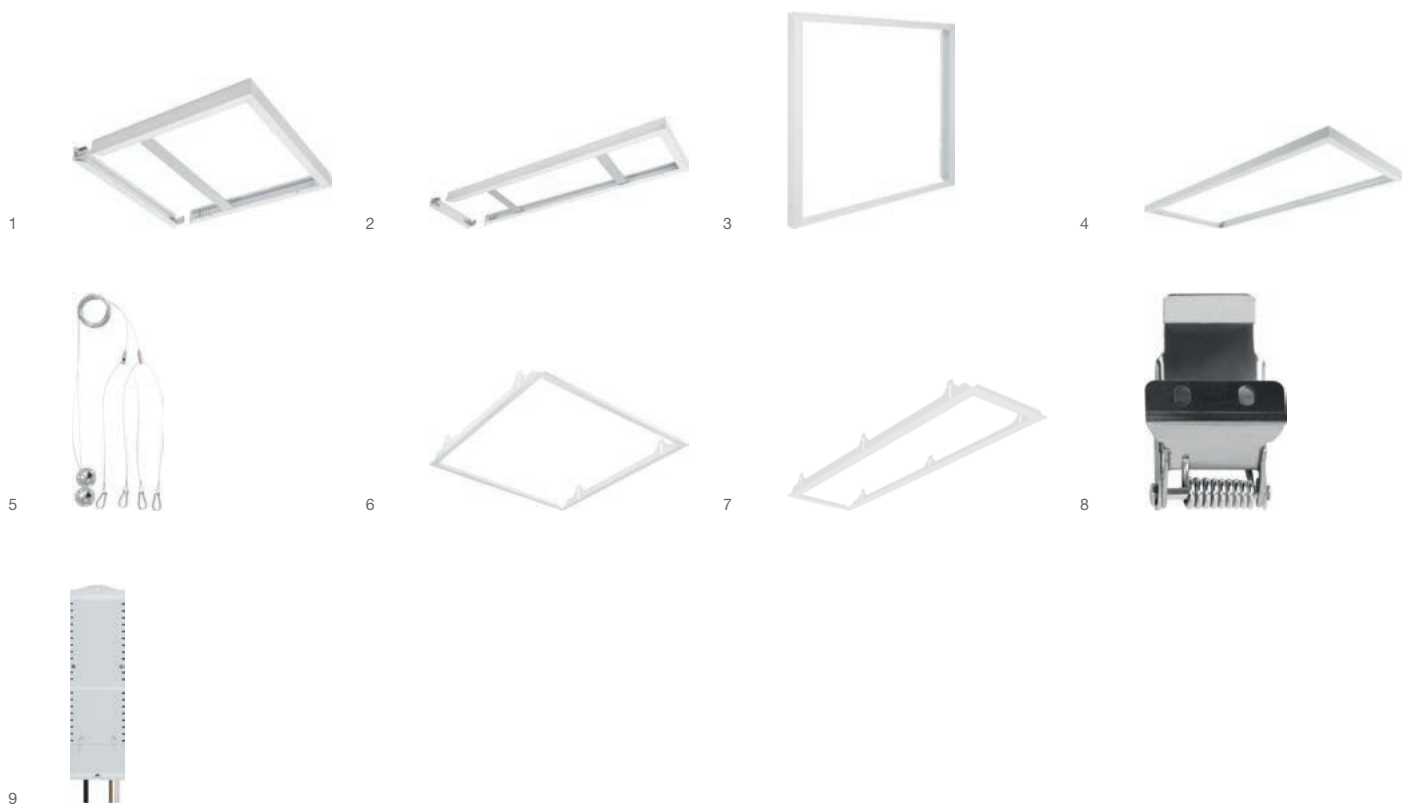

PANEL ACCESSORIES

Mounting accessories for panel luminaires, combination according to the accessories matrix



- Suspension Kit: suspension length 1.5 m adjustable for various applications by screw connection
- Surface Mount Kit: sturdy, cross-stiffened aluminum frame with magnetic corners

- Surface Mount Kit Value: Aluminum frame with polycarbonate strip. With rectangular frame, panel insertion is possible from short or long frame side.
- Recessed Mount Clips Value 1 × 4: ceiling thickness 10–20 mm, plasterboard, wood and metal ceilings

Product name	GTIN (EAN)	L x W x H [mm] Ø x H [mm]	MATERIAL	COLOR	 No.	 No.
PANEL 600 SURFACE MOUNT KIT H75	4058075 472914	601 × 601 × 75	Aluminum	White	1	1
PANEL 625 SURFACE MOUNT KIT H75	4058075 472938	626 × 626 × 75	Aluminum	White	1	1
PANEL 1200 Surface Mount Kit	4058075 108820	1 201 × 301 × 56	Aluminum	White	1	2
PANEL 1200x300 SURFACE MOUNT KIT VAL	4058075 472952	1 212 × 312 × 52	Aluminum	White	1	4
PANEL 600 SURFACE MOUNT KIT H70 VAL	4058075 402843	613 × 613 × 70	Aluminum	White	1	3
PANEL 625 SURFACE MOUNT KIT H70 VAL	4058075 402867	638 × 638 × 70	Aluminum	White	1	3
PANEL Suspension Kit	4058075 402928	30 × –	Steel	Steel	1	5
PANEL 600 RECESSED MOUNT FRAME	4058075 402881	625 × 625 × 76	Aluminum	White	1	6
PANEL 625 RECESSED MOUNT FRAME	4058075 402904	650 × 650 × 76	Aluminum	White	1	6
PANEL 1200x300 RECESSED MOUNT FRAME	4058075 472976	1 224 × 324 × 76	Aluminum	White	1	7
PANEL RECESSED MOUNT CLIPS VAL 4x	4058075 409859	25 × 45 × 33	Steel	Steel	4	8
EM CONVERSION BOX	4058075 237025	292 × 81 × 41	–	–	1	9

PANEL DIRECT/INDIRECT 1 200 UGR<19 ZIGBEE

Suspended edge-lit luminaires for direct and indirect light emission, low glare, 1200 mm with Zigbee 3.0 technology



PRODUCT FEATURES

- IoT-ready luminaire with Zigbee 3.0 technology
- Rectangular (1200 mm x 300 mm) stand-alone luminaires with direct (70 %) and indirect (30 %) light emission
- Driver integrated into the remote driver box
- UGR 19 according to EN12464-1
- High luminous efficacy: up to 110 lm/W

PRODUCT BENEFITS

- Suitable luminaire for VIVARES and other Zigbee 3.0 Light Management Systems
- Suspended edge-lit luminaires for direct light emission (70 %) and indirect light emission (30 %)
- Attractive and functional design for office applications
- Good glare reduction (UGR ≤ 19)
- Very homogenous light

AREAS OF APPLICATION

- Efficient replacement for traditional T8 and T5 luminaires
- Offices
- Meeting rooms
- Conference rooms
- Reception areas and foyers

EQUIPMENT/ACCESSORIES

- Suspension kit included

FURTHER PRODUCT DETAILS

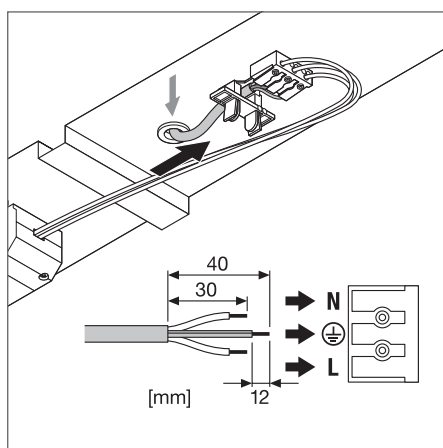
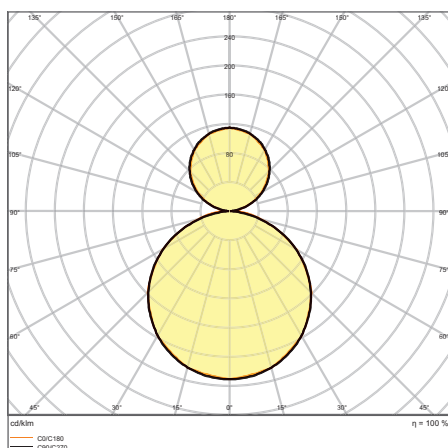

PANEL D I 1200 36W4000K UGR19 ZBVR

¹ Refer to www.ledvance.com/guarantee for precise conditions

The pictures shown in the catalog are for illustration purposes only. For information on size and color, please refer to the product table.

PANEL DIRECT/INDIRECT 1 200 UGR<19 ZIGBEE

Suspended edge-lit luminaires for direct and indirect light emission, low glare, 1200 mm with Zigbee 3.0 technology

Product name	Segmentation	GTIN (EAN)	RE-PLACEMENT FOR	W	lm	lm/W	K	L70 ¹	L80 ¹	△ _a	✓
PANEL D/I 1200 UGR<19 ZIGBEE 36W 4000 K	■	4058075521889	2 x 58W FL	36	4000	110	4000	80000	60000	110	✓

Product name	CRI	UGR	FLICKER VALUE	IK	IP	L x W x H [mm] ∅ x H [mm]
PANEL D/I 1200 UGR<19 ZIGBEE 36W 4000 K	≥ 80	< 19	< 10%	IK03	3500	1200 x 300 x 16

¹ t [h]: L70/B50 @ 25 °C (T_a)/t [h]: L80/B10 @ 25 °C (T_a) ■ SUPERIOR CLASS ■ PERFORMANCE CLASS ■ VALUE CLASS

LINEAR INDIVILED® DIRECT ZIGBEE

Surface mounted luminaire for single luminaire or light line application with Zigbee 3.0 technology



PRODUCT FEATURES

- IoT-ready luminaire with Zigbee 3.0 technology
- Each LED with individual lens and reflector for UGR < 16 and homogenous light distribution
- Pendant mounting with suspension kit
- Linkable to an esthetic seamless light line with line connection adapter (surface or pendant mounting)
- Available with length of 1200 or 1500 mm

PRODUCT BENEFITS

- Suitable luminaire for VIVARES and other Zigbee 3.0 Light Management Systems
- Homogenous light distribution and reduced glare thanks to the IndivILED® optics
- Multiple mounting options
- The product family offers full lighting solution for different applications
- Energy savings of up to 50 % compared to T5 batten luminaires

AREAS OF APPLICATION

- Direct replacement for luminaires with fluorescent lamps
- Offices, schools
- General indoor illumination
- Corridors, entrance areas
- Seamless linear lighting

EQUIPMENT/ACCESSORIES

- Suspension kit available
- Line connection adapter available
- Through-wiring cable kit available

FURTHER PRODUCT DETAILS

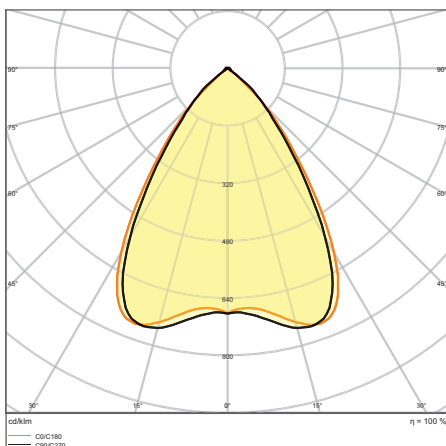

LN INDV D 1500 48W4000K ZBVR

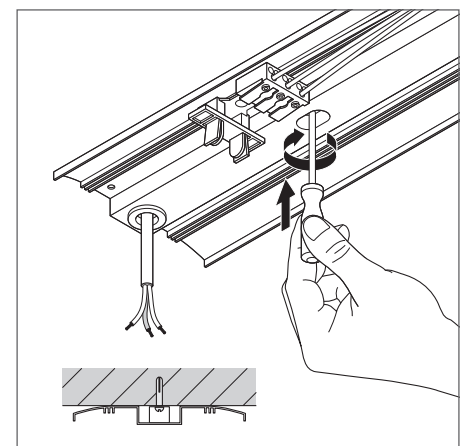
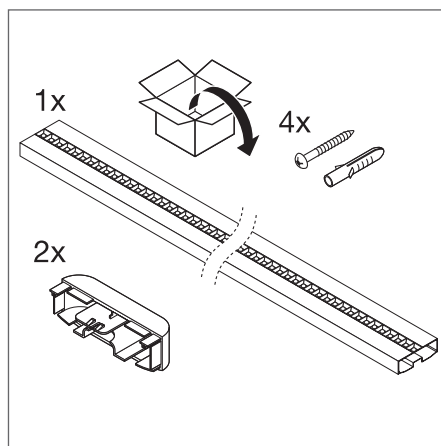

¹ Refer to www.ledvance.com/guarantee for precise conditions

The pictures shown in the catalog are for illustration purposes only. For information on size and color, please refer to the product table.

LINEAR INDIVILED® DIRECT ZIGBEE

Surface mounted luminaire for single luminaire or light line application with Zigbee 3.0 technology

Product name	Segmentation	GTIN (EAN)	RE-PLACEMENT FOR	W	lm	lm/W	K	L70 ¹	L80 ¹		
LN INDV D 1200 ZIGBEE 34W 4000 K	■	4058075 521902	2 × 28W FL	34	4 200	125	4 000	60 000	50 000	70	✓
LN INDV D 1500 ZIGBEE 48W 4000 K	■	4058075 521926	2 × 49W FL	48	5 700	120	4 000	60 000	50 000	70	✓

Product name	CRI	UGR	FLICKER VALUE	IK		L × W × H [mm] ∅ × H [mm]
LN INDV D 1200 ZIGBEE 34W 4000 K	>80	<16	<10%	IK06	2500	1 199 × 120 × 40
LN INDV D 1500 ZIGBEE 48W 4000 K	>80	<16	<10%	IK06	3 200	1 488 × 120 × 40

¹ t [h]: L70/B50 @ 25 °C (T_a)/t [h]: L80/B10 @ 25 °C (T_a) ■ SUPERIOR CLASS ■ PERFORMANCE CLASS ■ VALUE CLASS

LINEAR INDIVILED® DIRECT ACCESSORIES

Mounting accessories for LINEAR INDIVILED® luminaires



- Suspension Kit:
 - 1 × transparent 1.5 m cable 3 × 0.75 mm +
 - 2 × Y wire suspension 1.5 m
- Suspension Wire:
 - 1 × Y wire suspension 1.5 m
- Through Wiring Kit:
 - 3 × 1.5 mm with fast connector

Product name	GTIN (EAN)	L × W × H [mm] ∅ × H [mm]	MATERIAL	COLOR		
LN INDV Suspension Kit	4058075133280	100 × 25	Steel	White	1	1
LN INDV Suspension Wire	4058075133327	1560 × 1 × 1	Steel	Steel	1	2
LN INDV Lightline Connector	4058075133341	82 × 40 × 12	Steel	Steel	1	3
LN INDV 1200 Through Wiring Kit	4058075158030	1250 × 20 × 7	Polycarbonate (PC)	Yellow	1	4
LN INDV 1500 Through Wiring Kit	4058075133365	1560 × 20 × 7	Polycarbonate (PC)	Yellow	1	4

¹ Refer to www.ledvance.com/guarantee for precise conditions

OUR CHECKLIST FOR YOUR LINEAR INDIVILED DIRECT ZIGBEE SYSTEM

Typical installation: We have put together for you all the necessary components for suspended installation of three luminaires as strip lighting. For more information see the operating instructions for Linear IndiviLED.

UP TO 20 LUMINAIRES!

INSTALLATION OF 3 × LINEAR INDIVILED DIRECT ZIGBEE

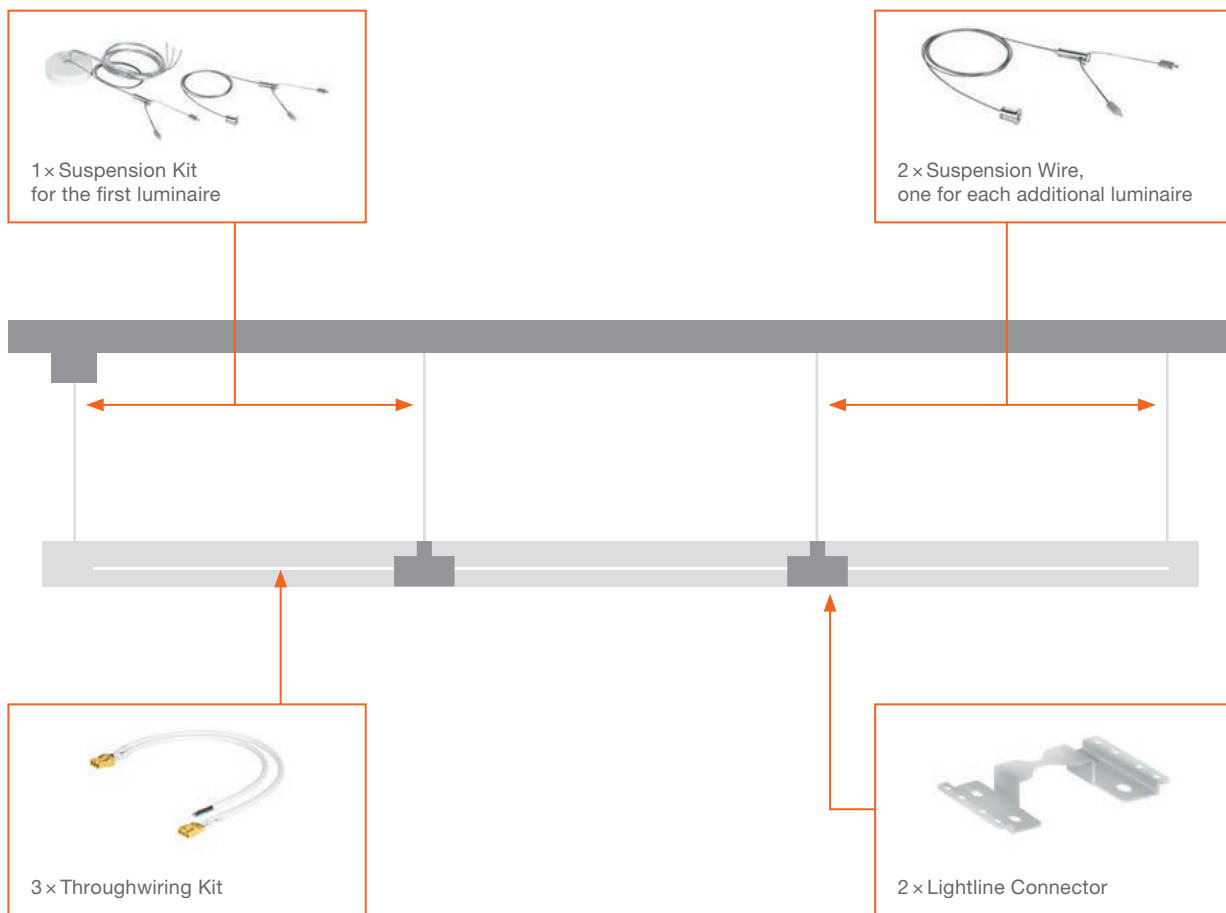

The through-wiring must be fitted by an installer.

ORDER LIST

- 3 × Linear IndiviLED Direct Zigbee
- 3 × Throughwiring Kit
- 2 × Lightline Connector
- 1 × Suspension Kit
- 2 × Suspension Wire



DOWNLIGHT UGR19 ZIGBEE

Low-glare downlights, suitable for computer screen workplaces with Zigbee 3.0 technology



PRODUCT FEATURES

- IoT-ready luminaire with Zigbee 3.0 technology
- Housing material: Aluminum mirror-finished reflector
- Type of protection: IP54 (room side)/ IP20 (back side)
- Connector box with push wire terminal for tool-free connection
- Through-wiring possible

PRODUCT BENEFITS

- Suitable luminaire for VIVARES and other Zigbee 3.0 Light Management Systems
- Good glare reduction (UGR < 19) and cut off angle up to 30° for comfortable indoor lighting
- Easy and quick installation thanks to connector box with 5-pole toolless terminal
- Low-flicker light
- Suitable for use in dusty and damp locations thanks to high IP rating

AREAS OF APPLICATION

- Suitable for office applications, especially for computer screen workplaces
- Direct replacement for luminaires with compact fluorescent lamps
- Entrances/Hallways
- Bathrooms, kitchens and sheltered outdoor areas
- General illumination

EQUIPMENT/ACCESSORIES

- External control gear included

FURTHER PRODUCT DETAILS

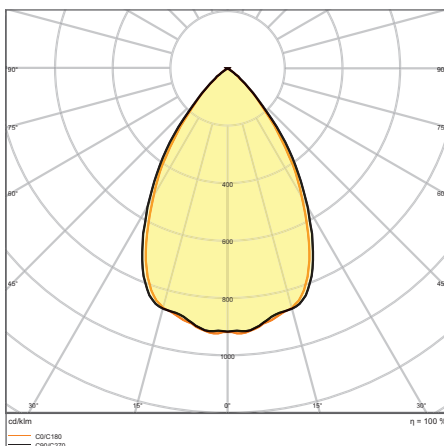

DL UGR19 DN195 PFM 21W840 ZBVR WT

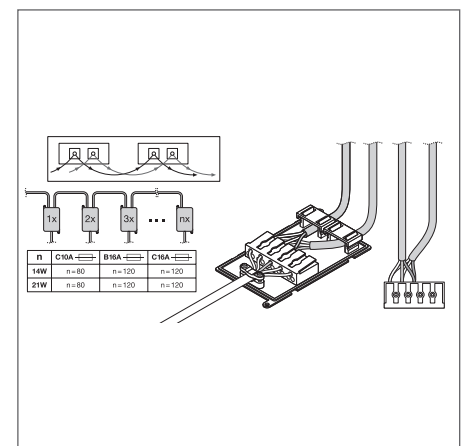
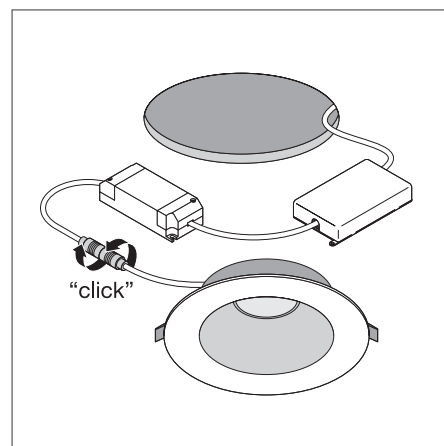

¹ Refer to www.ledvance.com/guarantee for precise conditions

The pictures shown in the catalog are for illustration purposes only. For information on size and color, please refer to the product table.

DOWNLIGHT UGR19 ZIGBEE

Low-glare downlights, suitable for computer screen workstations with Zigbee 3.0 technology

Product name	Segmentation	GTIN (EAN)	RE-PLACEMENT FOR	W	lm	lm/W	K	L70 ¹	L80 ¹		
DL UGR19 PFM DN155 14W 840 ZBVR WT	■	4058075459892	1 × 26W CFLi	14	1600	115	4000	70 000	60 000	65	✓
DL UGR19 PFM DN155 21W 840 ZBVR WT	■	4058075459397	2 × 26W CFLi	21	2520	120	4000	70 000	60 000	65	✓

Product name	CRI	UGR	FLICKER VALUE	IK			L × W × H [mm] ∅ × H [mm]
DL UGR19 PFM DN155 14W 840 ZBVR WT	≥ 80	< 19	< 10%	IK03	155	650	180 × 65
DL UGR19 PFM DN155 21W 840 ZBVR WT	≥ 80	< 19	< 10%	IK03	195	900	220 × 82

¹ t [h]: L70/B50 @ 25 °C (T_a)/t [h]: L80/B10 @ 25 °C (T_a)

■ SUPERIOR CLASS

■ PERFORMANCE CLASS

■ VALUE CLASS

LEDVANCE HUMAN CENTRIC LIGHTING FOCUSING ON PEOPLE IN LIGHTING DESIGN

LIGHT IS ONE OF THE MOST IMPORTANT SOURCES FOR OUR HEALTH, PERFORMANCE AND SATISFACTION.

Offices with little natural light, dark meeting rooms and artificial light until late into the night – these are typical modern working conditions. But as one of the most important sources for our well-being, performance and satisfaction, light is essential.

A lack of daylight can cause serious disruption to our day/night rhythm (our “inner clock”), and massive degradation in our performance and overall well-being. Human centric lighting (HCL) is closely linked to this biological effect of light. Lighting solutions for modern working environments must be designed to promote creative thinking and high levels of concentration at desks, in service sectors and in factories.

Human centric lighting focuses on people and their need for natural light. Flexible, stimulating and effective. It creates a working environment that simulates the changes in natural daylight with its visual, biological and emotional effects. And it can positively support the circadian rhythm of people through changing color temperatures and illuminance levels.



THE LEDVANCE BIOLUX HCL SYSTEM

The system consists of two components: the BIOLUX HCL control unit and the luminaires – BIOLUX HCL Downlight and BIOLUX HCL Panel. It always provides the right light at the right time of day. To adapt the system even more to individual needs, there is also a choice of different lighting mood profiles.



GERMAN INNOVATION AWARD '20 WINNER



VDE Human Centric Lighting ID: 40051808



reddot winner 2020

The BIOLUX HCL system is also a winner of design, function and innovation awards.

CIRCADIAN RHYTHM – THE BODY’S 24-HOUR CYCLE

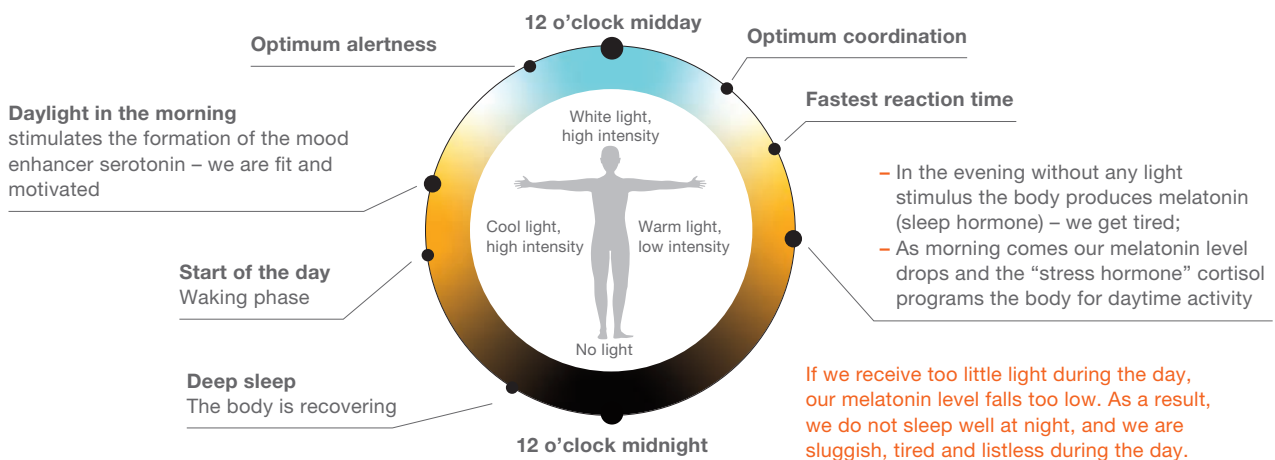

A PERFECT COMBINATION: LEDVANCE BIOLUX HCL AND VIVARES ZIGBEE

The HCL light curve of the LEDVANCE BIOLUX HCL system can be easily combined with VIVARES Zigbee. Find out more on the following pages.

A BENEFICIAL CONNECTION: VIVARES ZIGBEE AND LEDVANCE BIOLUX HCL

WITH THE COMBINATION OF VIVARES ZIGBEE AND BIOLUX HCL, YOU CAN OFFER YOUR CUSTOMERS TWICE THE ADDED VALUE.

VIVARES Zigbee and BIOLUX HCL combine the benefits of a wireless light management system with the health- and performance-enhancing effects of human centric lighting. This combination is also very easy to install and commission.

SINGLE OFFICES AND CONFERENCE ROOMS: BIOLUX HCL

The use of BIOLUX HCL luminaires together with BIOLUX HCL control is ideal for single offices and conference rooms with up to 40 lighting components. In addition to the light curve, which automatically simulates the changes in natural daylight, five preprogrammed light profiles can be selected using the BIOLUX HCL control unit.

OPEN-PLAN OFFICES: VIVARES ZIGBEE HCL

VIVARES Zigbee HCL is the perfect solution for open-plan offices with up to 200 lighting components. In this case, the VIVARES Zigbee control transmits the identical natural light curve to the BIOLUX HCL luminaires. For you and your customers this is a very simple way to share the positive effects of HCL with a large number of people.

HCL HAS A POSITIVE EFFECT – ALSO IN TERMS OF ECONOMY

HCL promotes and supports a company's most valuable resource: its employees. That is reflected not least in productivity rates.



+ 2 HOURS

Time effectively
gained per month



+ 1 YEAR

Employee loyalty



- 1 PERCENT

Absence/illness

ALL FROM A SINGLE SOURCE

LEDVANCE offers you all the products you need for a combined VIVARES Zigbee and BIOLUX HCL system from a single source. This means that all the components are perfectly matched to each other and meet the same high quality standards.



Do you need information on our products? Our experts are happy to advise you. Get in touch with us: kundenservice@ledvance.com

CERTIFIED DAYLIGHT CURVE

The independent VDE testing and certification institute certified LEDVANCE BIOLUX HCL with meeting all the requirements of an HCL system.

BIOLUX HCL received top marks (3 out of 3 stars). Among the certified standards is the curve, which simulates the changes in natural daylight in terms of light intensity and color temperature.

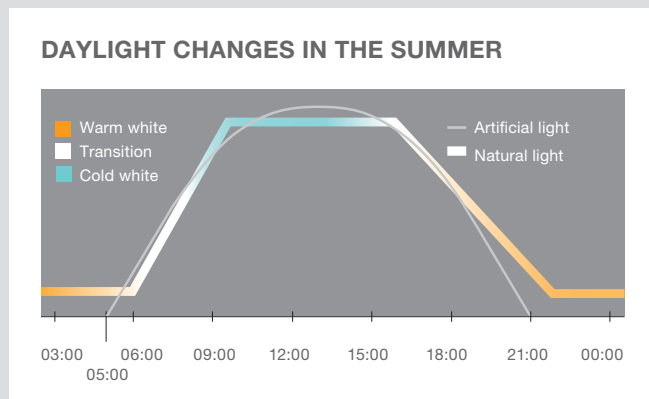
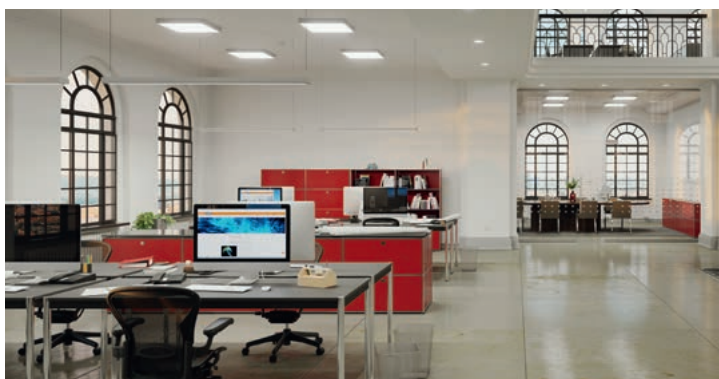

Illustration of a daylight curve: HCL follows the natural changes in daylight. This has a positive effect.

This light curve is used in all rooms which means that there are the same lighting conditions everywhere.

Source: <http://en.licht.de/>

COMPARISON: BIOLUX HCL AND VIVARES ZIGBEE HCL IN SINGLE AND OPEN-PLAN OFFICES



	BIOLUX HCL (Single offices/conference rooms)	VIVARES ZIGBEE HCL (Open-plan offices)
Number of devices	Up to 40	Up to 200
Mode	5 light profiles	1 light profile (NATURAL)
Adjustment with the BIOLUX HCL control unit	Yes	No
Commissioning	BIOLUX HCL app	VIVARES Portal
Cloud services	No	Yes (available from Q1 2022)
Motion detection	Yes*	Yes

* Sensor is wired to luminaire group (Zigbee sensor planned for end of 2021)

BIOLUX HCL LUMINAIRES

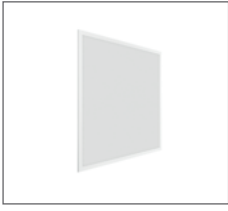

BIOLUX HCL PANEL

- Enables individual HCL lighting solutions in conjunction with the appropriate HCL control
- Biologically optimized lighting by adapting the artificial light to the changes in natural daylight
- Can support concentrated work
- Very good anti-glare properties (UGR < 19)
- Very high color rendering index (R_a > 90)
- Wireless communication between the control unit and luminaires via Zigbee protocol



Product name	GTIN (EAN)	W	lm	lm/w	°	K	L x W x H [mm] Ø x H [mm]
BIOLUX HCL PL 625 ZB 43W	4058075 364561	43	4000	95	80	2700 – 6500	620 x 620 x 11
BIOLUX HCL PL 600 ZB 43W	4058075 364547	43	4000	95	80	2700 – 6500	595 x 595 x 11



BIOLUX HCL DOWNLIGHT

- Enables individual HCL lighting solutions in conjunction with the appropriate HCL control
- Biologically optimized lighting by adapting the artificial light to the changes in natural daylight
- Can support concentrated work
- Very good anti-glare properties (UGR < 19)
- Very high color rendering index (R_a > 90)
- Wireless communication between the control unit and luminaires via Zigbee protocol



Product name	GTIN (EAN)	W	lm	lm/w	°	K	L x W x H [mm] Ø x H [mm]
BIOLUX HCL DL DN150 ZB 20W TW	4058075 400733	20	1800	90	60	2700 – 6500	175.4 x 98.9

¹ For precise terms and conditions go to www.ledvance.com/guarantee

VIVARES DALI: FUNCTIONALITY, INSTALLATION

VIVARES DALI IS DALI-2-CERTIFIED AND MEETS ALL THE REQUIREMENTS OF THE LATEST INDUSTRY STANDARD.

At the heart of LEDVANCE VIVARES DALI is the OSRAM DALI PRO 2 IoT control unit. The system connects DALI-2 components – for example sensors, pushbutton couplers and the LEDVANCE VIVARES DALI-2 luminaires. As an open standard, the system is compatible with a wide range of DALI-2-ready luminaires and components. A total of up to 128 luminaires and 126 input devices can be individually addressed via two channels. Installation, configuration and commissioning are particularly simple and user-friendly thanks to the browser-based graphical user interface.

Predefined templates and drag & drop enable time-saving and intuitive commissioning. The DALI PRO 2 IoT control unit is equipped with an integrated gateway and provides optional access to the LEDVANCE Cloud services. The VIVARES DALI system can also be integrated into a higher-ranking KNX system for building control. And it comes with state-of-the-art security features.



Products of OSRAM GmbH, distributed by LEDVANCE



VIVARES DALI IN USE

Application profiles	LS/PD sensor ¹	P sensor ²	Function	Setting	Pushbutton coupler	Function	Arrangement
Open-plan offices	✓	✓	Daylight control and presence detection or motion and presence detection	Adjustable sensor delay and dimming speed, automatic calibration to adapt to the place of installation	✓	ON/OFF/ DIM scenes	For each luminaire group with, for example, four desks one sensor is used to control this area.
Multi-person offices	✓	✓	Daylight control and presence detection or motion and presence detection	Adjustable sensor delay and dimming speed, automatic calibration to adapt to the place of installation	✓	ON/OFF/ DIM scenes	For each luminaire group with, for example, four desks one sensor is used to control this area.
Standard rooms	–	✓	Motion and presence detection	Adjustable sensor delay and dimming speed	✓	ON/OFF/ DIM	For each luminaire group with, for example, four desks one sensor is used to control this area.
Conference rooms	–	✓	Motion and presence detection	Adjustable sensor delay and dimming speed	✓	ON/OFF/ DIM scenes	Depending on the detection range of the sensor. The sensor is usually positioned in such a way that the entrance area and the conference table are detected at the same time. If both are not detected at the same time, install a second sensor.
Restrooms	–	✓	Motion and presence detection	Adjustable sensor delay and dimming speed	✓	ON/OFF	A separate sensor is fitted for each toilet cubicle. Other than that, cover the entrance areas and common areas (sinks, urinals, etc.).
Corridors & stairs	–	✓	Motion and presence detection	Adjustable sensor delay and dimming speed	✓	ON/OFF/ 2step DIM	Long corridors or stairwells
Reception	–	✓	Motion and presence detection	Adjustable sensor delay and dimming speed	✓	ON/OFF/ 2step DIM	Reception desk with waiting area

Project size	2 DALI channels for up to 128 DALI luminaires and components (sensors, couplers)
Installation tools	mobile device (smartphone, notebook or tablet)
WebGui software	The software contains templates for the above-mentioned application profiles. The profiles can be selected here as required. The products are added by drag & drop.

¹ LS/PD = light and presence | ² P = presence



N AND OPERATION

Good reasons for choosing VIVARES DALI:

- Tailor-made for new buildings and renovations with the option of additional control lines
- Products certified according to DALI-2 standard
- Extensive product portfolio for office applications
- Project creation and commissioning with self-explanatory software
- Integrated IoT gateway for maintenance and energy consumption reports

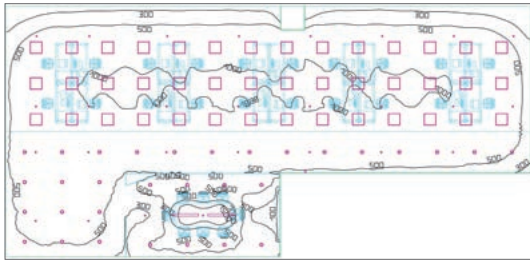

In LEDVANCE lighting calculation suitable LMS components – such as sensors – and luminaires are combined for optimal lighting. In addition to 3D views, illustrations with isolines or lux values are provided.

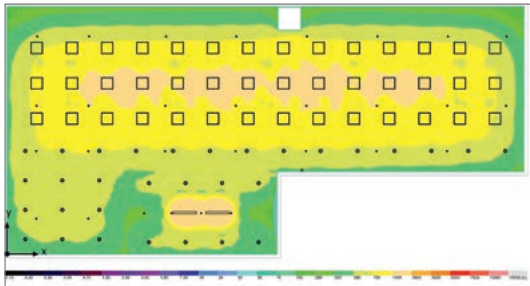

Here is an example of balanced positioning of sensors and light sources to achieve the desired light distribution, shown in color as lux values.

Our experts are happy to support you in planning your DALI PRO 2 IoT system. Just get in touch at: kundenservice@ledvance.com

TRAIN HARD, REAP THE REWARD: LEDVANCE TRAINING FOR PROFESSIONALS

LEDVANCE gives you the option of deepening your expertise in light management. You can choose from different courses:

1. Our online training center includes training modules where you can learn all about DALI technology and individual light management components. Visit training.ledvance.com for our online training courses.
2. Our YouTube channel is packed with product training videos, commissioning instructions and more. Check them out at: ledvance.com/dalivideos



Take advantage of this opportunity and gain valuable knowledge that keeps you ahead of the competition.

VIVARES DALI: IOT-READY AND COMPATIBLE WITH MANY DALI-2 PRODUCTS

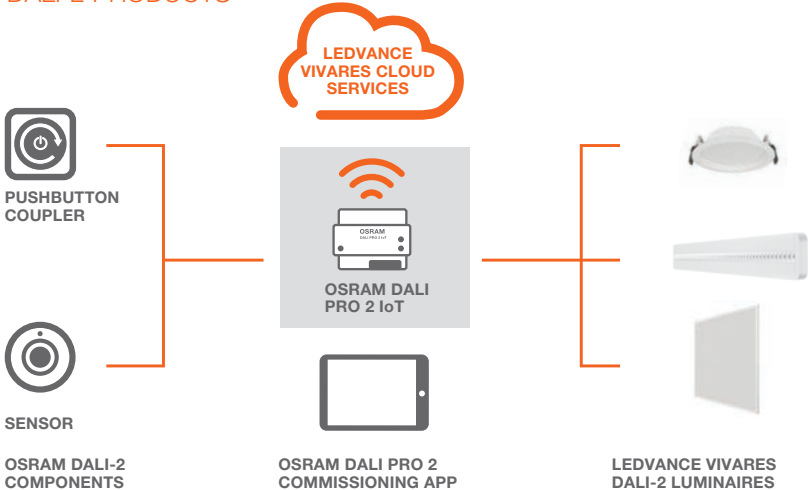

SIMPLY BETTER LIGHT IN THE OFFICE: CONFIGURE AND COMMISSION VIVARES DALI

Your VIVARES DALI system is configured and commissioned on site after installation of the VIVARES DALI components. You can use the VIVARES DALI commissioning app for this. The free tool is browser-based, so it doesn't have to be downloaded, and is available for smartphones, tablets (iOS and Android) and PCs. The self-explanatory user guide makes commissioning extremely quick and easy – thanks to predefined rooms and situations via drag & drop. Alternatively, you can use the well-known DALI Professional PC tool.

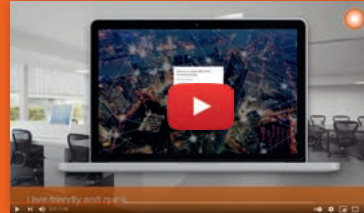

Our YouTube installation video (ledvance.com/dalivideos) shows you how easy and intuitive it is to set up your VIVARES DALI system using the commissioning tool. Discover the possibilities!

FROM PROJECT PLANNING TO OPERATION IN 5 STEPS



1. PLAN LIGHTING SYSTEM AND ORDER PRODUCTS

Find out more about planning VIVARES DALI from page 40.



2. INSTALL

Install all luminaires, sensors and other components (e.g. pushbutton couplers).



3. CREATE AN ACCOUNT

- Connect to the WiFi of the DALI controller and open the web-based commissioning app in the browser
- Create an account, register and log in



4. CONFIGURE AND COMMISSION ON SITE

- Create a project in the commissioning app
- Drag & drop predefined templates into the project
- Automatically find installed luminaires and components through the search function
- Assign luminaires and components to the respective templates (drag & drop)
- Synchronize and save to DALI PRO



5. FINALIZE AND OPERATE

- Test the lighting system
- Get customer acceptance
- Optional VIVARES Cloud services: create maintenance and energy consumption reports (find out more from page 6)

QUICK AND COMFORTABLE: THE COMMISSIONING TOOL

1

Welcome to OSRAM DALI PRO 2 IoT Commissioning App

Set up the new device

1. Administrator 2. Mobile App User 3. System Setup

Controller Name

Controller Name:

Language: English

Location (optional)

Select:

Date & Time: 30 Mar 2021, 4:13 PM

I accept and agree to Terms of Use, OSRAM Privacy Policy

Back Create

Create an account, register and log in

2

Create a New Project

Project Name*

Project Name (Required)

Additional Information

Address, contact info, etc. (Optional)

Start DALI device search after creating the project

Cancel Create

Create new project

3

Manager Area

Profiles

STANDARD (15)

- General Room
- Meeting Room
- Conference Room
- Class Room

Ground floor > Manager Area > General Room

Room 1

4	1
	1
	1

Drag & drop predefined templates (rooms, situations) into the project

4

Searching Completed

Total found 10 devices

4 1 4 1

Luminaire A06	A 6
Luminaire A04	A 4
Luminaire A03	A 3
Luminaire A01	A 1

Start Searching

Automatically assign installed luminaires and components to the relevant templates via drag & drop

5

General Room

Ground floor - Room1

Devices Properties

MAPPED DEVICES (6)

Room 1_3	A 3
Room 1_2	A 4

Reverse Mode

Press the sync button, save in DALI PRO – and that's it!

REFERENCE PROJECT

PROJECT: SHOW:LAB at LEDVANCE headquarters, Munich/Garching

TASK: Replacement of conventional T8 fluorescent tubes and installation of a VIVARES DALI light management system including presence detection and cloud connection

PRODUCTS: 3 OSRAM DALI sensors DALI/ LS/ PDCI, 21 LEDVANCE PANELS 625, 21 OSRAM OTI DALI ECGs, one OSRAM DALI PROF PB coupler, one OSRAM DALI PRO2 IoT controller

The LEDVANCE SHOW:LAB is now illuminated by a future-proof DALI-2 light management system with cloud connection. Configuration and commissioning were very quick thanks to the LEDVANCE commissioning tool. The new lighting system offers significant energy savings, lower CO₂ emissions and a longer lifetime for the luminaires. The cloud services enable convenient, location-independent energy monitoring and predictive diagnosis of the system.



DALI PRO 2 IOT

DALI-2 controller with integrated gateway for small size light management systems up to 128 light points

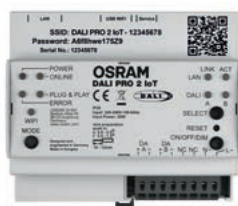

PRODUCT FEATURES

- DALI-2 certified
- Feature-rich local LMS based on DALI Professional
- IoT ready with built-in gateway for remote data access
- Existing DALI Pro PC Software compatible
- Easy browser-based commissioning UI and Professional Software available

PRODUCT BENEFITS

- DALI-2 standard meets many tender requirements
- Profile based commissioning on jobsite
- Building Management Systems integration possible (e.g. KNX interface)
- Central control functions & individual light control via KNX possible

AREAS OF APPLICATION

- Room control, floor control, daylight-dependent control
- Connection of light and presence sensors in DALI systems
- Offices: Individual and group workplaces
- Production and assembly facilities

EQUIPMENT / ACCESSORIES

- Easy browser-based commissioning UI (for smart devices)

TECHNICAL DATA

Product name	GTIN (EAN)	V _{in}	Hz	T _a	Color	L x W x H [mm] Ø x H [mm]
DALI PRO 2 IOT	4062172114189 ²	220...240	50/60	0...+40 °C	Din Rail Light grey	91 x 106 x 62

¹ Refer to www.ledvance.com/guarantee for precise conditions

² New EAN 4052899627079 from October 2021 with additional LEDVANCE specific features

DALI SENSOR LS/PD CI G2

DALI-2 light and presence sensor, ceiling integration



PRODUCT FEATURES

- Light and presence sensor for ceiling integration
- Presence detection via passive IR element
- Light sensor operating range: 20...800 lx (measured at sensor)
- Mounting height: 2...5 m
- Function indicator with two-color LED

PRODUCT BENEFITS

- Flat design, very small structural height
- Simple and fast installation via wire springs
- DALI-2 certified
- DALI Bus powered (No mains connection necessary)
- Multiple sensors connectable to the same DALI line

AREAS OF APPLICATION

- Suitable for indoor applications
- Individual offices
- Open-plan offices
- Classrooms
- Conference rooms

EQUIPMENT / ACCESSORIES

- Suitable for many OSRAM DALI control systems

FURTHER PRODUCT DETAILS

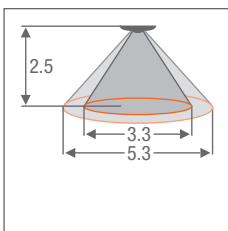

Detection area of the sensor in meter

Mounting height	2.0	2.5	3.0	4.0	5.0
Presence	2.5	3.3	4.0	5.0	–
Motion	4.5	5.3	6.0	7.0	7.0

TECHNICAL DATA

Product name	GTIN (EAN)	V _N	Hz	Beam angle	Height	Lx	Im	Ta	Mounting	COLOR	L x W x H [mm] Ø x H [mm]
DALI SENSOR LS/PD CI G2	4062172072083	16	0	40...90°	6 m	20...800	5	-20...+50 °C	Ceiling integration	White	80 x 55

¹ Refer to www.ledvance.com/guarantee for precise conditions

The pictures shown in the catalog are for illustration purposes only. For information on size and color, please refer to the product table.

DALI SENSOR LS/PD LI UF G2

Ultraflat DALI-2 light and presence sensor, luminaire installation



PRODUCT FEATURES

- Light and presence sensor for luminaire installation
- Presence detection via passive IR element
- Light sensor working range: 10...1000 lx (measured at sensor)
- Mounting height: 2...4 m
- Function indication via integrated LED

PRODUCT BENEFITS

- Extremely low profile
- Presence detection range can be restricted by snap on shutters
- DALI-2 certified
- DALI Bus powered (No mains connection necessary)
- Multiple sensors connectable to the same DALI line

AREAS OF APPLICATION

- Suitable for indoor applications
- Installation in office luminaires
- Suitable for floor standing luminaires in combination with an application controller

FURTHER PRODUCT DETAILS

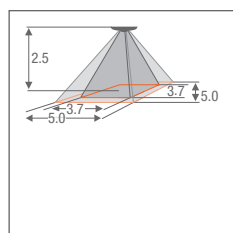

Detection area of the sensor in meter

Mounting height	2.0	2.5	3.0	4.0
Presence	3.0	3.7	4.4	-
Motion	4.0	5.0	6.0	6.5

TECHNICAL DATA

Product name	GTIN (EAN)	V _{IN}	Hz	°	Beam angle	Lx	h [m]	Ta	Integration	COLOR	L x W x H [mm] Ø x H [mm]
DALI SENSOR LS/PD LI UF G2	4062172072045	16	0	90°	6 m	0...1000	4	-20...+50 °C	Luminaire integration	White	50 x 21 x 16

¹ Refer to www.ledvance.com/guarantee for precise conditions

The pictures shown in the catalog are for illustration purposes only. For information on size and color, please refer to the product table.

Products of OSRAM GmbH, distributed by LEDVANCE.



DALI SENSOR LS/PD LI G2

DALI-2 light and presence sensor, luminaire installation



PRODUCT FEATURES

- Light and presence sensor for luminaire installation
- Presence detection via passive IR element
- Light sensor operating range: 20...800 lx (measured at sensor)
- Mounting height: 2...5 m
- Function indicator with two-color LED

PRODUCT BENEFITS

- Small housing design
- Frames for different mounting types for luminaires
- DALI-2 certified
- DALI Bus powered (No mains connection necessary)
- Multiple sensors connectable to the same DALI line

AREAS OF APPLICATION

- Suitable for indoor applications
- Installation in office luminaires
- Suitable for floor standing luminaires in combination with an application controller
- Ceiling installation via LS/PD CI KIT or LS/PD AP KIT possible

EQUIPMENT / ACCESSORIES

- Attachable mounting frame for luminaire mounting from inside and outside

FURTHER PRODUCT DETAILS

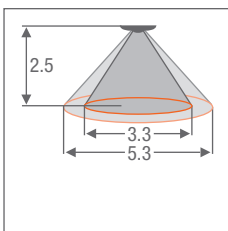

Detection area of the sensor in meter

Mounting height	2.0	2.5	3.0	4.0	5.0
Presence	2.5	3.3	4.0	5.0	–
Motion	4.5	5.3	6.0	7.0	7.0

TECHNICAL DATA

Product name	GTIN (EAN)	V _{IN}	Hz	Beam angle	Beam diameter	Lx	Beam diameter	Ta	Integration	COLOR	L x W x H [mm]
DALI SENSOR LS/PD LI G2	4062172072069	16	0	80°	6m	20...800	5	–20...+50 °C	Ceiling integration/ Luminaire integration	Light grey	48 x 15 x 17

¹ Refer to www.ledvance.com/guarantee for precise conditions

The pictures shown in the catalog are for illustration purposes only. For information on size and color, please refer to the product table.

HF LS LI

Light and presence sensor, radar, luminaire installation, up to 13 m height



IP 20

LEDVANCE
5 year
guarantee

PRODUCT FEATURES

- Light and presence sensor for luminaire installation or attachment
- Presence detection via active radar sensor element
- Function indicator with two-color LED
- Motion detection range adjustable
- Mounting height: 2...13 m

PRODUCT BENEFITS

- Individual activation/deactivation of light and presence sensor via remote control
- V(λ) corrected light sensor element

AREAS OF APPLICATION

- Installation in IP protected luminaires possible
- Corridor lighting control in logistic centers and factory halls
- Areas with high ceilings

EQUIPMENT / ACCESSORIES

- Suitable for DALIeco Control unit
- Suitable for DALI Sensor Coupler HF LS LI

FURTHER PRODUCT DETAILS

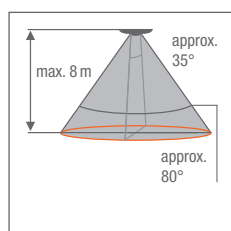

Detection area of the sensor in meter

Mounting height	4.0	6.0	8.0	10.0
Presence	–	–	–	–
Motion	6.7	10.0	13.4	–
Vehicles	6.7	10.0	13.4	16.0

FITTING COMPONENTS



**DALI COUPLER
HF G2**
4062172072199

DALI-2 sensor coupler for integration of HF (radar) light and presence sensor in DALI installations

TECHNICAL DATA

Product name	GTIN (EAN)	V _{IN}	Hz	Beam angle	Lx	h in m	T _a	Mounting	COLOR	L x W x H [mm] Ø x H [mm]
HF LS LI	4052899921481	6	0	35...80°	20...800	8	-20...+50 °C	Luminaire attachment/ Luminaire integration	White	56 x 28 x 21

¹ Refer to www.ledvance.com/guarantee for precise conditions

The pictures shown in the catalog are for illustration purposes only. For information on size and color, please refer to the product table.

Products of OSRAM GmbH,
distributed by LEDVANCE.

OSRAM

DALI COUPLER HF G2

DALI-2 sensor coupler for integration of HF (radar) light and presence sensor in DALI installations



PRODUCT FEATURES

- Coupler for integration of light and presence information in DALI installations
- 4p4c-connector for HF LS LI Sensor (Light- and motion detection via radar)
- Very low DALI Power consumption
- For sensor features see HF LS LI sensor

PRODUCT BENEFITS

- DALI-2 certified
- Multiple couplers connectable to the same DALI line
- Integreatable in light- and building management systems supporting DALI-2 sensors

AREAS OF APPLICATION

- Connection of light and presence sensors in DALI systems
- Ceiling or independent installation via ECO CI KIT possible

EQUIPMENT / ACCESSORIES

- HF LS LI – Light and presence Sensor head with HF technology (radar)
- Separate installation possible with ECO CI KIT

FITTING COMPONENTS



HF LS LI
4052899921481

Light and presence sensor

TECHNICAL DATA

Product name	GTIN (EAN)	V _N	Hz	T _a	Icon	COLOR	L × W × H [mm] Ø × H [mm]
DALI COUPLER HF G2	4062172072199	220...240	50/60	-20...+50 °C	Ceiling integration/ Luminaire integration	Light grey	118 × 30 × 21

¹ Refer to www.ledvance.com/guarantee for precise conditions

LS/PD MULTI 3 CI

Light and presence sensor, recessed ceiling, moveable

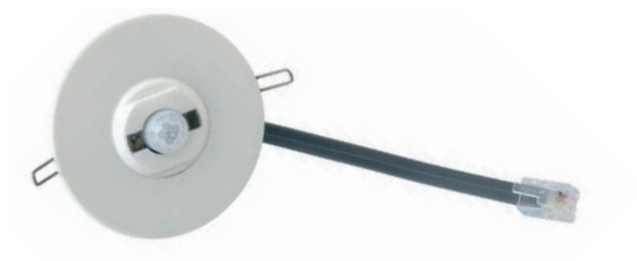

IP20

LEDVANCE
5 year
guarantee

PRODUCT FEATURES

- Ceiling installation sensor with moveable sensor head
- Connection via four-pole screw terminal or modular 4c4p-connector

PRODUCT BENEFITS

- Particularly small construction

AREAS OF APPLICATION

- Offices
- Corridors
- Classrooms
- Training rooms
- Stairways

EQUIPMENT/ACCESSORIES

- Surface mounting in connection with SENSOR KIT
- Suitable for MULTILECO, DIM MULTILECO, DALI MULTILECO control unit
- Suitable for DALI Professional Sensor Coupler

FURTHER PRODUCT DETAILS

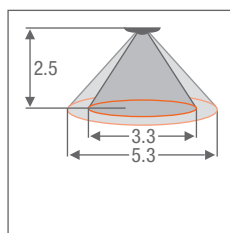

Detection area of the sensor in meter

Mounting height	2.0	2.5	3.0	4.0	5.0
Presence	2.5	3.3	4.0	5.0	–
Motion	4.5	5.3	6.0	7.0	7.0

FITTING COMPONENTS



**DALI COUPLER
MULTI3 G2**
4062172072113

DALI-2 sensor coupler to integrate MULTI 3 light and presence sensor into DALI installations

TECHNICAL DATA

Product name	GTIN (EAN)							COLOR	L x W x H [mm] Ø x H [mm]
LS/PD MULTI 3 CI	4008321916648	80°	6m	20...600	4	0...+50 °C	On-top ceiling mounting/ Ceiling integration	White	50 x 25

¹ Refer to www.ledvance.com/guarantee for precise conditions

The pictures shown in the catalog are for illustration purposes only. For information on size and color, please refer to the product table.

Products of OSRAM GmbH,
distributed by LEDVANCE.

OSRAM

DALI COUPLER MULTI3 G2

DALI-2 sensor coupler to integrate MULTI 3 light and presence sensor into DALI installations



PRODUCT FEATURES

- Coupler for integration of light and presence information in DALI installations
- 4p4c-connector for HF LS LI Sensor (Light- and motion detection via radar)
- Very low DALI Power consumption
- For sensor features see HF LS LI sensor

PRODUCT BENEFITS

- DALI-2 certified
- Multiple couplers connectable to the same DALI line
- Integreable in light- and building management systems supporting DALI-2 sensors

AREAS OF APPLICATION

- Connection of light and presence sensors in DALI systems
- Ceiling or independent installation via ECO CI KIT possible

EQUIPMENT / ACCESSORIES

- Multi-3 CI Sensor - Light and presence Sensor with PIR detection technology
- Separate installation possible with ECO CI KIT

FITTING COMPONENTS



LS/PD MULTI 3 CI
4008321916648

Light and presence sensor

TECHNICAL DATA

Product name	GTIN (EAN)	V _{IN}	Hz	T _a	Installation	COLOR	L × W × H [mm] Ø × H [mm]
DALI COUPLER MULTI3 G2	4062172072113	16	0	–20...+50 °C	Ceiling integration/ Luminaire integration	Light grey	118 × 30 × 21

¹ Refer to www.ledvance.com/guarantee for precise conditions

DALI COUPLER E G2

DALI-2 sensor coupler for integration of light and presence information in DALI installations



PRODUCT FEATURES

- Coupler for integration of light and presence information in DALI installations
- Switching input for motion detector (potential free)
- Analog input (0–10V) for light sensor

PRODUCT BENEFITS

- DALI-2 certified
- Output for presence detection feedback LEDs
- 24 V DC output for power supply of external sensors

AREAS OF APPLICATION

- Installation in industry and office luminaires
- Suitable for luminaire integration
- Corridors
- Warehouses

EQUIPMENT / ACCESSORIES

- Ceiling or independent installation via ECO CI KIT possible
- Suitable for external light and presence sensors

TECHNICAL DATA

Product name	GTIN (EAN)	V _{IN}	Hz	T _a	Icon	COLOR	L x W x H [mm] Ø x H [mm]
DALI COUPLER E G2	4062172072212	220...240	50/60	-20...+50 °C	Ceiling integration/ Luminaire integration	Light grey	118 x 30 x 21

¹ Refer to www.ledvance.com/guarantee for precise conditions

DALI COUPLER LS HIGHBAY G2

DALI-2 sensor coupler with integrated light sensor for HIGHBAY sensor



PRODUCT FEATURES

- Coupler for integration of light and presence information in DALI installations
- Integrated light sensor
- Adapter for integration of High Bay or Vision Sensor for motion detection
- For sensor features see HF LS LI sensor
- 4p4c-connector for HF LS LI Sensor (Light- and motion detection via radar)

PRODUCT BENEFITS

- DALI-2 certified
- Adaptable light sensor sensitivity for different mounting height
- Extended terminal section enables mains looping
- Flexible addressing via DALI-2
- Multiple couplers connectable to the same DALI line

AREAS OF APPLICATION

- Industry
- Production halls
- Sports halls
- Logistic centers
- Areas with high ceilings

EQUIPMENT / ACCESSORIES

- High Bay Sensor for big installation heights
- Vision Sensor for wide detection range

FITTING COMPONENTS



HIGH BAY
4008321410078

Movement sensor



VISION
4008321957047

Movement sensor

TECHNICAL DATA

Product name	GTIN (EAN)	V _{IN}	Hz	Lx	ih m	T _a	Mounting	COLOR	L x W x H [mm] Ø x H [mm]
DALI COUPLER LS HIGHBAY G2	4062172072137	16	0	20...800	13	-20...+50 °C	On-top ceiling mounting	White	139 x 118 x 37

¹ Refer to www.ledvance.com/guarantee for precise conditions

HIGH BAY

Motion sensor with switching contact for up to 13 m height, optional use with DALI HIGHBAY ADAPTER

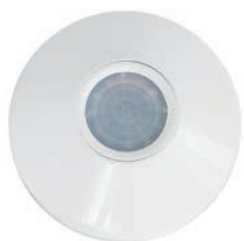

IP 20



5 year guarantee

PRODUCT FEATURES

- Motion sensor with switching contact
- 3 to 10 m: detection of motion by people
- 3 to 13 m: detection of vehicle movement (e.g. fork lift truck)
- Adjustable switch-off delay: 30 s to 20 min
- Maximum power consumption in stand-by mode: 0.25 W

PRODUCT BENEFITS

- Energy savings up to 35 % (compared to manual switching)

AREAS OF APPLICATION

- Great installation height
- Industry
- Production halls

EQUIPMENT / ACCESSORIES

- Suitable for up to 15 electronic control gears

FURTHER PRODUCT DETAILS

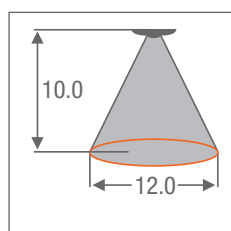

Detection area of the sensor in meter

Mounting height	4.0	6.0	8.0	10.0	13.0
Presence	–	–	–	–	–
Motion	10.0	12.0	12.0	12.0	–
Vehicles	10.0	12.0	12.0	12.0	18.0

FITTING COMPONENTS



DALI COUPLER LS HIGHBAY G2
4062172072137

DALI-2 sensor coupler with integrated light sensor

TECHNICAL DATA

Product name	GTIN (EAN)	V _{IN}	Hz	Beam angle	Beam diameter	Beam height	T _a	Mounting	COLOR	L x W x H [mm] Ø x H [mm]
HIGH BAY	4008321410078	120...277	50...60	100°	18 m	13	–10...+70 °C	On-top ceiling mounting	White	116 x 40

¹ Refer to www.ledvance.com/guarantee for precise conditions

The pictures shown in the catalog are for illustration purposes only. For information on size and color, please refer to the product table.

VISION

Motion sensors with switching contact



IP 20

LEDVANCE
5 year
guarantee¹

PRODUCT FEATURES

- Motion sensor with switching contact
- Adjustable switch-off delay: 30s to 20 min
- Maximum power consumption in stand-by mode: 0.25W

PRODUCT BENEFITS

- Energy savings up to 35% (compared to manual switching)

AREAS OF APPLICATION

- Large areas
- Open-plan offices, corridors and storage rooms

EQUIPMENT/ACCESSORIES

- Suitable for up to 15 electronic control gears

FURTHER PRODUCT DETAILS

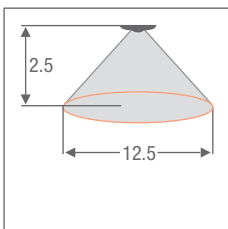

Detection area of the sensor in meter

Mounting height	2.0	2.5	3.0	4.0	4.5
Presence	–	–	–	–	–
Motion	12.5	15.5	19.0	21.0	21.0

FITTING COMPONENTS



DALI COUPLER LS HIGHBAY G2
4062172072137

DALI-2 sensor coupler with integrated light sensor

TECHNICAL DATA

Product name	GTIN (EAN)	V _{IN}	Hz	Beam angle	Beam diameter	h _m	T _a	Mounting	COLOR	L x W x H [mm] Ø x H [mm]
VISION	4008321957047	120...277	50...60	140°	21 m	4.5	–10...+70 °C	On-top ceiling mounting	White	116 x 40

¹ Refer to www.ledvance.com/guarantee for precise conditions

The pictures shown in the catalog are for illustration purposes only. For information on size and color, please refer to the product table.

Products of OSRAM GmbH,
distributed by LEDVANCE.

OSRAM

DALI COUPLER PB G2

DALI-2 pushbutton coupler to integrate standard switches in DALI systems

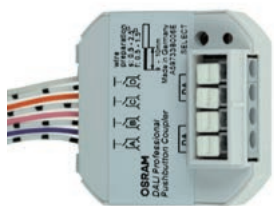

PRODUCT FEATURES

- DALI pushbutton coupler
- 4 floating inputs

PRODUCT BENEFITS

- Standard pushbuttons/switches can be used
- DALI-2 certified
- DALI Bus powered (No mains connection necessary)
- Multiple couplers connectable to the same DALI line

AREAS OF APPLICATION

- Suitable for installation in flush-type boxes
- Individual offices
- Classrooms
- Conference rooms
- Production and assembly facilities

TECHNICAL DATA

Product name	GTIN (EAN)	V _{IN}	Hz	T _a		No. of OUTPUTS	L x W x H [mm] Ø x H [mm]
DALI COUPLER PB G2	4062172087575	16	0	-20...+50 °C	Integrated in flush device box	4	43 x 43 x 21

¹ Refer to www.ledvance.com/guarantee for precise conditions

Products of OSRAM GmbH, distributed by LEDVANCE.



KNX

KNX interface for bi-directional communication between KNX system and DALI network



IP 20

LEDVANCE
5 year
guarantee¹

PRODUCT FEATURES

- Fully configured with the ETS Software and handles up to 250 group objects
- Powered via KNX Bus, no dedicated power supply necessary
- KNX programming interface according to KNXnet/IP specification
- LEDs show different work modes and communication errors on LAN and KNX Bus
- Buttons for diagnose functionality

PRODUCT BENEFITS

- Bi-directional communication between KNX and compatible OSRAM LMS und sensors
- In combination with DALI Professional, app control additionally to KNX possible
- With DALI Professional, DALI sensor information in KNX is available
- In combination with DALI Professional HCL, RGB solutions in KNX possible

AREAS OF APPLICATION

- Industry with heavy duty light regulation even in high bay areas
- Office with high end HCL functionality
- Representative areas with multi-color effects and Tunable White
- Shop and retail with colored and Tunable White lighting
- Healthcare and hospitality with HCL functionality

TECHNICAL DATA

Product name	GTIN (EAN)	Ta	Ø	L x W x H [mm] Ø x H [mm]
KNX IF 250	4062172020008	-5...+45 °C	Din Rail	90 x 18 x 62

¹ Refer to www.ledvance.com/guarantee for precise conditions

PANEL INDIVILED® DALI

Square recessed luminaire with IndiviLED® optics, with DALI-2 IoT technology



PRODUCT FEATURES

- Metal housing, lenses and reflectors made of polycarbonate (PC)
- Each LED with individual lens and reflector for $UGR \leq 16$ and homogenous light distribution
- Lifetime (L80/B10): up to 60000 h (at 25 °C)
- Initial color consistency: 3 SDCM
- Accessories available for various recessed and surface-mounted options

PRODUCT BENEFITS

- Homogenous light distribution and reduced glare thanks to the IndiviLED® optics
- Low-flicker light
- Robust structure with IK08
- 5 years guarantee

AREAS OF APPLICATION

- Direct replacement for luminaires with fluorescent lamps
- Corridors
- Offices
- Conference rooms
- Reception areas

EQUIPMENT / ACCESSORIES

- Accessories for several mounting options available*
- Security rope for luminaire included
- External control gear included

FURTHER PRODUCT DETAILS

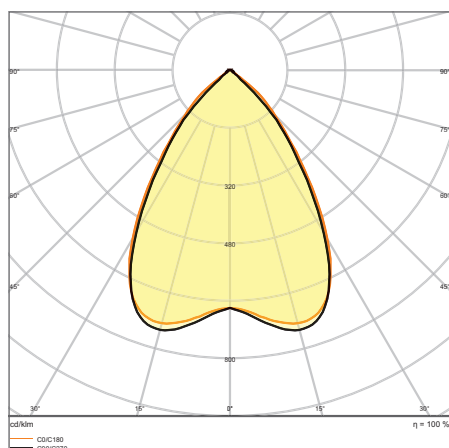

PL INDV 600 33W4000K DALI

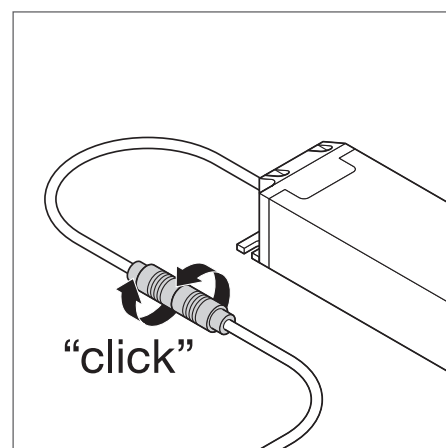
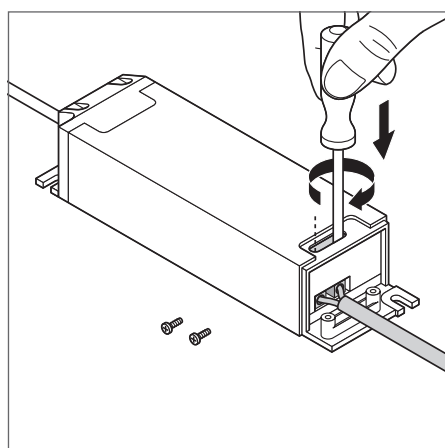

* Please note: available = available as an optional accessory.
 † Refer to www.ledvance.com/guarantee for precise conditions

The pictures shown in the catalog are for illustration purposes only. For information on size and color, please refer to the product table.

PANEL INDIVILED® DALI

Square recessed luminaire with IndiviLED® optics, with DALI-2 IoT technology

Product name	Segmentation	GTIN (EAN)	RE-PLACEMENT FOR	W	lm	lm/W	K	L70 ¹	L80 ¹		
PANEL INDV 600 33W 3000 K	■	4058075503885	4 × 18W/4 × 14W FL	33	3800	115	3000	80 000	60 000	70	DALI-2/IoT
PANEL INDV 600 33W 4000 K	■	4058075503861	4 × 18W/4 × 14W FL	33	4000	120	4000	80 000	60 000	70	DALI-2/IoT
PANEL INDV 625 DALI 33W 4000 K	■	4058075503922	4 × 18W/4 × 14W FL	33	4000	120	4000	80 000	60 000	70	DALI-2/IoT

Product name	CRI	UGR	Flicker Value	IK		L × W × H [mm] ∅ × H [mm]
PANEL INDV 600 33W 3000 K	≥ 80	< 16	< 5 %	IK08	3500	595 × 595 × 13
PANEL INDV 600 33W 4000 K	≥ 80	< 16	< 5 %	IK08	3500	595 × 595 × 13
PANEL INDV 625 DALI 33W 4000 K	≥ 80	< 16	< 5 %	IK08	3600	620 × 620 × 13

¹ t [h]: L70/B50 @ 25 °C (T_a)/t [h]: L80/B10 @ 25 °C (T_a)

■ SUPERIOR CLASS ■ PERFORMANCE CLASS ■ VALUE CLASS

PANEL PERFORMANCE UGR<19 DALI

Square recessed panel luminaires, tool-free installation and low glare, for ceiling systems with DALI-2 IoT technology



PRODUCT FEATURES

- Extruded aluminium frame, Polystyrene diffuser
- Lifetime (L80/B10): up to 60 000 h (at 25 °C)
- High luminous efficacy: up to 120 lm/W
- 5-pole terminal block, cable cross section up to 5 × 2.5 mm²

PRODUCT BENEFITS

- Comfortable light and high color consistency SDCM 3
- Through-wiring possible up to 2.5 qmm with included connector box
- Low-flicker light thanks to special electronic control gear
- Energy savings thanks to high system efficacy of up to 120 lm/w
- 5 years guarantee

AREAS OF APPLICATION

- Direct replacement for luminaires with fluorescent lamps
- Offices, conference rooms
- Reception areas, foyers, corridors, elevators

EQUIPMENT / ACCESSORIES

- Accessories for several mounting options available*
- Connector box with 5-pole terminal included
- Security rope for luminaire included

FURTHER PRODUCT DETAILS

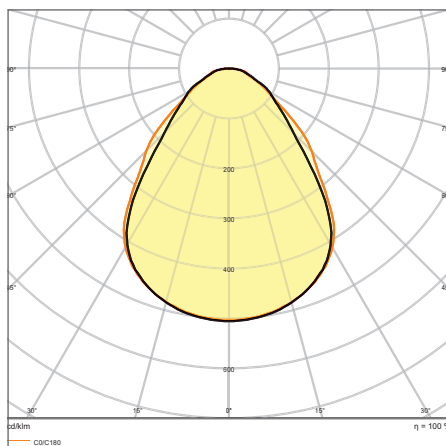

PL PFM 600 DALI 30W3000K UGR19

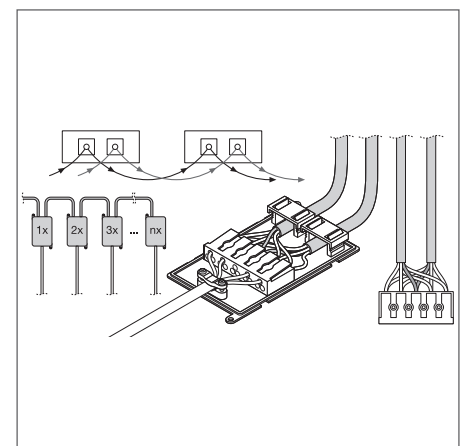
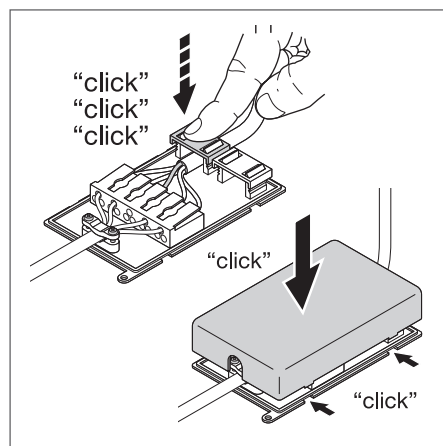

* Please note: available = available as an optional accessory.
 † Refer to www.ledvance.com/guarantee for precise conditions

The pictures shown in the catalog are for illustration purposes only. For information on size and color, please refer to the product table.

PANEL PERFORMANCE 600 UGR<19 DALI

Square recessed panel luminaires, tool-free installation and low glare, for 600 × 600 mm ceiling systems with DALI-2 IoT technology

Product name	Segmentation	GTIN (EAN)	RE-PLACEMENT FOR	W	lm	lm/w	K	L70 ¹	L80 ¹	△	⤵
PL PFM 600 UGR<19 DALI 30W 3000 K	■	4058075538085	4 × 18W/4 × 14W FL	30	3600	120	3000	100 000	60 000	90	DALI-2/IoT
PL PFM 600 UGR<19 DALI 30W 4000 K	■	4058075538122	4 × 18W/4 × 14W FL	30	3600	120	4000	100 000	60 000	90	DALI-2/IoT
PL PFM 600 UGR<19 DALI 36W 940	■	4058075521988	4 × 18W/4 × 14W FL	36	3750	105	4000	100 000	60 000	90	DALI-2/IoT
PL PFM 600 UGR<19 DALI 36W 3000 K	■	4058075440456	4 × 18W/4 × 14W FL	36	4320	120	3000	100 000	60 000	90	DALI-2/IoT
PL PFM 600 UGR<19 DALI 36W 4000 K	■	4058075440470	4 × 18W/4 × 14W FL	36	4320	120	4000	100 000	60 000	90	DALI-2/IoT

Product name	CRI	UGR	FLICKER VALUE	IK	g	L × W × H [mm]	⌀ × H [mm]	Light bulb icon
PL PFM 600 UGR<19 DALI 30W 3000 K	>80	<19	<5%	IK02	1950	595 × 595 × 32	2	No
PL PFM 600 UGR<19 DALI 30W 4000 K	>80	<19	<5%	IK02	1950	595 × 595 × 32	2	No
PL PFM 600 UGR<19 DALI 36W 940	>90	<19	<5%	IK02	2000	595 × 595 × 32	2	No
PL PFM 600 UGR<19 DALI 36W 3000 K	>80	<19	<5%	IK03	2000	595 × 595 × 32	2	No
PL PFM 600 UGR<19 DALI 36W 4000 K	>80	<19	<5%	IK03	2000	595 × 595 × 32	2	No

PANEL PERFORMANCE 625 UGR<19 DALI

Square recessed panel luminaires, tool-free installation and low glare, for 625 × 625 mm ceiling systems with DALI-2 IoT technology

Product name	Segmentation	GTIN (EAN)	RE-PLACEMENT FOR	W	lm	lm/w	K	L70 ¹	L80 ¹	△	⤵
PL PFM 625 UGR<19 DALI 30W 3000 K	■	4058075538221	4 × 18W/4 × 14W FL	30	3600	120	3000	100 000	60 000	90	DALI-2/IoT
PL PFM 625 UGR<19 DALI 30W 4000 K	■	4058075538252	4 × 18W/4 × 14W FL	30	3600	120	4000	100 000	60 000	90	DALI-2/IoT
PL PFM 625 UGR<19 DALI 36W 3000 K	■	4058075440753	4 × 18W/4 × 14W FL	36	4320	120	3000	100 000	60 000	90	DALI-2/IoT
PL PFM 625 UGR<19 DALI 36W 4000 K	■	4058075440777	4 × 18W/4 × 14W FL	36	4320	120	4000	100 000	60 000	90	DALI-2/IoT

Product name	CRI	UGR	FLICKER VALUE	IK	g	L × W × H [mm]	⌀ × H [mm]	Light bulb icon
PL PFM 625 UGR<19 DALI 30W 3000 K	>80	<19	<5%	IK02	2200	620 × 620 × 32	3	No
PL PFM 625 UGR<19 DALI 30W 4000 K	>80	<19	<5%	IK02	2200	620 × 620 × 32	3	No
PL PFM 625 UGR<19 DALI 36W 3000 K	>80	<19	<5%	IK03	2200	620 × 620 × 32	3	No
PL PFM 625 UGR<19 DALI 36W 4000 K	>80	<19	<5%	IK03	2200	620 × 620 × 32	3	No

PANEL PERFORMANCE 1200 × 300 UGR<19 DALI

Rectangular recessed panel luminaires, tool-free installation and low glare, for 1200 × 300 mm ceiling systems with DALI-2 IoT technology

Product name	Segmentation	GTIN (EAN)	RE-PLACEMENT FOR	W	lm	lm/w	K	L70 ¹	L80 ¹	△	⤵
PL PFM 1200X300 UGR<19 DALI 30W/940	■	4058075522022	2 × 36W FL	30	3000	100	4000	100 000	60 000	90	DALI-2/IoT
PL PFM 1200X300 UGR<19 DALI 30W 3000 K	■	4058075440210	2 × 36W FL	30	3450	115	3000	100 000	60 000	90	DALI-2/IoT
PL PFM 1200X300 UGR<19 DALI 30W 4000 K	■	4058075440630	2 × 36W FL	30	3600	120	4000	100 000	60 000	90	DALI-2/IoT

¹ t [h]: L70/B50 @ 25 °C (T_a)/t [h]: L80/B10 @ 25 °C (T_a)

■ SUPERIOR CLASS ■ PERFORMANCE CLASS ■ VALUE CLASS

PANEL PERFORMANCE DALI

Square recessed panel luminaires, tool-free installation, for ceiling systems with DALI-2 IoT technology

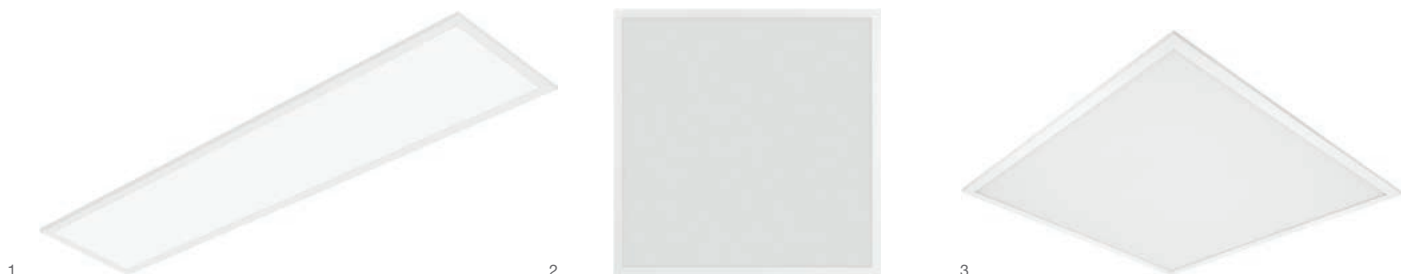

PRODUCT FEATURES

- Extruded aluminium frame, Polystyrene diffuser
- Lifetime (L80/B10): up to 60 000 h (at 25 °C)
- High luminous efficacy: up to 120 lm/W
- 5-pole terminal block, cable cross section up to 5 × 2.5 mm²

PRODUCT BENEFITS

- Comfortable light and high color consistency
- Through-wiring possible up to 2.5 qmm with included connector box
- Low-flicker light thanks to special electronic control gear
- Energy savings thanks to high system efficacy of up to 120 lm/w
- 5 years guarantee

AREAS OF APPLICATION

- Direct replacement for luminaires with fluorescent lamps
- Offices, conference rooms
- Reception areas, foyers, corridors, elevators

EQUIPMENT / ACCESSORIES

- Accessories for several mounting options available*
- Connector box with 5-pole terminal included
- Security rope for luminaire included

FURTHER PRODUCT DETAILS

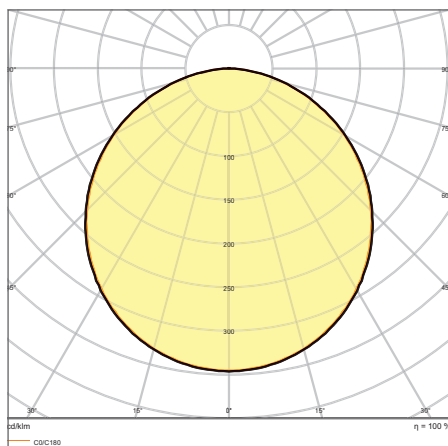

PL PFM 600 DALI 30W3000K

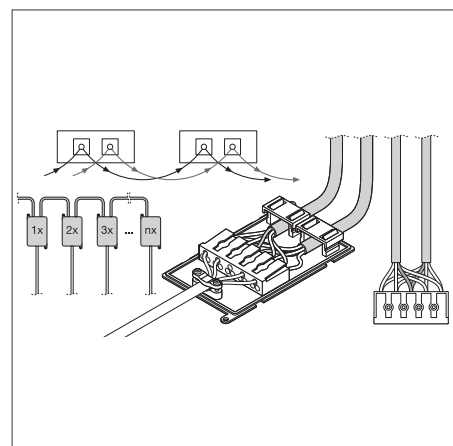
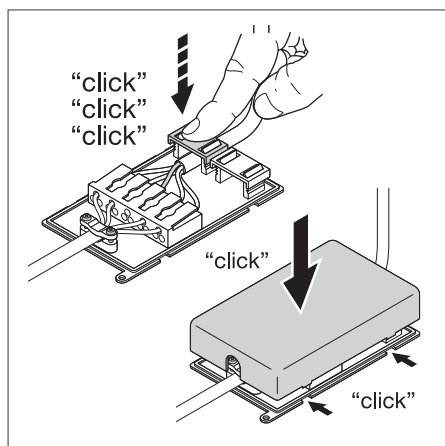

* Please note: available = available as an optional accessory.
 † Refer to www.ledvance.com/guarantee for precise conditions

The pictures shown in the catalog are for illustration purposes only. For information on size and color, please refer to the product table.

PANEL PERFORMANCE 600 DALI

Square recessed panel luminaires, tool-free installation, for 600 × 600 mm ceiling systems with DALI-2 IoT technology

Product name	Segmentation	GTIN (EAN)	RE-PLACEMENT FOR	W	lm	lm/W	K	L70 [†]	L80 [†]		
PL PFM 600 DALI 30W 3000 K	■	4058075537972	4 × 18W/4 × 14W FL	30	3600	120	3000	100 000	60 000	120	DALI-2/loT
PL PFM 600 DALI 30W 4000 K	■	4058075538030	4 × 18W/4 × 14W FL	30	3600	120	4000	100 000	60 000	120	DALI-2/loT
PL PFM 600 DALI 36W 3000 K	■	4058075440357	4 × 18W/4 × 14W FL	36	4320	120	3000	100 000	60 000	120	DALI-2/loT
PL PFM 600 DALI 36W 4000 K	■	4058075440395	4 × 18W/4 × 14W FL	36	4320	120	4000	100 000	60 000	120	DALI-2/loT

Product name	CRI	UGR	FLICKER VALUE	IK		L × W × H [mm] ∅ × H [mm]	
PL PFM 600 DALI 30W 3000 K	>80	<22	<5 %	IK02	1700	595 × 595 × 32	2
PL PFM 600 DALI 30W 4000 K	>80	<22	<5 %	IK02	1700	595 × 595 × 32	2
PL PFM 600 DALI 36W 3000 K	>80	<22	<5 %	IK03	1750	595 × 595 × 32	2
PL PFM 600 DALI 36W 4000 K	>80	<22	<5 %	IK03	1750	595 × 595 × 32	2

PANEL PERFORMANCE 625 DALI

Square recessed panel luminaires, tool-free installation, for 625 × 625 mm ceiling system with DALI-2 IoT technology

Product name	Segmentation	GTIN (EAN)	RE-PLACEMENT FOR	W	lm	lm/W	K	L70 [†]	L80 [†]		
PL PFM 625 DALI 30W/3000 K	■	4058075538160	4 × 18W/4 × 14W FL	30	3600	120	3000	100 000	60 000	120	DALI-2/loT
PL PFM 625 DALI 30W/4000 K	■	4058075538191	4 × 18W/4 × 14W FL	30	3600	120	4000	100 000	60 000	120	DALI-2/loT
PL PFM 625 DALI 36W/3000 K	■	4058075440616	4 × 18W/4 × 14W FL	36	4320	120	3000	100 000	60 000	120	DALI-2/loT
PL PFM 625 DALI 36W/4000 K	■	4058075440654	4 × 18W/4 × 14W FL	36	4320	120	4000	100 000	60 000	120	DALI-2/loT

Product name	CRI	UGR	FLICKER VALUE	IK		L × W × H [mm] ∅ × H [mm]	
PL PFM 625 DALI 30W/3000 K	>80	<22	<5 %	IK02	1900	620 × 620 × 32	3
PL PFM 625 DALI 30W/4000 K	>80	<22	<5 %	IK02	1900	620 × 620 × 32	3
PL PFM 625 DALI 36W/3000 K	>80	<22	<5 %	IK03	1900	620 × 620 × 32	3
PL PFM 625 DALI 36W/4000 K	>80	<22	<5 %	IK03	1900	620 × 620 × 32	3

PANEL PERFORMANCE 1200 × 300 DALI

Rectangular recessed panel luminaires, tool-free installation for 1200 × 300 mm ceiling systems with DALI-2 IoT technology

Product name	Segmentation	GTIN (EAN)	RE-PLACEMENT FOR	W	lm	lm/W	K	L70 [†]	L80 [†]		
PL PFM 1200X300 DALI 33W 3000 K	■	4058075440135	2 × 36W FL	33	4000	120	3000	100 000	60 000	120	DALI-2/loT
PL PFM 1200X300 DALI 33W 4000 K	■	4058075440173	2 × 36W FL	33	4000	120	4000	100 000	60 000	120	DALI-2/loT

Product name	CRI	UGR	FLICKER VALUE	IK		L × W × H [mm] ∅ × H [mm]	
PL PFM 1200X300 DALI 33W 3000 K	>80	<22	<5 %	IK03	1600	1195 × 295 × 9	1
PL PFM 1200X300 DALI 33W 4000 K	>80	<22	<5 %	IK03	1600	1195 × 295 × 9	1

[†] t [h]: L70/B50 @ 25 °C (T_a)/t [h]: L80/B10 @ 25 °C (T_a) ■ SUPERIOR CLASS ■ PERFORMANCE CLASS ■ VALUE CLASS

COMPATIBILITY OF PANEL ACCESSORIES WITH PANEL FAMILIES¹

1. SURFACE MOUNT KIT



- Pre-assembled ready to install
- Simple fixing with magnets
- Cross brace for greater stability
- Material: aluminum

2. SURFACE MOUNT KIT VALUE



- Kit for tool-free mounting with corner clips
- Material: aluminum

3. EMERGENCY CONVERSION BOX



- Conversion of a selection of panels to safety luminaires
- Reduces warehousing complexity
- Plug-and-play system for easy installation

4. SUSPENSION KIT



- Suspension length: 1500 mm
- Material: steel

5. RECESSED MOUNT CLIPS



- Ceiling thickness: 10 to 20 mm
- Material: steel

6. RECESSED MOUNT FRAME



- Pre-assembled ready to install
- Seamless recessed mounting
- Ceiling thickness: 8 to 30 mm
- Material: aluminum



COMPATIBILITIES AT A GLANCE

Accessories	GTIN (EAN)	Panel IndiviLED	Panel Performance
1 Panel 600 Surface Mount Kit H75	4058075472914		✓
	4058075472938		✓
	4058075108820		✓
2 Panel 600 Surface Mount Kit H70 Value	4058075402843		✓
	4058075402867		✓
	4058075472952		✓
3 Emergency Conversion Box AT 3H	4058075237025	✓ ²	✓ ³
4 Panel Suspension Kit	4058075402928	✓ ²	✓
5 Panel Recessed Mount Clips Value 4x	4058075409859	✓	✓
6 Panel 600 Recessed Mount Frame	4058075402881		✓
	4058075402904		✓
	4058075472976		✓

¹ The accessories are compatible with the Panels in the respectively matching size. For details refer to the User Instructions. | ² Not in combination with Panel IndiviLED Emergency
³ Not in combination with Surface Mount Kits, Surface Mount Clips or Suspension Kit

Technical product details for panel accessories found on next page



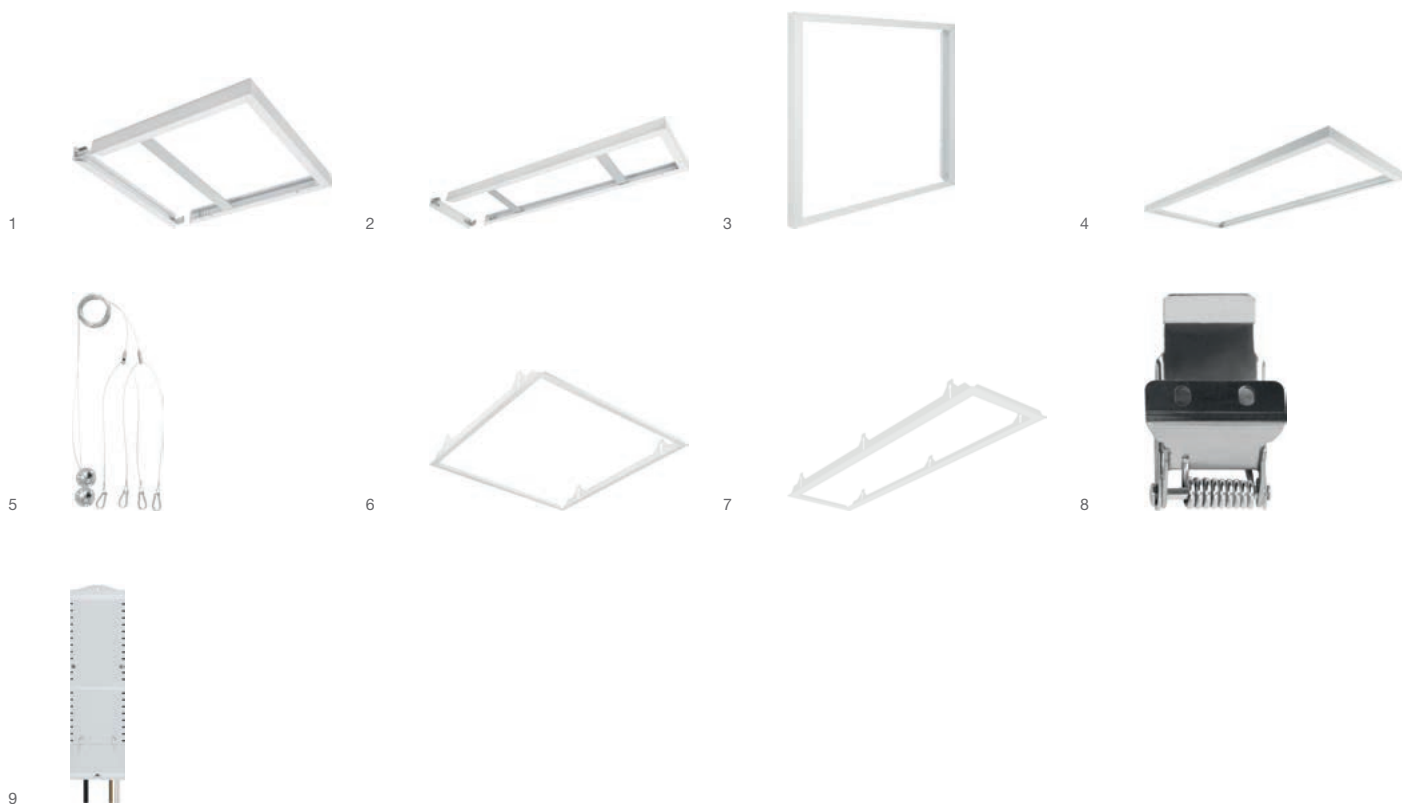

PANEL ACCESSORIES

Mounting accessories for panel luminaires, combination according to the accessories matrix



- Suspension Kit: suspension length 1.5 m adjustable for various applications by screw connection
- Surface Mount Kit: sturdy, cross-stiffened aluminum frame with magnetic corners

- Surface Mount Kit Value: Aluminum frame with polycarbonate strip. With rectangular frame, panel insertion is possible from short or long frame side.
- Recessed Mount Clips Value 1 × 4: ceiling thickness 10–20 mm, plasterboard, wood and metal ceilings

Product name	GTIN (EAN)	L × W × H [mm] ∅ × H [mm]	MATERIAL	COLOR	 No.	 No.
PANEL 600 SURFACE MOUNT KIT H75	4058075 472914	601 × 601 × 75	Aluminum	White	1	1
PANEL 625 SURFACE MOUNT KIT H75	4058075 472938	626 × 626 × 75	Aluminum	White	1	1
PANEL 1200 Surface Mount Kit	4058075 108820	1 201 × 301 × 56	Aluminum	White	1	2
PANEL 1200x300 SURFACE MOUNT KIT VAL	4058075 472952	1 212 × 312 × 52	Aluminum	White	1	4
PANEL 600 SURFACE MOUNT KIT H70 VAL	4058075 402843	613 × 613 × 70	Aluminum	White	1	3
PANEL 625 SURFACE MOUNT KIT H70 VAL	4058075 402867	638 × 638 × 70	Aluminum	White	1	3
PANEL Suspension Kit	4058075 402928	30 × –	Steel	Steel	1	5
PANEL 600 RECESSED MOUNT FRAME	4058075 402881	625 × 625 × 76	Aluminum	White	1	6
PANEL 625 RECESSED MOUNT FRAME	4058075 402904	650 × 650 × 76	Aluminum	White	1	6
PANEL 1200x300 RECESSED MOUNT FRAME	4058075 472976	1 224 × 324 × 76	Aluminum	White	1	7
PANEL RECESSED MOUNT CLIPS VAL 4x	4058075 409859	25 × 45 × 33	Steel	Steel	4	8
EM CONVERSION BOX	4058075 237025	292 × 81 × 41	–	–	1	9

PANEL DIRECT/INDIRECT 1 200 UGR<19 DALI

Suspended edge-lit luminaires for direct and indirect light emission, low glare, 1200 mm with DALI-2 IoT technology



PRODUCT FEATURES

- Very slim aluminum housing
- Rectangular (1200 mm × 300 mm) stand-alone luminaires with direct (70 %) and indirect (30 %) light emission
- Steel cable suspension, length: 1.5 m
- Lifetime (L70/B50): up to 50 000 h (at 25 °C)

PRODUCT BENEFITS

- Functional SCALE design luminaire for office applications (driver integrated in the ceiling rose)
- Special directional light design and PMMA diffuser for homogeneous, low-glare lighting (UGR < 19)
- Low flicker light thanks to special electronic control gear
- Comfortable light and high color consistency SDCM ≤ 3
- 5 years guarantee

AREAS OF APPLICATION

- Efficient replacement for traditional T8 and T5 luminaires
- Offices
- Meeting rooms
- Conference rooms
- Reception areas and foyers

EQUIPMENT / ACCESSORIES

- Suspension kit included

FURTHER PRODUCT DETAILS

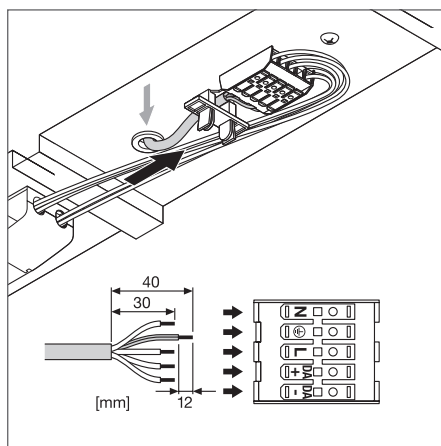
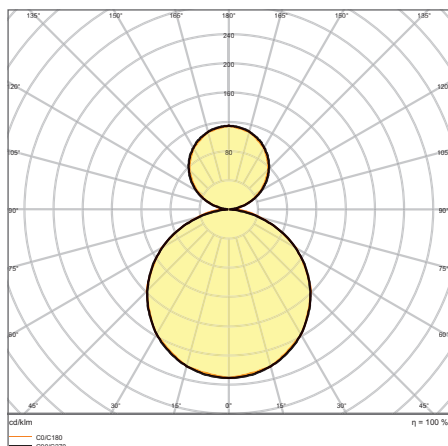

PANEL DI 1200 36W4000K UGR19 DALI

¹ Refer to www.ledvance.com/guarantee for precise conditions

The pictures shown in the catalog are for illustration purposes only. For information on size and color, please refer to the product table.

PANEL DIRECT/INDIRECT 1 200 UGR<19 DALI

Suspended edge-lit luminaires for direct and indirect light emission, low glare, 1200 mm with DALI-2 IoT technology

Product name	Segmentation	GTIN (EAN)	RE-PLACEMENT FOR	W	lm	lm/W	K	L70 ¹	L80 ¹		
PANEL D/I 1200 UGR<19 DALI 36W 3000 K	■	4058075 504028	2 x 58W FL	36	3800	105	3000	80000	60000	110	DALI-2/IoT
PANEL D/I 1200 UGR<19 DALI 36W 4000 K	■	4058075 504042	2 x 58W FL	36	4000	110	4000	80000	60000	110	DALI-2/IoT

Product name	CRI	UGR	FLICKER VALUE	IK		L x W x H [mm] ∅ x H [mm]
PANEL D/I 1200 UGR<19 DALI 36W 3000 K	≥ 80	< 19	< 5 %	IK03	3500	1200 x 300 x 16
PANEL D/I 1200 UGR<19 DALI 36W 4000 K	≥ 80	< 19	< 5 %	IK03	3500	1200 x 300 x 16

¹ t [h]: L70/B50 @ 25 °C (T_a)/t [h]: L80/B10 @ 25 °C (T_a) ■ SUPERIOR CLASS ■ PERFORMANCE CLASS ■ VALUE CLASS

LINEAR INDIVILED® DIRECT DALI

Surface mounted luminaire for single luminaire or light line application with DALI-2 IoT technology



PRODUCT FEATURES

- Aluminum housing, plastic end caps, white
- Each LED with individual lens and reflector for $UGR \leq 16$ and homogeneous light distribution
- Usable as a single or strip lighting luminaire
- Mountable directly on the ceiling as a surface-mounted luminaire without additional accessories
- The suspension kit has to be ordered separately as an accessory

PRODUCT BENEFITS

- Luminaire in timeless SCALE design, usable as a single or lighting strip solution
- Also usable as pendant (order accessories separately)
- Low flicker light thanks to special electronic control gear
- All versions with 5-year guarantee, except emergency version: 3 years (built-in 3h battery)

AREAS OF APPLICATION

- Direct replacement for luminaires with fluorescent lamps
- Offices, schools
- General indoor illumination
- Corridors, entrance areas
- Seamless linear lighting

EQUIPMENT / ACCESSORIES

- Suspension kit available*
- Line connection adapter available*

FURTHER PRODUCT DETAILS

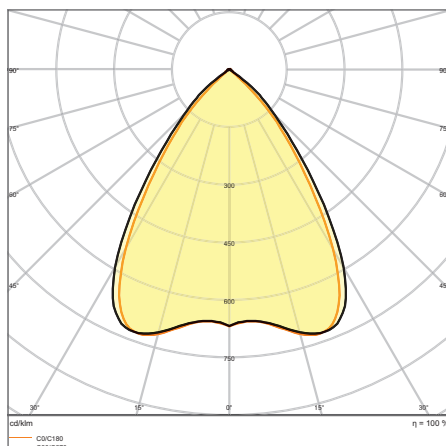

LN INDV D 1200 34W4000K DALI

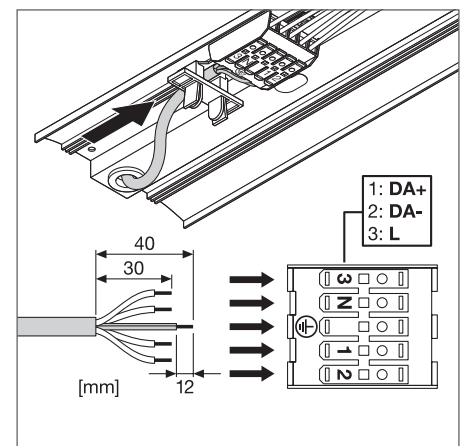
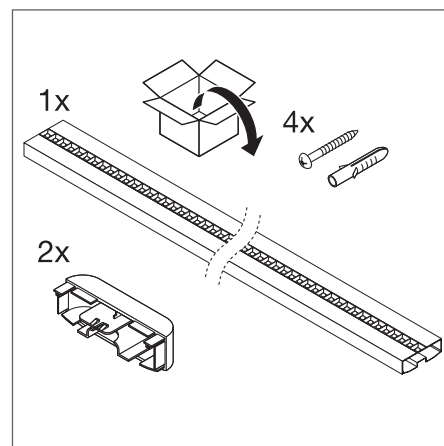

* Please note: available = available as an optional accessory.
 † Refer to www.ledvance.com/guarantee for precise conditions

The pictures shown in the catalog are for illustration purposes only. For information on size and color, please refer to the product table.

LINEAR INDIVILED® DIRECT DALI

Surface mounted luminaire for single luminaire or light line application with DALI-2 IoT technology

Product name	Segmentation	GTIN (EAN)	RE-PLACEMENT FOR	W	lm	lm/W	K	L70 ¹	L80 ¹		
LN INDV D DALI 1200 34W 3000 K	■	4058075503946	2 × 28W FL	34	3800	110	3000	60 000	50 000	70	DALI-2/IoT
LN INDV D DALI 1200 34W 4000 K	■	4058075503960	2 × 28W FL	34	4200	125	4000	60 000	50 000	70	DALI-2/IoT
LN INDV D DALI 1500 48W 3000 K	■	4058075503984	2 × 49W FL	48	5300	110	3000	60 000	50 000	70	DALI-2/IoT
LN INDV D DALI 1500 48W 4000 K	■	4058075504004	2 × 49W FL	48	5700	120	4000	60 000	50 000	70	DALI-2/IoT

Product name	CRI	UGR	FLICKER VALUE	IK		L × W × H [mm] Ø × H [mm]
LN INDV D DALI 1200 34W 3000 K	>80	<16	<5%	IK06	2500	1199 × 120 × 40
LN INDV D DALI 1200 34W 4000 K	>80	<16	<5%	IK06	2500	1199 × 120 × 40
LN INDV D DALI 1500 48W 3000 K	>80	<16	<5%	IK06	3200	1488 × 120 × 40
LN INDV D DALI 1500 48W 4000 K	>80	<16	<5%	IK06	3200	1488 × 120 × 40

¹ t [h]: L70/B50 @ 25 °C (T_a)/t [h]: L80/B10 @ 25 °C (T_a)

■ SUPERIOR CLASS ■ PERFORMANCE CLASS ■ VALUE CLASS

LINEAR INDIVILED® DIRECT ACCESSORIES

Mounting accessories for LINEAR INDIVILED® luminaires



- DALI Suspension Kit:
1 × transparent 1.5 m cable 5 × 0.75 mm +
2 × Y wire suspension 1.5 m
- Suspension Wire:
1 × Y wire suspension 1.5 m
- Through Wiring Kit:
3 × 1.5 mm with fast connector

Product name	GTIN (EAN)	L × W × H [mm] ∅ × H [mm]	MATERIAL	COLOR		
LN INDV DALI Suspension Kit	4058075133303	100 × 25	Steel	White	1	1
LN INDV Suspension Wire	4058075133327	1560 × 1 × 1	Steel	Steel	1	2
LN INDV Lightline Connector	4058075133341	82 × 40 × 12	Steel	Steel	1	3
LN INDV 1200 Through Wiring Kit	4058075158030	1250 × 20 × 7	Polycarbonate (PC)	Yellow	1	4
LN INDV 1500 Through Wiring Kit	4058075133365	1560 × 20 × 7	Polycarbonate (PC)	Yellow	1	4
LN INDV DALI 1200 Through Wiring Kit	4058075158016	1250 × 13 × 7	Polycarbonate (PC)	Yellow	1	5
LN INDV DALI 1500 Through Wiring Kit	4058075157996	1560 × 13 × 7	Polycarbonate (PC)	Yellow	1	5

¹ Refer to www.ledvance.com/guarantee for precise conditions

OUR CHECKLIST FOR YOUR LINEAR INDIVILED DALI SYSTEM

Typical installation: We have put together for you all the necessary components for suspended installation of three luminaires as strip lighting. For more information see the operating instructions for Linear IndiviLED.

UP TO 20 LUMINAIRES!

INSTALLATION OF 3 × LINEAR INDIVILED DALI

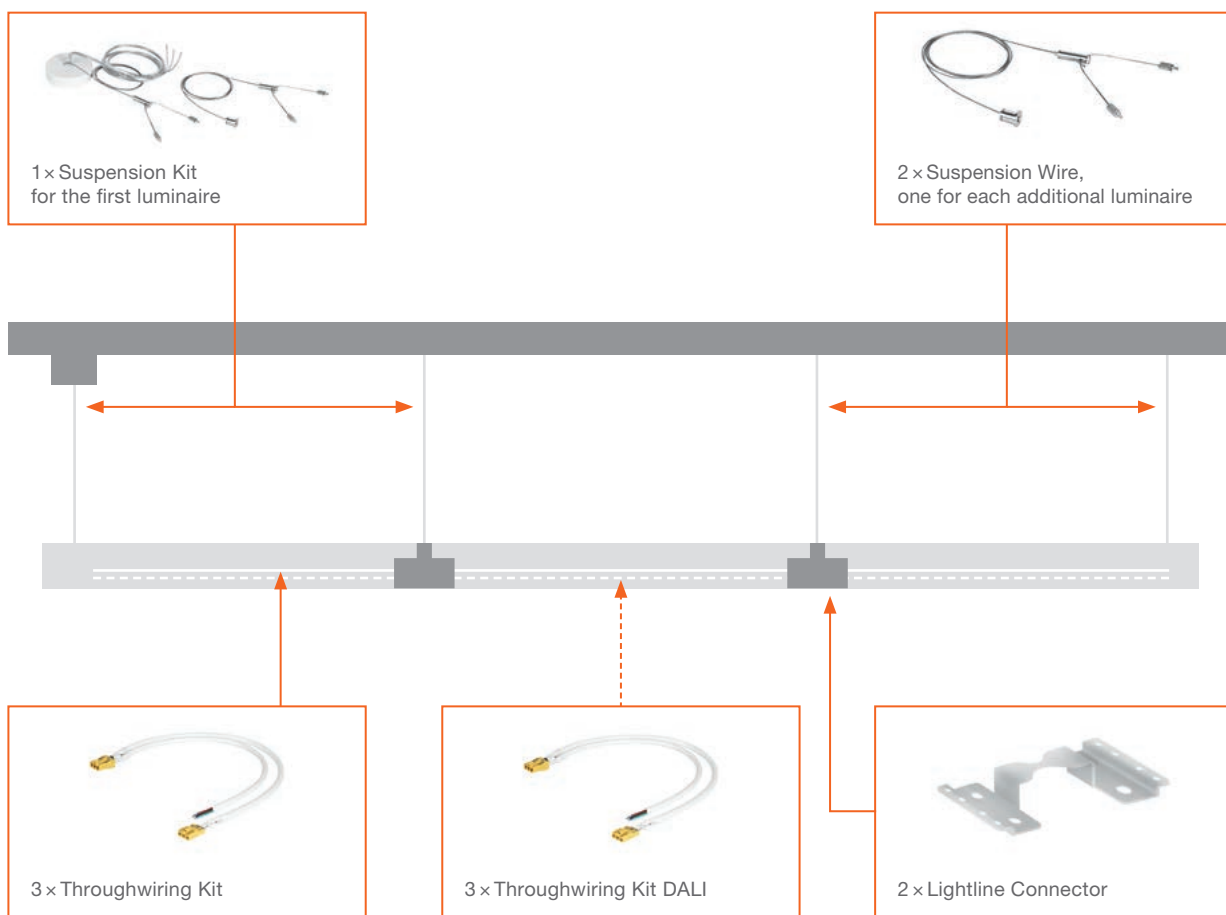

The through-wiring must be fitted by an installer.

ORDER LIST

- 3 × Linear IndiviLED Luminaire
- 3 × Throughwiring Kit
- 3 × Throughwiring Kit DALI
- 2 × Lightline Connector
- 1 × Suspension Kit
- 2 × Suspension Wire



DOWNLIGHT UGR19 DALI

Low-glare downlights, suitable for computer screen workplaces with DALI-2 IoT technology



PRODUCT FEATURES

- Housing Material: aluminium with mirror-finished reflector
- Type of protection: IP54 (room side) / IP20 (back side)
- Through wiring possible
- Connector box with push wire terminal for tool-free connection

PRODUCT BENEFITS

- Good glare reduction (UGR < 19) and cut-off angle up to 30° for comfortable indoor lighting
- Easy and quick installation thanks to connector box with 5-pole toolless terminal
- Low-flicker light
- Suitable for use in dusty and humid environments thanks to high IP rating
- 5 years guarantee

AREAS OF APPLICATION

- Suitable for office applications, especially for computer screen workplaces
- Direct replacement for luminaires with compact fluorescent lamps
- Entrances/Hallways
- Bathrooms, kitchens and sheltered outdoor areas
- General illumination

EQUIPMENT / ACCESSORIES

- External control gear included

FURTHER PRODUCT DETAILS

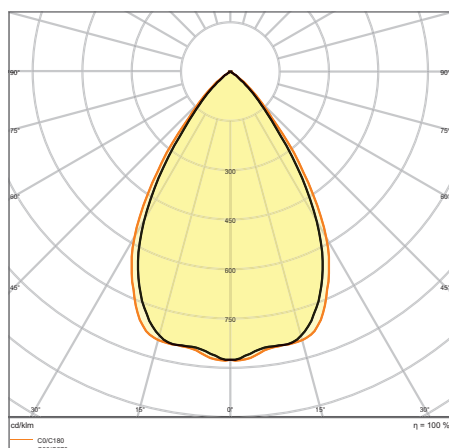

DL UGR19 DN155 PFM 14W830 DALI WT

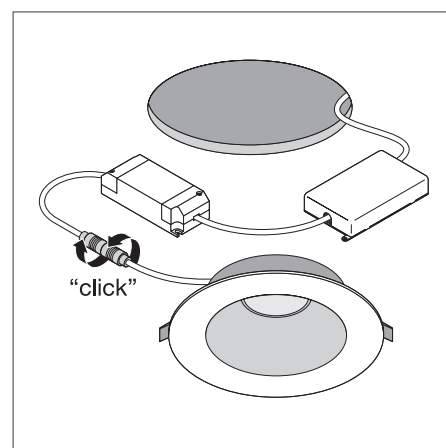
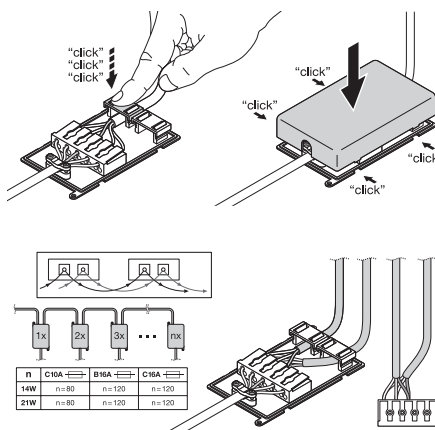

¹ Refer to www.ledvance.com/guarantee for precise conditions

The pictures shown in the catalog are for illustration purposes only. For information on size and color, please refer to the product table.

DOWNLIGHT UGR19 DALI

Low-glare downlights, suitable for computer screen workstations with DALI-2 IoT technology

Product name	Segmentation	GTIN (EAN)	RE-PLACEMENT FOR	W	lm	lm/W	K	L70 ¹	L80 ¹		
DL UGR19 PFM DN155 14 W 830 WT IP54 DALI	■	4058075459298	1 × 26W CFLi	14	1500	105	3000	70 000	60 000	65	DALI-2 IoT
DL UGR19 PFM DN155 14 W 840 WT IP54 DALI	■	4058075459311	1 × 26W CFLi	14	1600	115	4000	70 000	60 000	65	DALI-2 IoT
DL UGR19 PFM DN195 21 W 830 WT IP54 DALI	■	4058075459830	2 × 26W CFLi	21	2400	115	3000	70 000	60 000	65	DALI-2 IoT
DL UGR19 PFM DN195 21 W 840 WT IP54 DALI	■	4058075459854	2 × 26W CFLi	21	2520	120	4000	70 000	60 000	65	DALI-2 IoT

Product name	CRI	UGR	FLICKER VALUE	IK			L × W × H [mm] Ø × H [mm]
DL UGR19 PFM DN155 14 W 830 WT IP54 DALI	≥ 80	< 19	< 10 %	IK03	155	650	180 × 65
DL UGR19 PFM DN155 14 W 840 WT IP54 DALI	≥ 80	< 19	< 10 %	IK03	155	650	180 × 65
DL UGR19 PFM DN195 21 W 830 WT IP54 DALI	≥ 80	< 19	< 10 %	IK03	195	900	220 × 82
DL UGR19 PFM DN195 21 W 840 WT IP54 DALI	≥ 80	< 19	< 10 %	IK03	195	900	220 × 82

¹ t [h]: L70/B50 @ 25 °C (T_a)/t [h]: L80/B10 @ 25 °C (T_a) ■ SUPERIOR CLASS ■ PERFORMANCE CLASS ■ VALUE CLASS

OUR FRIENDLY SUPPORT FOR YOU SERVICES FOR YOUR WHOLE PROJECT

PROFESSIONAL PLANNING

DIALUX AND RELUX

LEDVANCE is collaborating with the developers of DIALux and Relux software. So you can now easily integrate LEDVANCE products in your lighting plans. Do you or your clients use the BIM method? Our luminaire data is BIM-compatible!

COMPLETE SUPPORT FROM A SINGLE SOURCE

Take advantage of our professional, tailor-made advice for successful and smooth planning of your lighting project. We take care of the entire process and offer you customized solutions for all your lighting requirements – all from a single source.

YOUR BENEFITS AT A GLANCE

LEDVANCE carries out the complete calculation for your lighting project:

- Optimal light distribution
- Precise wattage per sqm
- Most efficient calculation of the number of luminaires and VIVARES components required

Would you like to use LEDVANCE VIVARES to meet your customers' needs to perfection, but are not 100 % sure about some things? Then take advantage of the cooperative support our experts offer. They will work alongside you and will be on hand with advice at any stage of your project.

PREPLANNING AND PRECONFIGURATION

On request, LEDVANCE will take over complete preconfiguration of the system and all its components. This will allow you to carry out commissioning on site quickly, easily and efficiently. You can find information about our planning support in the gray box on the left.

COMMISSIONING AND INSTRUCTION

After you have installed the luminaires and components, you can also use the professional programming and commissioning service provided by our experts. This will ensure that the VIVARES system meets your customer's needs in the best possible way. Our experts will also instruct you in the system and show you how to get the most out of it.

DURING OPERATION

Even if the VIVARES system has long been commissioned, you can rely on us at any time. For example, if there are any problems our experts will take care of troubleshooting on site. And if the requirements of the VIVARES system change over time? Then LEDVANCE will be happy to support you in reprogramming, reconfiguring or expanding the system.

Do you have any questions about your VIVARES project or would you like any help? Then just email or call us!

E-Mail: kundenservice@ledvance.com

Tel.: +49 89 780673-660

WHENEVER AND WHEREVER: THE ONLINE PORTAL WITH ALL THE INFORMATION, ADVICE AND EXPERTISE

Are you looking for information about our products and services? LEDVANCE always keeps you up to date: at wholesalers, through our sales employees or via our Customer Service Center (email: contact@ledvance.com). Here you'll find an overview of our competencies, databases and tools.

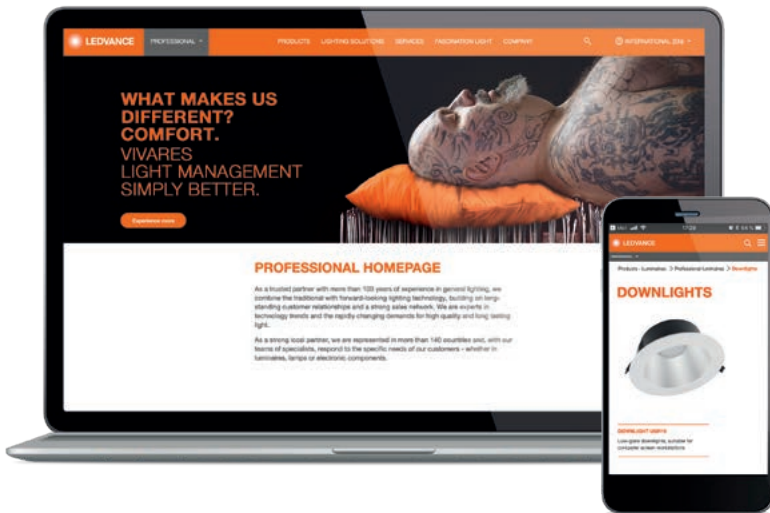

- ▶ **PERFECTLY FILTERED**
Use the online filters to find precisely what you're looking for in our luminaire and LMS portfolio – type of mounting, IP rating, light color, etc.: [ledvance.com/luminaires](https://www.ledvance.com/luminaires) and [ledvance.com/light-management-systems](https://www.ledvance.com/light-management-systems)
- ▶ **REFERENCES PROVIDE INSPIRATION**
A selection of some top lighting projects can be found at: [ledvance.com/projects](https://www.ledvance.com/projects)
- ▶ **LEDVANCE SERVICE-PLUS**
Our specialized sales department supports and advises our commercial end customers – including face-to-face. Find out all you need to know at [ledvance.com/vam](https://www.ledvance.com/vam)
- ▶ **DOWNLOAD CENTER**
Catalogs, compatibility overviews, brochures, and much more are available for you in our download center: [ledvance.com/download](https://www.ledvance.com/download)
- ▶ **OUR TOOLS FOR YOU**
From the Fast Light Calculation Tool to the LED Strip System Configurator – find our practical tools at: [ledvance.com/tools](https://www.ledvance.com/tools)
- ▶ **SERVICE AT A GLANCE**
You will find a summary of all of our service offerings at [ledvance.com/services](https://www.ledvance.com/services)
- ▶ **FIND OUR LATEST NEWS ON:**



NEW: THE ONLINE TRAINING PLATFORM

A host of application-oriented eLearnings for professional users, practical advice on installation, integrated standards checks, planning tips, and much more.

Register and find out more at training.ledvance.com



VIVARES YOUTUBE CHANNEL

Our YouTube channel is packed with product training videos, commissioning instructions and more. Check them out at:



VIVARES Zigbee:
[ledvance.com/zigbeevideos](https://www.ledvance.com/zigbeevideos)



VIVARES DALI:
[ledvance.com/dalivideos](https://www.ledvance.com/dalivideos)

GOOD LIGHT ALL ROUND THE FULL LEDVANCE RANGE

LEDVANCE is leading the fight against bad light in every area. That's good news for you because when it comes to future-proof solutions relating to luminaires and lamps, HCL systems, electronic components, light management and smart residential products, you have a competent partner in LEDVANCE on your side for your complex lighting projects. You can always rely on LEDVANCE for excellent brand quality, professional service and a good price/performance ratio.



AESTHETICALLY FUNCTIONAL LUMINAIRES

The extensive luminaire portfolio covers virtually all professional and residential applications and delivers outstanding quality and functionality. The new BIOLUX HCL system is a winner of the VDE Quality Certificate, and the red dot 2020 Product Design and 2020 German Innovation Awards.

EACH LAMP A LIGHTING SOLUTION

The lamp portfolio includes a wide choice of shapes and base sizes as well as types with additional functions (e.g. sensors), all with outstanding efficiency and durability. Alongside UV-C and LED lamps, LEDVANCE will continue to offer conventional halogen, energy-saving, fluorescent and gas discharge lamps.

FLEXIBLE LED STRIP SYSTEM

The LED Strip System includes a large number of flexible LED strips, drivers and matching accessories. With a wide range of luminous fluxes and light colors, the system allows bespoke lighting solutions to be created for virtually any indoor or outdoor application. Easy to plan, easy to combine and easy to install – that's the principle here.

VIVARES: LIGHT MANAGEMENT, MORE COMFORTABLE THAN EVER

The future-proof IoT light management system (LMS) from LEDVANCE makes it easier and more flexible than ever to always produce optimal lighting conditions for defined requirements. The system is extremely reliable and compatible and offers all LMS components and matching LED luminaires from one source.

SMART LIGHTING FOR RESIDENTIAL APPLICATIONS

Our smart residential products offer a comprehensive combination of innovation, quality, reliability and user-friendliness. We provide a suitable solution for a variety of requirements that intelligent lighting has to meet.

MORE INFORMATION AND CLEVER TOOLS

For more information on LEDVANCE's extensive product portfolio and clever apps and tools that will help you in your day-to-day work go to www.ledvance.com

SHEDDING LIGHT, SYMBOLS AND ABBREVIATIONS

 IP	Type of protection	 I _{IN}	Nominal input current	 €	Recommended retail price
 IP 20 IP 40	Type of protection, back/front	 No. of OUTPUTS	Number of controllable devices	 No.	Fig. no.
 IK	IK impact rating	 Hz	Mains frequency	 SCALE DESIGN	Scale design
 CRI	Color rendering index	 T _a	Ambient temperature range		Protection class I
 SDCM ≤3	MacAdam color consistency	 V _{IN}	Nominal input voltage		Protection class II
	Dimmable		Detection area		DALI-2 technology
 lm	Luminous flux in lm		Type of installation		zigbee Zigbee 3.0 technology
 W	Power in W	 UGR	Unified Glare Rating		
 K	Color temperature in K	 FLICKER VALUE	Flicker Value		
 lm/W	Luminous efficacy	 L _x	Operating range, light sensor		
	Guarantee		Maximum installation height		
	Detection angle	 L70	t [h]: L70/B50 @ 25 °C (T _a)		
	Ceiling opening	 L80	t [h]: L80/B10 @ 25 °C (T _a)		
	Replacement wattage and type		Beam angle in °		
 MATERIAL	Cover material		Weight		
 COLOR	Product color		Unit of packaging		

LIST OF ABBREVIATIONS

CONV	Converter
D	Direct
DALI	DALI-2 technology
D/I	Direct/Indirect
DL	Downlight
DN	Diameter Nominal
EM	Emergency
INDV	IndiviLED
LI	Luminaire integration
LN	Linear
L/O	Light and occupancy
O	Occupancy
PL	Panel
PFM	Performance
SENS	Sensor
UGR	Unified Glare Rating
VAL	Value
WT	White
ZB	Zigbee 3.0 technology

ABOUT LEDVANCE



LEDVANCE

With offices in more than 50 countries and business activities in more than 140 countries, LEDVANCE is one of the world's leading general lighting providers for professional users and end consumers. Having emerged from OSRAM's general lighting division, LEDVANCE offers a wide-ranging portfolio of LED luminaires for a broad spectrum of applications, intelligent lighting products for Smart Home and Smart Building solutions, one of the most comprehensive ranges of advanced LED lamps in the lighting industry, traditional light sources, an LED Strip System and light management systems.

LEDVANCE GmbH
Parkring 29–33
85748 Garching
Germany
LEDVANCE.COM

Partner:



LEDVANCE.COM