



Solutions for shipbuilding and off-shore construction

Safe systems for special requirements in electrical
installations

OBO
BETTERMANN

43

kilometres
cable ladder systems

2,700
passengers

14
decks

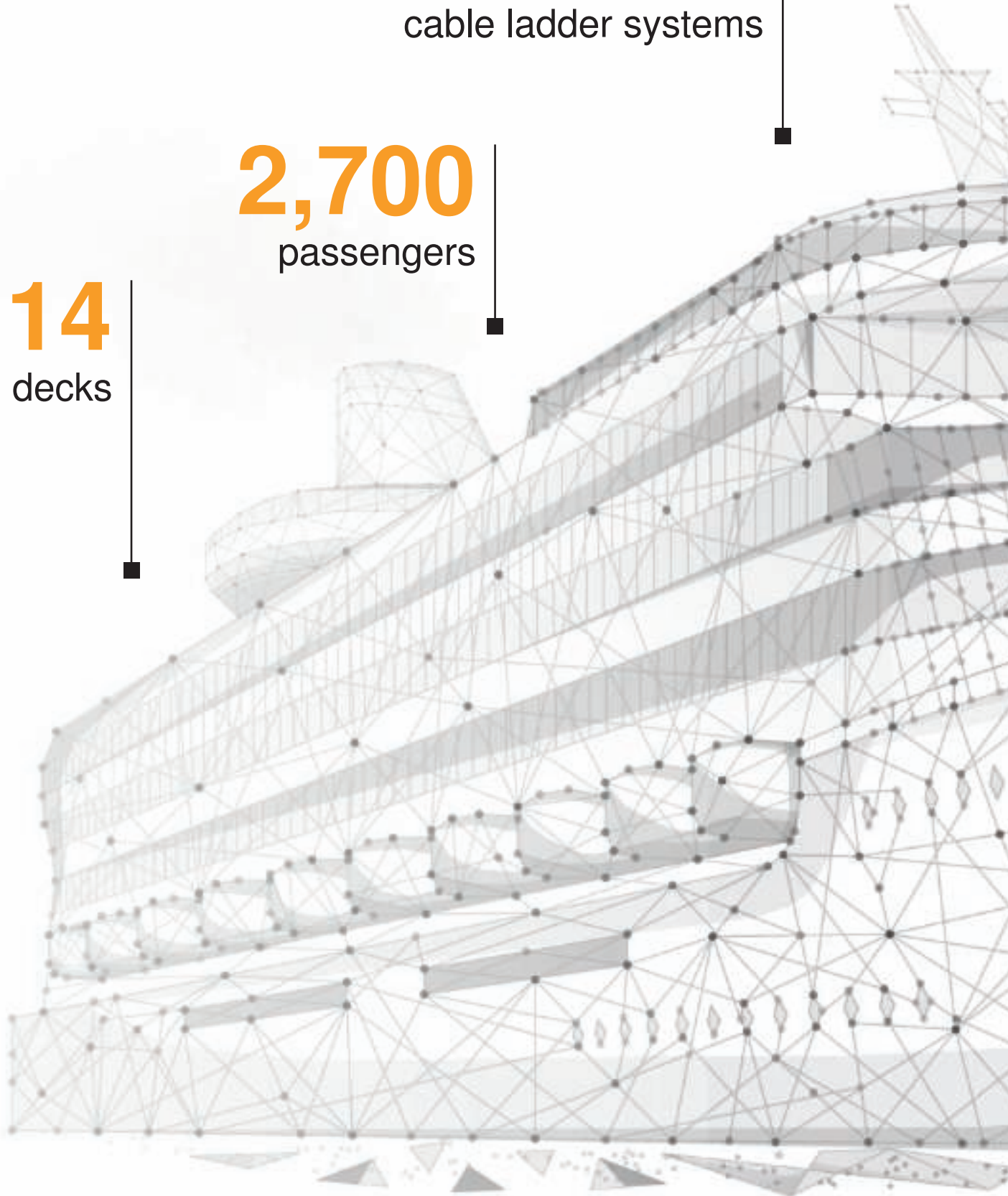



14
kilometres
cable tray systems

300
metres
long

Strong product range, first-class quality

Systems installed on ships and offshore constructions must often fulfil special requirements – something which particularly applies to electrical installations. The comprehensive range of OBO products, quality-tested according to ISO 9001, offers safe solutions for all kinds of requirements. All the marine cable trays and cable ladders for shipbuilding meet the requirements of DIN EN 61537 "Cable management – Cable tray systems and cable ladder systems" and take the construction specifications of Germanischer Lloyd and the IEC into account. In addition, the OBO cable ladders are certified by DNV-GL and RINA. For insulation areas, OBO can offer a system with an A60 fire resistance class, whose excellent properties have been certified by Germanischer Lloyd.



Cable tray systems
See page 8

Mounting systems

See page 56

Tightening straps

See page 66

Cable ladder systems

See page 18

Shipbuilding cable tray systems

FS

FT

A2

A4

Alu

High-quality materials

The OBO cable trays meet the highest requirements in shipbuilding, because we use particularly high-quality materials: Whether stainless steel or aluminium, electrogalvanised or hot-dip galvanised – all the components are always perfectly manufactured.

Coherent system accessories

Spring chucks and tightening straps are available for simple installation and the latter are available in rolls or fixed lengths.

FS

FT

A2

A4

Alu

Cable tray MKR...

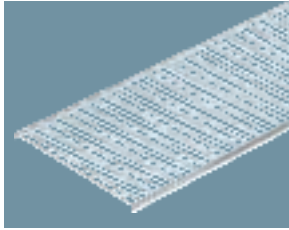

Nominal width mm	Metal thickness mm	FS Strip galvanised	FT Hot-dip galvanised	A2 Stainless steel	A4 Stainless steel	Alu Aluminium
50	1.3	●	*	*	*	*
75	1.3	●	*	*	*	*
100	1.3	●	*	*	*	*
150	1.3	●	*	*	*	*
200	1.3	●	*	*	*	*
300	1.3	●	*	*	*	*
50	1.25	●	●	●	●	●
75	1.25	●	●	●	●	●
100	1.25	●	●	●	●	●
125	1.25	●	●	●	●	●
150	1.25	●	●	●	●	●
200	1.25	●	●	●	●	●
250	1.25	●	●	●	●	●
300	1.25	●	●	●	●	●

*On request

Straight connector MKR SV...



Nominal width mm	Metal thickness mm	FS Strip galvanised	FT Hot-dip galvanised	A2 Stainless steel	A4 Stainless steel	Alu Aluminium
		●	●	●	●	●

90° bend MKRB 90...

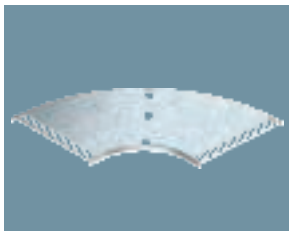

Nominal width mm	Metal thickness mm	FS Strip galvanised	FT Hot-dip galvanised	A2 Stainless steel	A4 Stainless steel	Alu Aluminium
50	1.25	●	●	*	*	*
75	1.25	●	●	*	*	*
100	1.25	●	●	*	*	*
125	1.25	●	●	*	*	*
150	1.50	●	●	*	*	*
200	1.50	●	●	*	*	*
250	1.50	●	●	*	*	*
300	1.50	●	●	*	*	*

*On request

Cable tray, marine standard MKR 15

St Steel
FS Strip galvanised

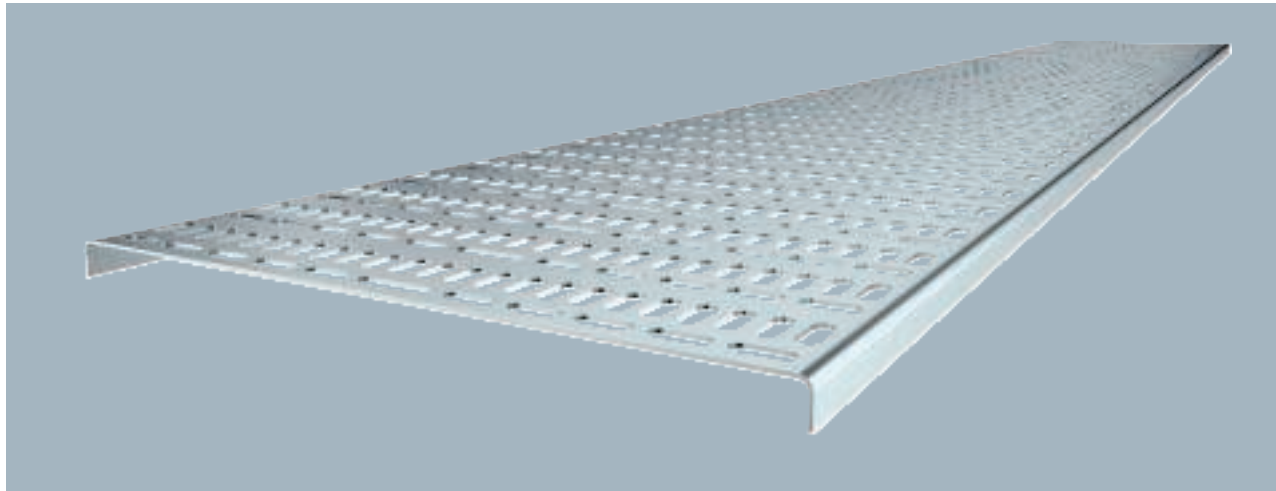

Type	Width mm	Metal thickness mm	Pack m	Weight kg/100 m	Item no.
MKR 15 050 FS	50	1.00	2	49.400	6045952
MKR 15 075 FS	75	1.00	2	63.700	6045960
MKR 15 100 FS	100	1.00	2	75.850	6045979
MKR 15 150 FS	150	1.00	2	102.800	6045995
MKR 15 200 FS	200	1.00	2	129.850	6046002

Cable tray for use in ship construction, produced according to the marine standard VG 88900-1.

0460 price/m

Type	Length mm	Dimension B mm	Side height mm
MKR 15 050 FS	2000	50	15
MKR 15 075 FS	2000	75	15
MKR 15 100 FS	2000	100	15
MKR 15 150 FS	2000	150	15
MKR 15 200 FS	2000	200	15

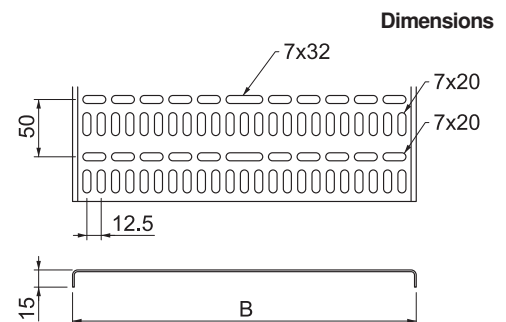

Screw connector 15

St Steel
FS Strip galvanised

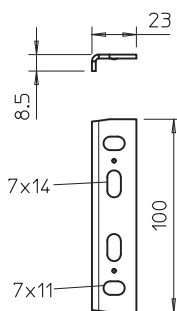

Type	Pack Piece	Weight kg/100 pc.	Item no.
MKR SV FS	25	5.713	6066242

0460 /pc.

Straight connector for straight connection of cable trays, according to the marine standard, with a side height of 15 mm.

Cable tray, marine standard MKR 15

- St** Steel
- FS** Strip galvanised
- FT** Hot-dip galvanised

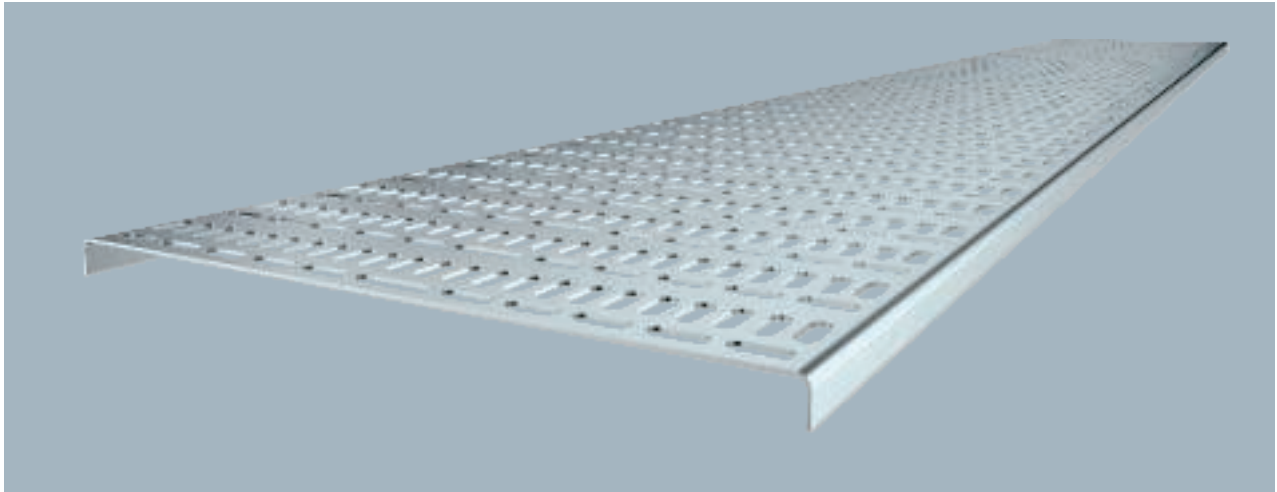

Cable tray for use in ship construction, produced according to the marine standard VG 88900-1.

Type	Width mm	Metal thickness mm	Pack m	Weight kg/100 m	Item no.
MKR 15 050 FS	50	1.25	2	61.500	6046370
MKR 15 075 FS	75	1.25	2	78.500	6046372
MKR 15 100 FS	100	1.25	2	94.650	6046374
MKR 15 125 FS	125	1.25	2	113.400	6046375
MKR 15 150 FS	150	1.50	2	154.100	6046376
MKR 15 200 FS	200	1.50	2	194.700	6046004
MKR 15 250 FS	250	1.50	2	235.250	6046379
MKR 15 300 FS	300	1.50	2	275.850	6046029
MKR 15 050 FT	50	1.25	2	66.750	6045057
MKR 15 075 FT	75	1.25	2	85.950	6045073
MKR 15 100 FT	100	1.25	2	102.200	6045103
MKR 15 125 FT	125	1.25	2	122.450	6045138
MKR 15 150 FT	150	1.50	2	164.350	6045154
MKR 15 200 FT	200	1.50	2	207.600	6045200
MKR 15 250 FT	250	1.50	2	250.900	6045251
MKR 15 300 FT	300	1.50	2	294.150	6045308

0460 price/m

Dimensions

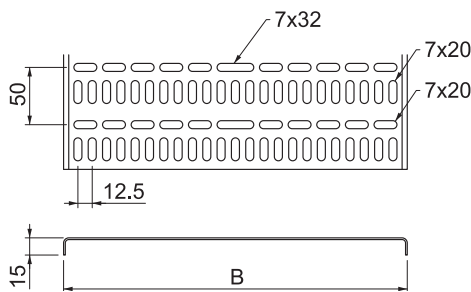

Type	Length mm	Dimen- sion B mm	Side height mm
MKR 15 050 FS	2000	50	15
MKR 15 075 FS	2000	75	15
MKR 15 100 FS	2000	100	15
MKR 15 125 FS	2000	125	15
MKR 15 150 FS	2000	150	15
MKR 15 200 FS	2000	200	15
MKR 15 250 FS	2000	250	15
MKR 15 300 FS	2000	300	15

Screw connector 15

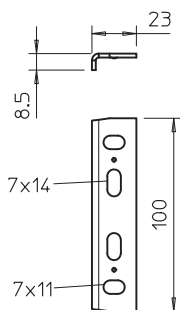

- St** Steel
- FS** Strip galvanised
- FT** Hot-dip galvanised

Type	Pack Piece	Weight kg/100 pc.	Item no.
MKR SV FS	25	5.713	6066242
MKR SV FT	25	5.888	6066240

0460 /pc.

Straight connector for straight connection of cable trays, according to the marine standard, with a side height of 15 mm.

Clamp connector 15

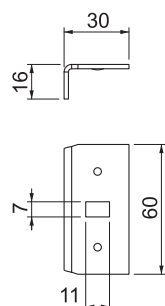

- St** Steel
- FT** Hot-dip galvanised

Type	Pack Piece	Weight kg/100 pc.	Item no.
MKR KV FT	25	8.500	6066143

0460 /pc.

Clamp connector for straight connection of cable trays, according to the marine standard, with a side height of 15 mm.

90° bend 15, shipbuilding

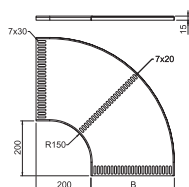

- St** Steel
- FS** Strip galvanised
- FT** Hot-dip galvanised

Type	Width mm	Metal thickness mm	Pack Piece	Weight kg/100 pc.	Item no.
MKRB 90 15 050FS	51	1.25	1	14.600	7061146
MKRB 90 15 075FS	76	1.25	1	22.500	7061050
MKRB 90 15 100FS	101	1.25	1	28.400	7061244
MKRB 90 15 125FS	126	1.25	1	56.500	7061252
MKRB 90 15 150FS	151	1.50	1	73.300	7061360
MKRB 90 15 200FS	201	1.50	1	102.400	7061449
MKRB 90 15 250FS	252	1.50	1	163.800	7061546
MKRB 90 15 300FS	302	1.50	1	206.000	7061643
MKRB 90 15 050FT	51	1.25	1	16.000	7061145
MKRB 90 15 075FT	76	1.25	1	23.500	7061048
MKRB 90 15 100FT	101	1.25	1	31.090	7061242
MKRB 90 15 125FT	125	1.25	1	61.000	7061250
MKRB 90 15 150FT	151	1.50	1	79.210	7061358
MKRB 90 15 200FT	201	1.50	1	110.600	7061447
MKRB 90 15 250FT	252	1.50	1	176.900	7061544
MKRB 90 15 300FT	302	1.50	1	222.480	7061641

0460 /pc.

90° horizontal bend, for all ship construction cable tray types, produced according to the marine standard VG 88900-2.

Corner connector 15

St Steel
FT Hot-dip galvanised

Type	Pack Piece	Weight kg/100 pc.	Item no.
MKR EV FT	1	9.330	7060041

0460 /pc.

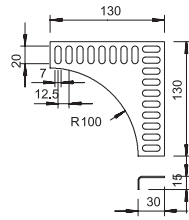

Corner connector for all cable trays according to the marine standard with side height of 15 mm.

St Steel
F Hot galvanised

Truss-head bolt with flange nut

Type	Dimension mm	Dimension L mm	Dimension d mm	Dimension D mm	Resistance grade	Pack Piece	Weight kg/100 pc.	Item no.
FRSB 6x12 F	M6x12	12	6	13.5	5.6	100	0.812	6406122

0415 /100 pc.

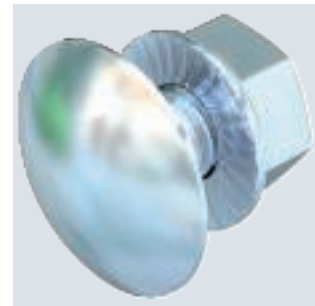
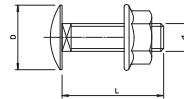

Truss-head bolt with square neck including flange nut.

Cable tray, marine standard MKR 15

- VA Stainless steel, rustproof 1.4301
- VA Stainless steel, rustproof 1.4571
- 2B Bright, reworked

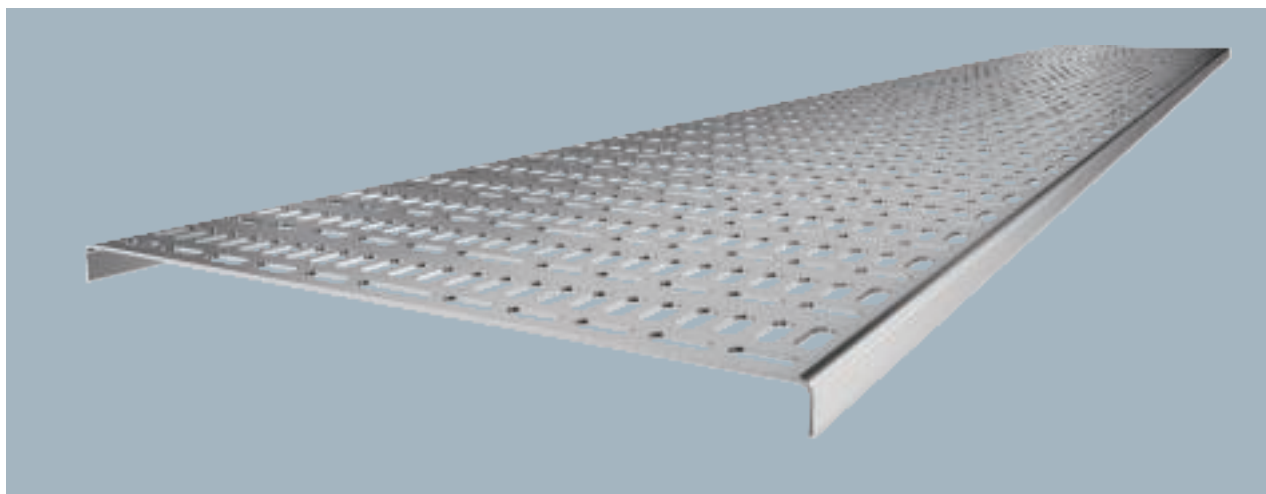

Type	Width mm	Metal thickness mm	Pack m	Weight kg/100 m	Item no.
MKR 15 050 A2	50	1.25	2	61.850	6045830
MKR 15 075 A2	75	1.25	2	79.600	6045832
MKR 15 100 A2	100	1.25	2	94.650	6045834
MKR 15 125 A2	125	1.25	2	113.400	6045836
MKR 15 150 A2	150	1.50	2	154.100	6045838
MKR 15 200 A2	200	1.50	2	194.700	6045840
MKR 15 250 A2	250	1.50	2	235.250	6045842
MKR 15 300 A2	300	1.50	2	275.850	6045844
MKR 15 050 A4	50	1.00	2	49.400	6045850
MKR 15 075 A4	75	1.00	2	63.700	6045852
MKR 15 100 A4	100	1.00	2	75.850	6045854
MKR 15 125 A4	125	1.00	2	90.700	6045856
MKR 15 150 A4	150	1.50	2	154.100	6045858
MKR 15 200 A4	200	1.50	2	194.700	6045860
MKR 15 250 A4	250	1.50	2	235.250	6045862
MKR 15 300 A4	300	1.50	2	275.850	6045864

Cable tray for use in ship construction, produced according to the marine standard VG 88900-1.

0460 price/m

Type	Length mm	Dimension B mm	Side height mm
MKR 15 050 A2	2000	50	15
MKR 15 075 A2	2000	75	15
MKR 15 100 A2	2000	100	15
MKR 15 125 A2	2000	125	15
MKR 15 150 A2	2000	150	15
MKR 15 200 A2	2000	200	15
MKR 15 250 A2	2000	250	15
MKR 15 300 A2	2000	300	15

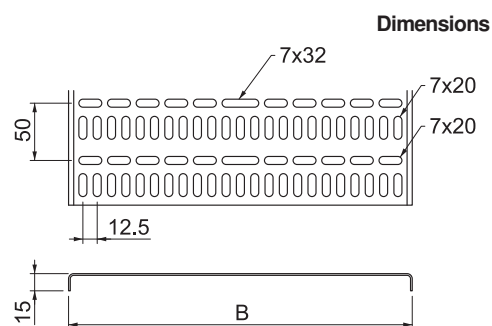

Screw connector 15

VA Stainless steel, rustproof 1.4301

VA Stainless steel, rustproof 1.4571

2B Bright, reworked

Type	Pack Piece	Weight kg/100 pc.	Item no.
MKR SV A2	25	5.485	6066244
MKR SV A4	25	5.485	6066246

0460 /pc.

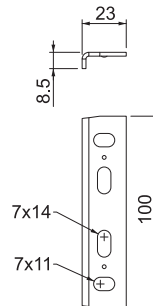

Straight connector for straight connection of cable trays, according to the marine standard, and fittings with a side height of 15 mm.

Cable tray, marine standard MKR 15

Alu Aluminium

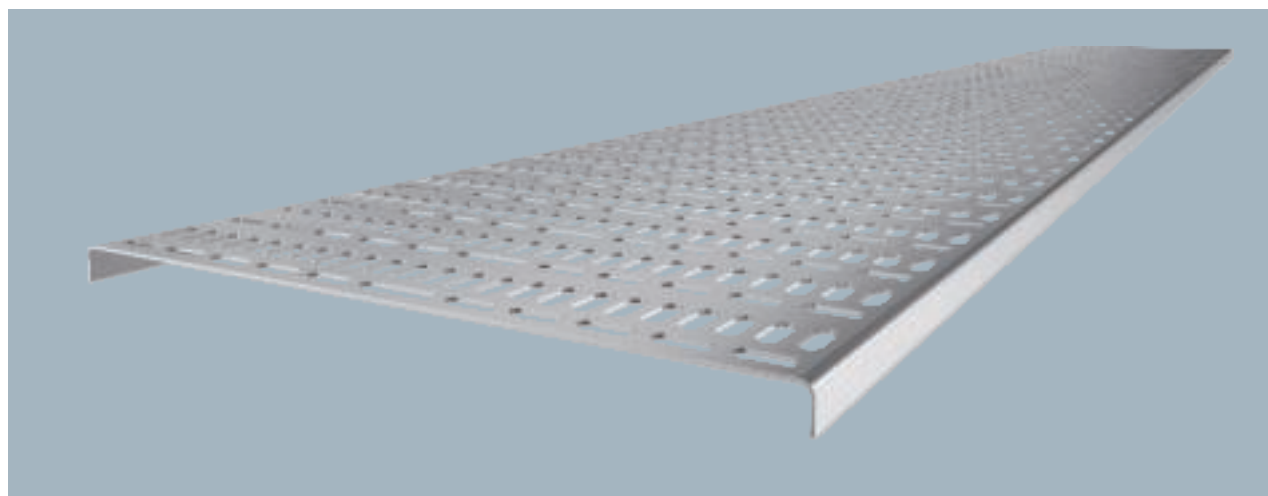

Type	Width mm	Metal thickness mm	Pack m	Weight kg/100 m	Item no.
MKR 15 050 ALU	50	1.50	2	25.500	6045707
MKR 15 075 ALU	75	1.50	2	32.850	6045715
MKR 15 100 ALU	100	1.50	2	39.050	6045723
MKR 15 125 ALU	125	1.50	2	46.850	6045731
MKR 15 150 ALU	150	1.50	2	53.000	6045758
MKR 15 200 ALU	200	2.00	2	89.300	6045766
MKR 15 250 ALU	250	2.00	2	107.900	6045774
MKR 15 300 ALU	300	2.00	2	126.500	6045782

Cable tray for use in ship construction, produced according to the marine standard VG 88900-1.

0460 price/m

Type	Length mm	Dimension B mm	Side height mm
MKR 15 050 ALU	2000	50	15
MKR 15 075 ALU	2000	75	15
MKR 15 100 ALU	2000	100	15
MKR 15 125 ALU	2000	125	15
MKR 15 150 ALU	2000	150	15
MKR 15 200 ALU	2000	200	15
MKR 15 250 ALU	2000	250	15
MKR 15 300 ALU	2000	300	15

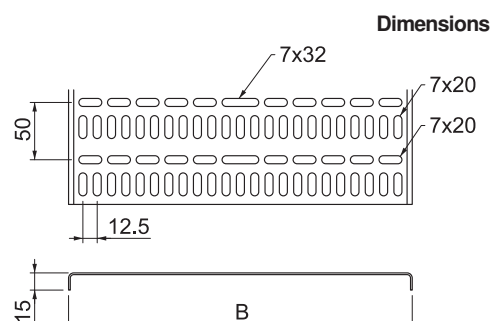

Alu Aluminium

Screw connector 15

Type	Pack Piece	Weight kg/100 pc.	Item no.
MKR SV ALU	25	2.910	6066248

0460 /pc.

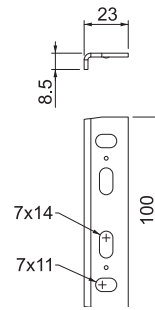

Straight connector for straight connection of cable trays, according to the marine standard, and fittings with a side height of 15 mm.

Cable ladder systems

SG

FT

A2

A4

Alu

Perfectly manufactured

OBO cable ladders have high-quality galvanisation and are particularly light, as weight is saved through the burr-free, perforated side rails. Through the certified SIGMA-WELD 199 welding primer and the precise welding seams, we can achieve an extremely high resistance to corrosion. Our cable ladders are available with two different rungs: In trapezoidal or Z shape for double-sided assignment. A continuous connection is also possible if the cable ladders have to be shortened.

Materials for the highest requirements

Just like our cable trays, the OBO cable ladders are only produced from the highest-quality materials. Made from stainless steel or aluminium, with electro or hot-dip galvanisation, they are given a welding primer and are welded precisely.

Coherent system accessories

Spring chucks and tightening straps are available on rolls or in fixed lengths for simple installation. In addition, matching construction and suspension profiles are available for all the cable ladders.

SG

FT

A2

A4

Alu

Cable ladder with trapezoidal rung, light duty, SL 42...

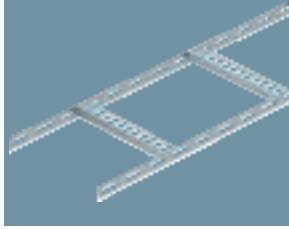

Nominal width mm	SG Welding primed	FT Hot-dip galvanised	A2 Stainless steel	A4 Stainless steel	Alu Aluminium
100	●	●	●	●	●
200	●	●	●	●	●
300	●	●	●	●	●
400	●	●	●	●	●
500	●	●	●	●	●
600	●	●	●	●	●

Cable ladder with trapezoidal rung, standard, SL 62...

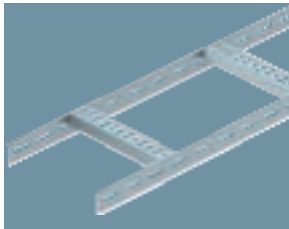

Nominal width mm	SG Welding primed	FT Hot-dip galvanised	A2 Stainless steel	A4 Stainless steel	Alu Aluminium
100	●	●	●	●	●
200	●	●	●	●	●
300	●	●	●	●	●
400	●	●	●	●	●
500	●	●	●	●	●
600	●	●	●	●	●

Cable ladder with Z rung, light duty, SLZ L...

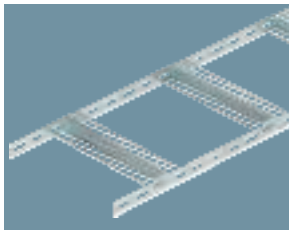

Nominal width mm	SG Welding primed	FT Hot-dip galvanised	A2 Stainless steel	A4 Stainless steel	Alu Aluminium
100	●	●	●	●	*
200	●	●	●	●	*
300	●	●	●	●	*
400	●	●	●	●	*
500	●	●	●	●	*
600	●	●	●	●	*

*On request

Cable ladder with Z rung, standard, SLZ...

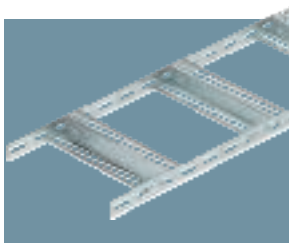

Nominal width mm	SG Welding primed	FT Hot-dip galvanised	A2 Stainless steel	A4 Stainless steel	Alu Aluminium
100	●	●	●	●	●
200	●	●	●	●	●
300	●	●	●	●	●
400	●	●	●	●	●
500	●	●	●	●	●
600	●	●	●	●	●
700	*	*	*	*	*
800	*	*	*	*	*
900	*	*	*	*	*
1440	*	*	*	*	*
1200	*	*	*	*	*

*On request

Cable ladder with trapezoidal rung, 25

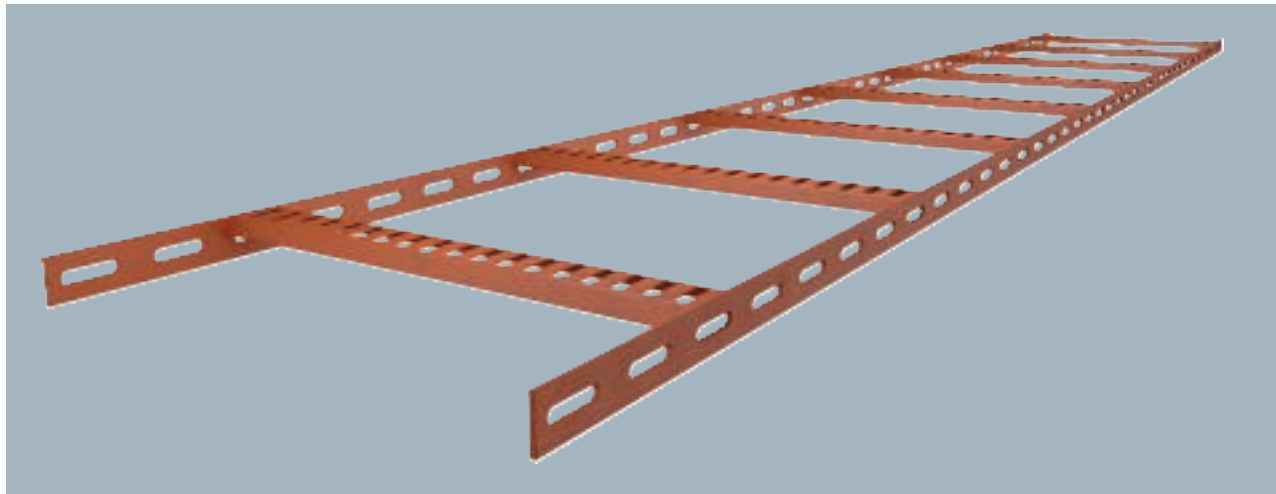

Type	Width mm	Rail thickness mm	Pack m	Weight kg/100 m	Item no.
SL 42 075 SG	75	3	2	109.000	7097026
SL 42 100 SG	100	3	2	112.500	7097034
SL 42 150 SG	150	3	2	119.000	7097042
SL 42 200 SG	200	3	2	125.500	7097050
SL 42 250 SG	250	3	2	132.000	7097069
SL 42 300 SG	300	3	2	139.000	7097077

Shipbuilding cable ladder with perforated side rail of side height 25 mm with welded, perforated trapezoidal rungs which open in a downwards direction. Load tested according to IEC in conjunction with connector, type SLV. Welding primer type SIGMA-WELD 199.

0460 price/m

Type	Length mm	Dimension B mm	Side height mm	Rail thickness mm
SL 42 075 SG	2000	81	25	3
SL 42 100 SG	2000	106	25	3
SL 42 150 SG	2000	156	25	3
SL 42 200 SG	2000	206	25	3
SL 42 250 SG	2000	256	25	3
SL 42 300 SG	2000	306	25	3

Dimensions

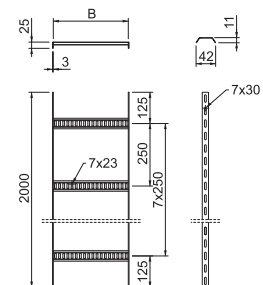

Type	1.5 m kN/m	2.0 m kN/m
SL 42 075 SG	0.5	0.36
SL 42 100 SG	0.5	0.36
SL 42 150 SG	0.5	0.36
SL 42 200 SG	0.5	0.36
SL 42 250 SG	0.5	0.36
SL 42 300 SG	0.5	0.36

Load

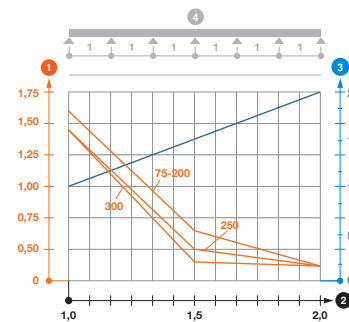

Load diagram, SL42 cable ladder

- 1 Permitted cable tray/ladder load in kN/m without man load
- 2 Support width in m
- 3 Rail bend in mm at permitted kN/m
- Load curve with cable tray/ladder width in mm
- Strut bend curve according to support width
- 4 Load scheme during testing

St Steel
SG Welding primed

90° bend with trapezoidal rung, 25

Type	Width mm	Rail thickness mm	Pack Piece	Weight kg/100 pc.	Item no.
SLB 90 42 075 SG	75	3	1	70.600	7098500
SLB 90 42 100 SG	100	3	1	75.800	7098502
SLB 90 42 150 SG	150	3	1	85.400	7098510
SLB 90 42 200 SG	200	3	1	95.000	7098529
SLB 90 42 250 SG	250	3	1	104.600	7098537
SLB 90 42 300 SG	300	3	1	114.300	7098545

0460 /pc.

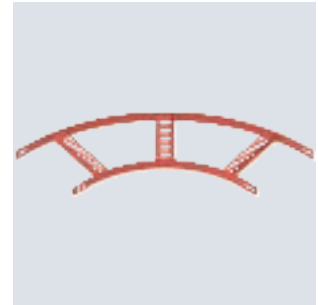
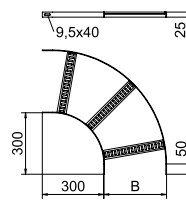

Connectors should be ordered separately and in the appropriate quantity.

Cable ladder with trapezoidal rung, 25

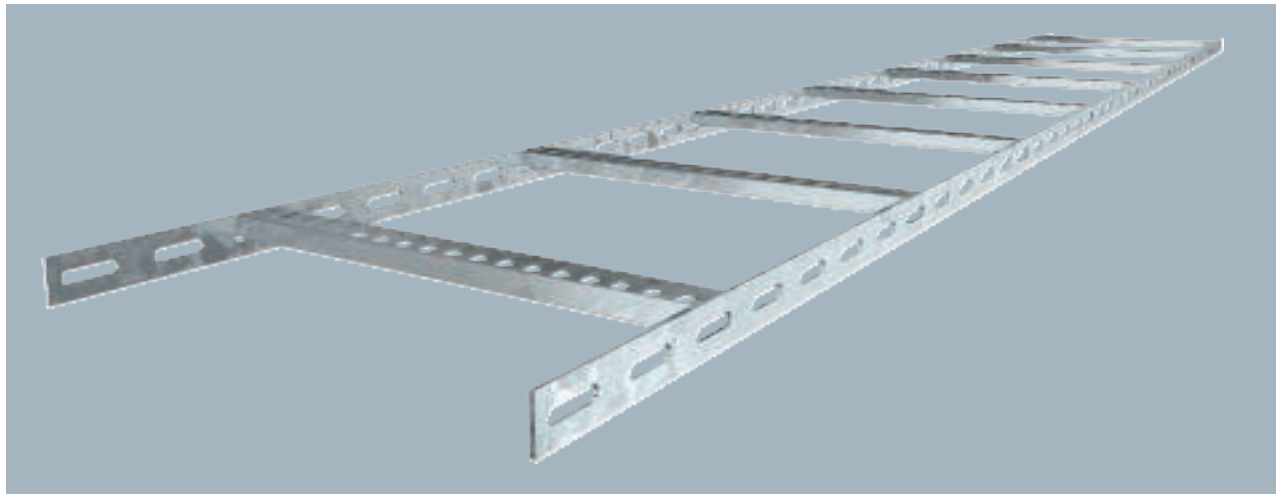
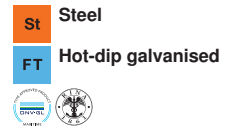

Type	Width mm	Rail thickness mm	Pack m	Weight kg/100 m	Item no.
SL 42 075 FT	75	3	2	114.000	7097115
SL 42 100 FT	100	3	2	118.000	7097123
SL 42 150 FT	150	3	2	125.000	7097131
SL 42 200 FT	200	3	2	132.500	7097158
SL 42 250 FT	250	3	2	140.000	7097166
SL 42 300 FT	300	3	2	147.500	7097174

Shipbuilding cable ladder with perforated side rail of side height 25 mm with welded, perforated trapezoidal rungs which open in a downwards direction. Load tested according to IEC in conjunction with connector, type SLV.

0460 price/m

	Length mm	Dimension B mm	Side height mm	Rail thickness mm
SL 42 075 FT	2000	81	25	3
SL 42 100 FT	2000	106	25	3
SL 42 150 FT	2000	156	25	3
SL 42 200 FT	2000	206	25	3
SL 42 250 FT	2000	256	25	3
SL 42 300 FT	2000	306	25	3

Dimensions

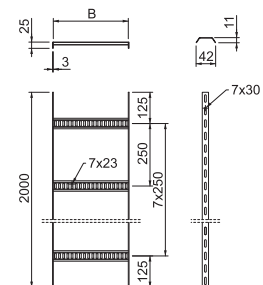

	1.5 m kN/m	2.0 m kN/m
SL 42 075 FT	0.5	0.36
SL 42 100 FT	0.5	0.36
SL 42 150 FT	0.5	0.36
SL 42 200 FT	0.5	0.36
SL 42 250 FT	0.5	0.36
SL 42 300 FT	0.5	0.36

Load

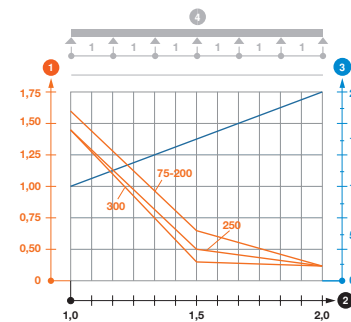

Load diagram, SL42 cable ladder

- 1 Permitted cable tray/ladder load in kN/m without man load
- 2 Support width in m
- 3 Rail bend in mm at permitted kN/m
- Load curve with cable tray/ladder width in mm
- Strut bend curve according to support width
- 4 Load scheme during testing

St Steel
FT Hot-dip galvanised

Connector 25

Type	Pack Piece	Weight kg/100 pc.	Item no.
SLV 42 FT	20	11.900	7103540

0460 /pc.

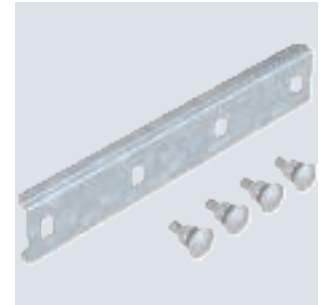
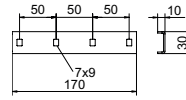

Straight connector to connect cable ladders and fittings with a side height of 25 mm.

St Steel
FT Hot-dip galvanised

90° bend with trapezoidal rung, 25

Type	Width mm	Rail thickness mm	Pack Piece	Weight kg/100 pc.	Item no.
SLB 90 42 075 FT	75	3	1	73.800	7098614
SLB 90 42 100 FT	100	3	1	80.000	7098618
SLB 90 42 150 FT	150	3	1	88.900	7098626
SLB 90 42 200 FT	200	3	1	99.000	7098634
SLB 90 42 250 FT	250	3	1	108.900	7098642
SLB 90 42 300 FT	300	3	1	122.000	7098650

0460 /pc.

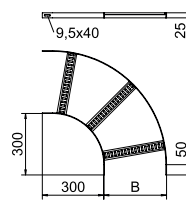

Connectors should be ordered separately and in the appropriate quantity.

Cable ladder with trapezoidal rung, 25

VA Stainless steel, rustproof 1.4301

2B Bright, reworked

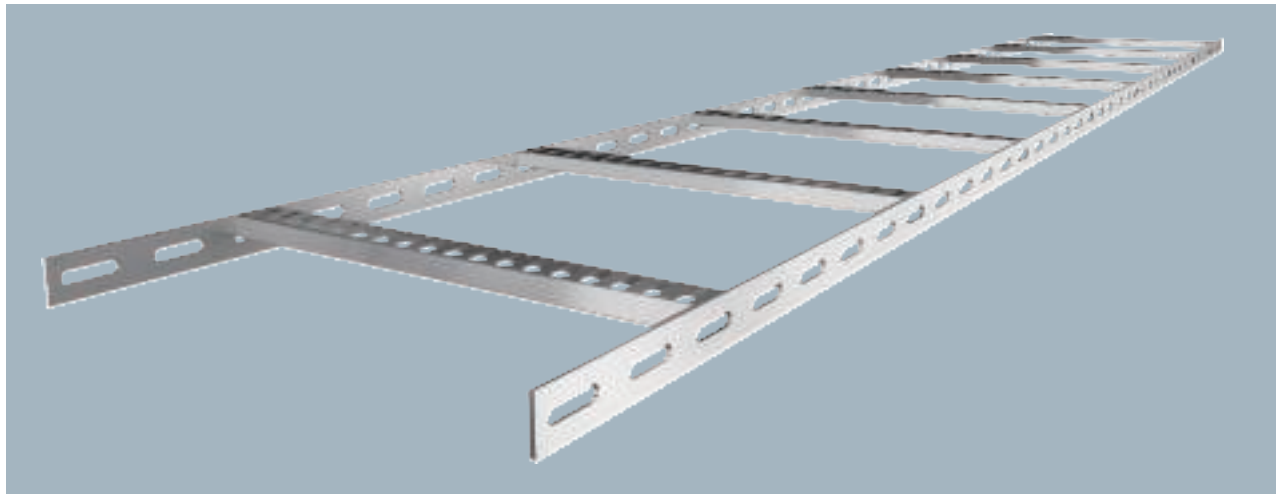

Type	Width mm	Rail thickness mm	Pack m	Weight kg/100 m	Item no.
SL 42 075 A2	75	3	2	109.000	7097080
SL 42 100 A2	100	3	2	112.500	7097082
SL 42 150 A2	150	3	2	119.000	7097084
SL 42 200 A2	200	3	2	125.500	7097086
SL 42 250 A2	250	3	2	132.000	7097088
SL 42 300 A2	300	3	2	139.000	7097090

0460 price/m

Shipbuilding cable ladder with perforated side rail of side height 25 mm with welded, perforated trapezoidal rungs which open in a downwards direction. Load tested according to IEC in conjunction with connector, type SLV.

Type	Length mm	Dimension B mm	Side height mm	Rail thickness mm
SL 42 075 A2	2000	81	25	3
SL 42 100 A2	2000	106	25	3
SL 42 150 A2	2000	156	25	3
SL 42 200 A2	2000	206	25	3
SL 42 250 A2	2000	256	25	3
SL 42 300 A2	2000	306	25	3

Dimensions

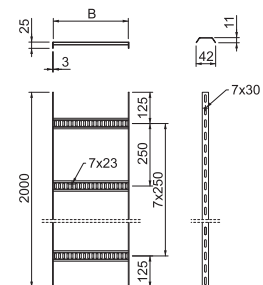

Type	1.0 m kN/m	1.5 m kN/m	2.0 m kN/m
SL 42 075 A2	1.6	0.65	0.25
SL 42 100 A2	1.6	0.65	0.25
SL 42 150 A2	1.6	0.65	0.25
SL 42 200 A2	1.6	0.65	0.25
SL 42 250 A2	1.45	0.65	0.25
SL 42 300 A2	1.45	0.65	0.25

Load

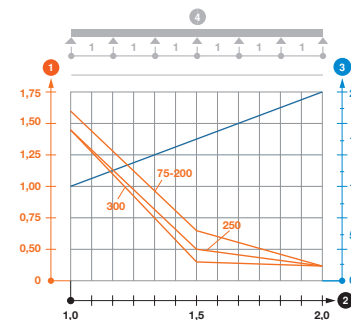

Load diagram, SL42 cable ladder

- 1 Permitted cable tray/ladder load in kN/m without man load
- 2 Support width in m
- 3 Rail bend in mm at permitted kN/m
- Load curve with cable tray/ladder width in mm
- Strut bend curve according to support width
- 4 Load scheme during testing

VA Stainless steel, rustproof 1.4571

2B Bright, reworked

Connector 25

Type	Pack Piece	Weight kg/100 pc.	Item no.
SLV 42 A4	20	11.300	7103560

0460 /pc.

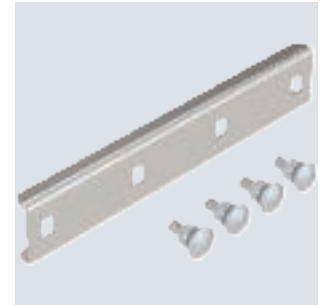
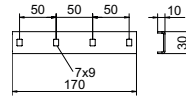

Straight connector to connect cable ladders and fittings with a side height of 25 mm.

VA Stainless steel, rustproof 1.4301

2B Bright, reworked

90° bend with trapezoidal rung, 25

Type	Width mm	Rail thickness mm	Pack Piece	Weight kg/100 pc.	Item no.
SLB 90 42 075 A2	75	3	1	71.600	7098654
SLB 90 42 100 A2	100	3	1	76.400	7098656
SLB 90 42 150 A2	150	3	1	85.800	7098658
SLB 90 42 200 A2	200	3	1	95.400	7098660
SLB 90 42 250 A2	250	3	1	105.000	7098662
SLB 90 42 300 A2	300	3	1	114.300	7098664

0460 /pc.

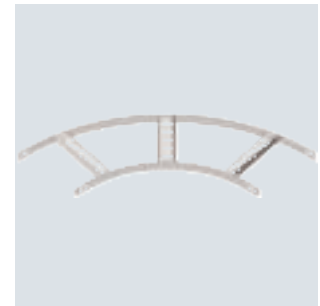
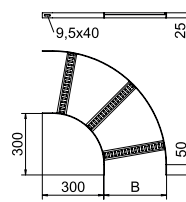

Connectors should be ordered separately and in the appropriate quantity.

Cable ladder with trapezoidal rung, 25

VA Stainless steel, rustproof 1.4571

2B Bright, reworked

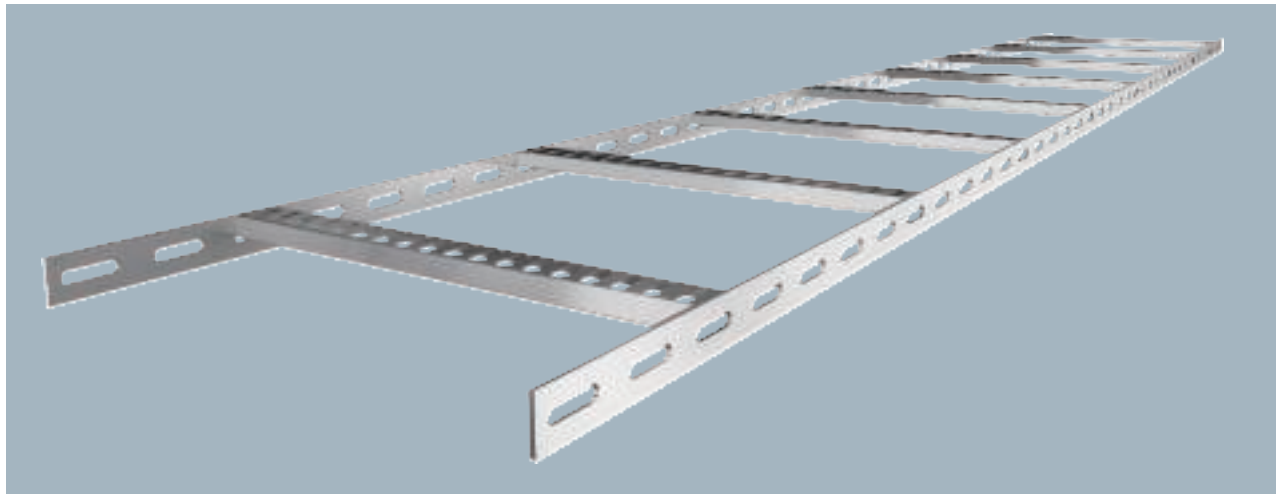

Type	Width mm	Rail thickness mm	Pack m	Weight kg/100 m	Item no.
SL 42 075 A4	75	3	2	110.850	7099702
SL 42 100 A4	100	3	2	114.500	7099704
SL 42 150 A4	150	3	2	120.900	7099706
SL 42 200 A4	200	3	2	127.600	7099708
SL 42 250 A4	250	3	2	134.300	7099710
SL 42 300 A4	300	3	2	140.800	7099712

Shipbuilding cable ladder with perforated side rail of side height 25 mm with welded, perforated trapezoidal rungs which open in a downwards direction. Load tested according to IEC in conjunction with connector, type SLV.

0460 price/m

Type	Length mm	Dimension B mm	Side height mm	Rail thickness mm
SL 42 075 A4	2000	81	25	3
SL 42 100 A4	2000	106	25	3
SL 42 150 A4	2000	156	25	3
SL 42 200 A4	2000	206	25	3
SL 42 250 A4	2000	256	25	3
SL 42 300 A4	2000	306	25	3

Dimensions

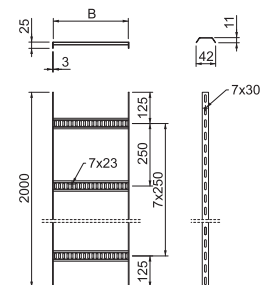

Type	1.0 m kN/m	1.5 m kN/m	2.0 m kN/m
SL 42 075 A4	1.6	0.65	0.25
SL 42 100 A4	1.6	0.65	0.25
SL 42 150 A4	1.6	0.65	0.25
SL 42 200 A4	1.6	0.65	0.25
SL 42 250 A4	1.45	0.65	0.25
SL 42 300 A4	1.45	0.65	0.25

Load

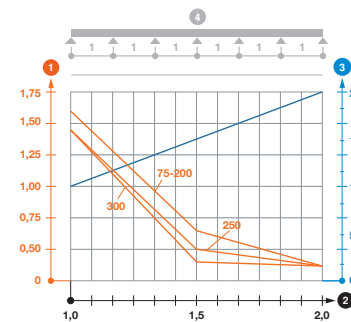

Load diagram, SL42 cable ladder

- 1 Permitted cable tray/ladder load in kN/m without man load
- 2 Support width in m
- 3 Rail bend in mm at permitted kN/m
- Load curve with cable tray/ladder width in mm
- Strut bend curve according to support width
- 4 Load scheme during testing

VA Stainless steel, rustproof 1.4571

2B Bright, reworked

Connector 25

Type	Pack Piece	Weight kg/100 pc.	Item no.
SLV 42 A4	20	11.300	7103560

0460 /pc.

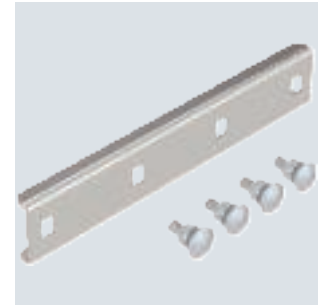
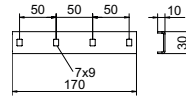

Straight connector to connect cable ladders and fittings with a side height of 25 mm.

VA Stainless steel, rustproof 1.4571

2B Bright, reworked

90° bend with trapezoidal rung, 25

Type	Width mm	Rail thickness mm	Pack Piece	Weight kg/100 pc.	Item no.
SLB 90 42 075 A4	75	3	1	71.600	7098670
SLB 90 42 100 A4	100	3	1	77.000	7098672
SLB 90 42 150 A4	150	3	1	87.000	7098674
SLB 90 42 200 A4	200	3	1	97.000	7098676
SLB 90 42 250 A4	250	3	1	107.000	7098678
SLB 90 42 300 A4	300	3	1	117.000	7098680

0460 /pc.

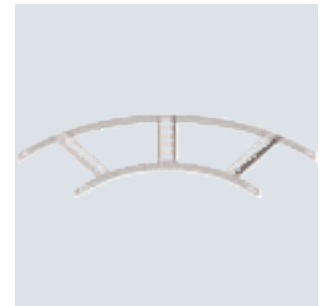
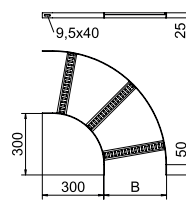

Connectors should be ordered separately and in the appropriate quantity.

Cable ladder with trapezoidal rung, 25

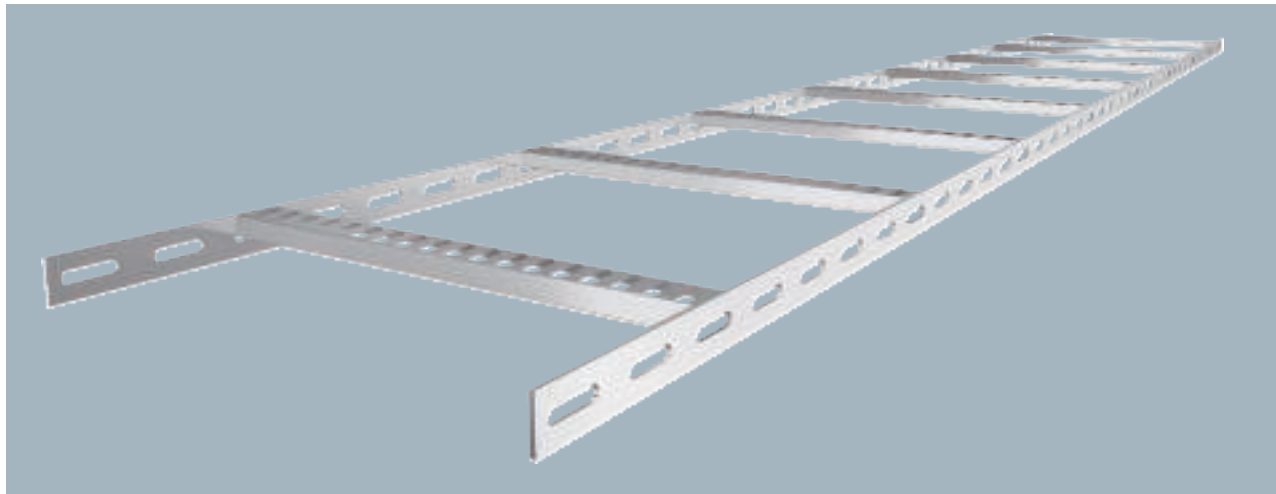

Type	Width mm	Rail thickness mm	Pack m	Weight kg/100 m	Item no.
SL 42 075 ALU	75	3	2	41.000	7099722
SL 42 100 ALU	100	3	2	43.000	7099724
SL 42 150 ALU	150	3	2	47.500	7099726
SL 42 200 ALU	200	3	2	52.500	7099728
SL 42 250 ALU	250	3	2	57.000	7099730
SL 42 300 ALU	300	3	2	61.500	7099732

Shipbuilding cable ladder with perforated side rail of side height 25 mm with welded, perforated trapezoidal rungs which open in a downwards direction.

0460 price/m

	Length mm	Dimen- sion B mm	Side height mm	Rail thickness mm
SL 42 075 ALU	2000	81	25	3
SL 42 100 ALU	2000	106	25	3
SL 42 150 ALU	2000	156	25	3
SL 42 200 ALU	2000	206	25	3
SL 42 250 ALU	2000	256	25	3
SL 42 300 ALU	2000	306	25	3

Dimensions

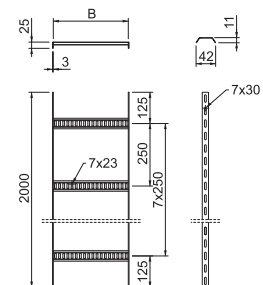

	1.0 m kN/m	1.5 m kN/m	2.0 m kN/m
SL 42 075 ALU	0.75	0.2	0.1
SL 42 100 ALU	0.75	0.2	0.1
SL 42 150 ALU	0.75	0.2	0.1
SL 42 200 ALU	0.75	0.2	0.1
SL 42 250 ALU	0.75	0.2	0.1
SL 42 300 ALU	0.75	0.2	0.1

Load

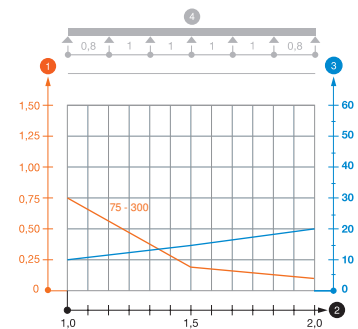

Load diagram, SL42 cable ladder

- 1 Permitted cable tray/ladder load in kN/m without man load
- 2 Support width in m
- 3 Rail bend in mm at permitted kN/m
- Load curve with cable tray/ladder width in mm
- Strut bend curve according to support width
- 4 Load scheme during testing

Alu Aluminium

Connector 25

Type	Pack Piece	Weight kg/100 pc.	Item no.
SLV 42 ALU	20	4.951	7103552

0460 /pc.

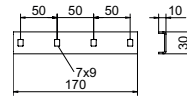

Straight connector to connect cable ladders and fittings with a side height of 25 mm.

Alu Aluminium

90° bend with trapezoidal rung, 25

GB Pickled

Type	Width mm	Rail thickness mm	Pack Piece	Weight kg/100 pc.	Item no.
SLB 90 42 075ALU	75	3	1	27.000	7098684
SLB 90 42 100ALU	100	3	1	29.500	7098686
SLB 90 42 150ALU	150	3	1	34.500	7098688
SLB 90 42 200ALU	200	3	1	39.500	7098690
SLB 90 42 250ALU	250	3	1	44.500	7098692
SLB 90 42 300ALU	300	3	1	49.500	7098694

0460 /pc.

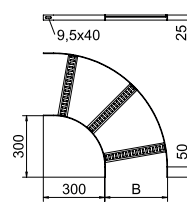

Connectors should be ordered separately and in the appropriate quantity.

Cable ladder with trapezoidal rung, 40

St Steel
SG Welding primed

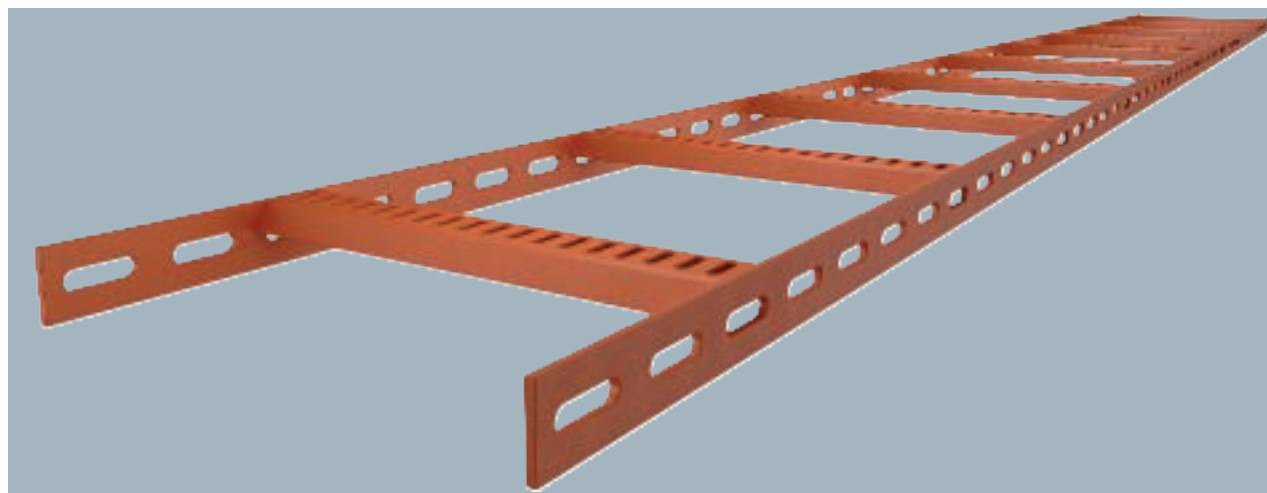
Type	Width mm	Rail thickness mm	Pack m	Weight kg/100 m	Item no.
SL 62 100 SG	100	5	3	299.000	7097212
SL 62 200 SG	200	5	3	332.340	7097239
SL 62 300 SG	300	5	3	365.670	7097247
SL 62 400 SG	400	5	3	398.670	7097255
SL 62 500 SG	500	5	3	432.000	7097263
SL 62 600 SG	600	5	3	465.340	7097271

Shipbuilding cable ladder with perforated side rail of side height 40 mm with welded, perforated trapezoidal rungs which open in a downwards direction. Load tested according to IEC in conjunction with connector, type SLV. Welding primer type SIGMA-WELD 199.

0460 price/m

Type	Length mm	Dimension B mm	Side height mm	Rail thickness mm
SL 62 100 SG	3000	110	40	5
SL 62 200 SG	3000	210	40	5
SL 62 300 SG	3000	310	40	5
SL 62 400 SG	3000	410	40	5
SL 62 500 SG	3000	510	40	5
SL 62 600 SG	3000	610	40	5

Dimensions

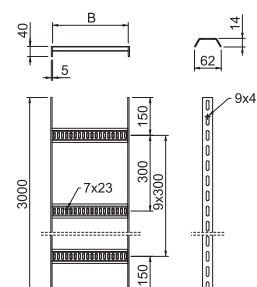

Type	1.5 m kN/m	2.0 m kN/m	2.5 m kN/m	3.0 m kN/m
SL 62 100 SG	3	2	1	0.6
SL 62 200 SG	3	2	1	0.6
SL 62 300 SG	3	2	1	0.6
SL 62 400 SG	3	2	1	0.6
SL 62 500 SG	3	2	1	0.6
SL 62 600 SG	3	2	1	0.6

Load

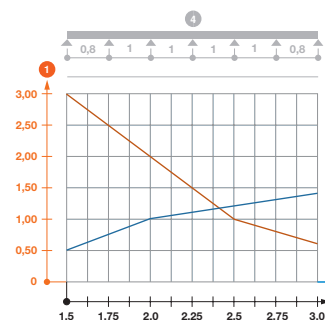

Load diagram, cable ladder SL62

- 1 Permitted cable tray/ladder load in kN/m without man load
- 2 Support width in m
- 3 Rail bend in mm at permitted kN/m
- Load curve with cable tray/ladder width in mm
- Strut bend curve according to support width
- 4 Load scheme during testing

St Steel
SG Welding primed

90° bend with trapezoidal rung, 40

Type	Width mm	Rail thickness mm	Pack Piece	Weight kg/100 pc.	Item no.
SLB 90 62 100 SG	100	5	1	204.000	7098707
SLB 90 62 200 SG	200	5	1	258.400	7098723
SLB 90 62 300 SG	300	5	1	311.000	7098731
SLB 90 62 400 SG	400	5	1	363.000	7098758
SLB 90 62 500 SG	500	5	1	421.000	7098766
SLB 90 62 600 SG	600	5	1	475.000	7098774

0460 /pc.

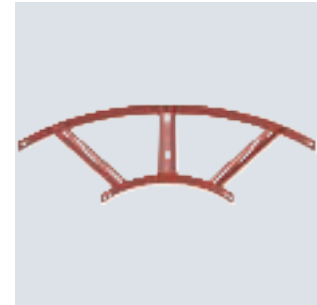
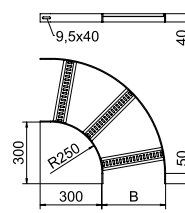

Connectors should be ordered separately and in the appropriate quantity.

Cable ladder with trapezoidal rung, 40

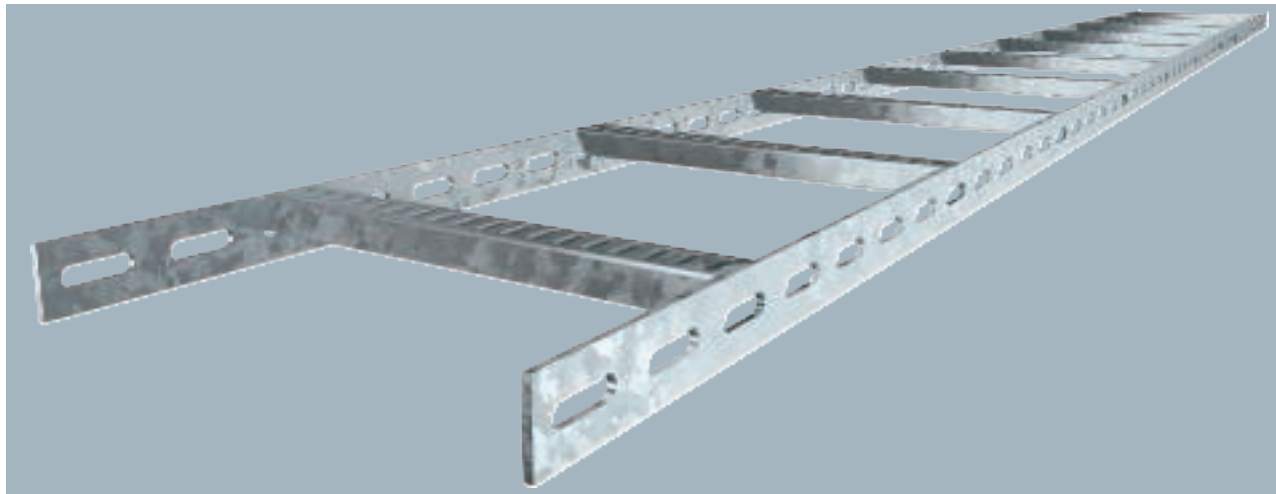
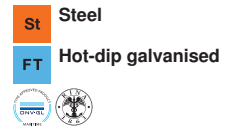

Type	Width mm	Rail thickness mm	Pack m	Weight kg/100 m	Item no.
SL 62 100 FT	100	5	3	307.300	7097409
SL 62 200 FT	200	5	3	342.700	7097425
SL 62 300 FT	300	5	3	378.000	7097433
SL 62 400 FT	400	5	3	413.000	7097441
SL 62 500 FT	500	5	3	448.300	7097468
SL 62 600 FT	600	5	3	483.700	7097476

Shipbuilding cable ladder with perforated side rail of side height 40 mm with welded, perforated trapezoidal rungs which open in a downwards direction. Load tested according to IEC in conjunction with connector, type SLV.

0460 price/m

	Length mm	Dimension B mm	Side height mm	Rail thickness mm
SL 62 100 FT	3000	110	40	5
SL 62 200 FT	3000	210	40	5
SL 62 300 FT	3000	310	40	5
SL 62 400 FT	3000	410	40	5
SL 62 500 FT	3000	510	40	5
SL 62 600 FT	3000	610	40	5

Dimensions

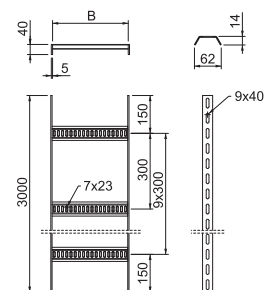

	1.5 m kN/m	2.0 m kN/m	2.5 m kN/m	3.0 m kN/m
SL 62 100 FT	3	2	1	0.6
SL 62 200 FT	3	2	1	0.6
SL 62 300 FT	3	2	1	0.6
SL 62 400 FT	3	2	1	0.6
SL 62 500 FT	3	2	1	0.6
SL 62 600 FT	3	2	1	0.6

Load

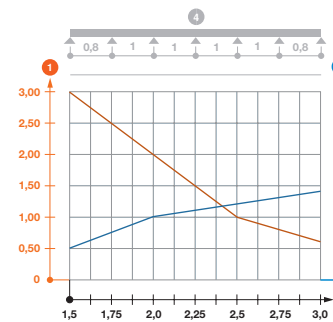

Load diagram, cable ladder SL62

- 1 Permitted cable tray/ladder load in kN/m without man load
- 2 Support width in m
- 3 Rail bend in mm at permitted kN/m
- Load curve with cable tray/ladder width in mm
- Strut bend curve according to support width
- 4 Load scheme during testing

St Steel
FT Hot-dip galvanised

Connector 40

Type	Pack Piece	Weight kg/100 pc.	Item no.
SLV 62 FT	10	14.600	7103576

0460

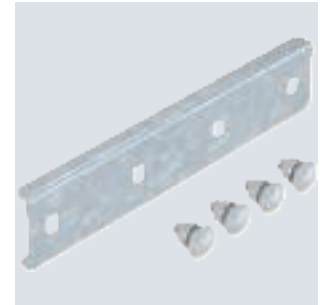
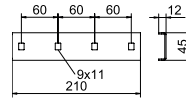

Straight connector to connect cable ladders and fittings with a side height of 40 mm.

St Steel
FT Hot-dip galvanised

90° bend with trapezoidal rung, 40

Type	Width mm	Rail thickness mm	Pack Piece	Weight kg/100 pc.	Item no.
SLB 90 62 100 FT	100	5	1	219.000	7098855
SLB 90 62 200 FT	200	5	1	278.000	7098871
SLB 90 62 300 FT	300	5	1	336.000	7098898
SLB 90 62 400 FT	400	5	1	372.000	7098901
SLB 90 62 500 FT	500	5	1	452.000	7098928
SLB 90 62 600 FT	600	5	1	511.000	7098936

0460 /pc.

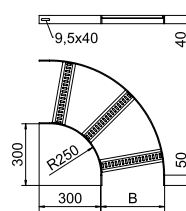

Connectors should be ordered separately and in the appropriate quantity.

Cable ladder with trapezoidal rung, 40

VA Stainless steel, rustproof 1.4301

2B Bright, reworked

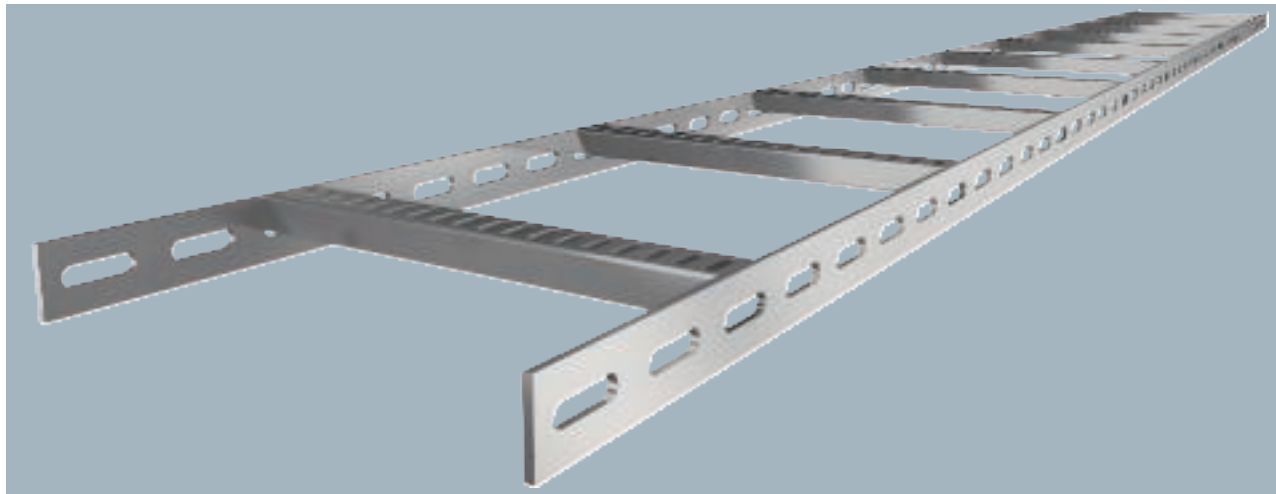

Type	Width mm	Rail thickness mm	Pack m	Weight kg/100 m	Item no.
SL 62 100 A2	100	5	3	299.000	7097094
SL 62 200 A2	200	5	3	332.334	7097096
SL 62 300 A2	300	5	3	365.334	7097098
SL 62 400 A2	400	5	3	398.667	7097100
SL 62 500 A2	500	5	3	432.000	7097102
SL 62 600 A2	600	5	3	465.334	7097104

Shipbuilding cable ladder with perforated side rail of side height 40 mm with welded, perforated trapezoidal rungs which open in a downwards direction. Load tested according to IEC in conjunction with connector, type SLV.

0460 price/m

Type	Length mm	Dimension B mm	Side height mm	Rail thickness mm
SL 62 100 A2	3000	110	40	5
SL 62 200 A2	3000	210	40	5
SL 62 300 A2	3000	310	40	5
SL 62 400 A2	3000	410	40	5
SL 62 500 A2	3000	510	40	5
SL 62 600 A2	3000	610	40	5

Dimensions

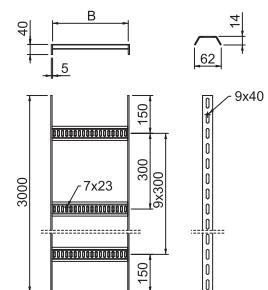

Type	1.5 m kN/m	2.0 m kN/m	2.5 m kN/m	3.0 m kN/m
SL 62 100 A2	2.8	1.2	0.8	0.45
SL 62 200 A2	2.8	1.2	0.8	0.45
SL 62 300 A2	2.8	1.2	0.8	0.45
SL 62 400 A2	2.8	1.4	0.8	0.55
SL 62 500 A2	2.8	1.4	0.8	0.55
SL 62 600 A2	2.8	1.4	0.8	0.55

Load

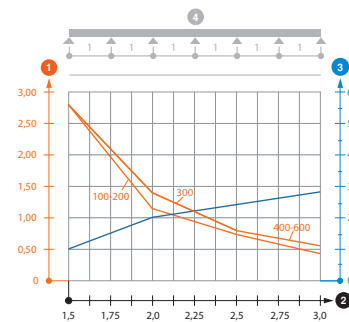

Load diagram, cable ladder SL62

- 1 Permitted cable tray/ladder load in kN/m without man load
- 2 Support width in m
- 3 Rail bend in mm at permitted kN/m
- Load curve with cable tray/ladder width in mm
- Strut bend curve according to support width
- 4 Load scheme during testing

VA Stainless steel, rustproof 1.4571

Connector 40

Type	Pack Piece	Weight kg/100 pc.	Item no.
SLV 62 A4	10	14.600	7103594

0460

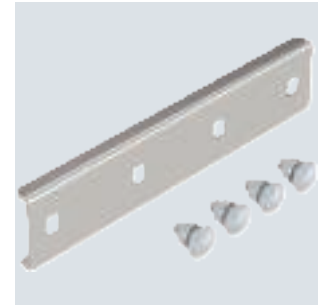
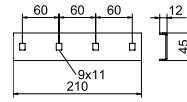

Straight connector to connect cable ladders and fittings with a side height of 40 mm.

VA Stainless steel, rustproof 1.4301

90° bend with trapezoidal rung, 40

2B Bright, reworked

Type	Width mm	Rail thickness mm	Pack Piece	Weight kg/100 pc.	Item no.
SLB 90 62 100 A2	100	5	1	206.800	7099150
SLB 90 62 200 A2	200	5	1	261.700	7099152
SLB 90 62 300 A2	300	5	1	316.700	7099154
SLB 90 62 400 A2	400	5	1	371.600	7099156
SLB 90 62 500 A2	500	5	1	426.500	7099158
SLB 90 62 600 A2	600	5	1	481.400	7099160

0460 /pc.

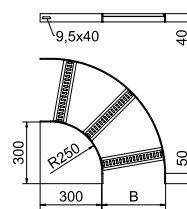

Connectors should be ordered separately and in the appropriate quantity.

Cable ladder with trapezoidal rung, 40

VA Stainless steel, rustproof 1.4571

2B Bright, reworked

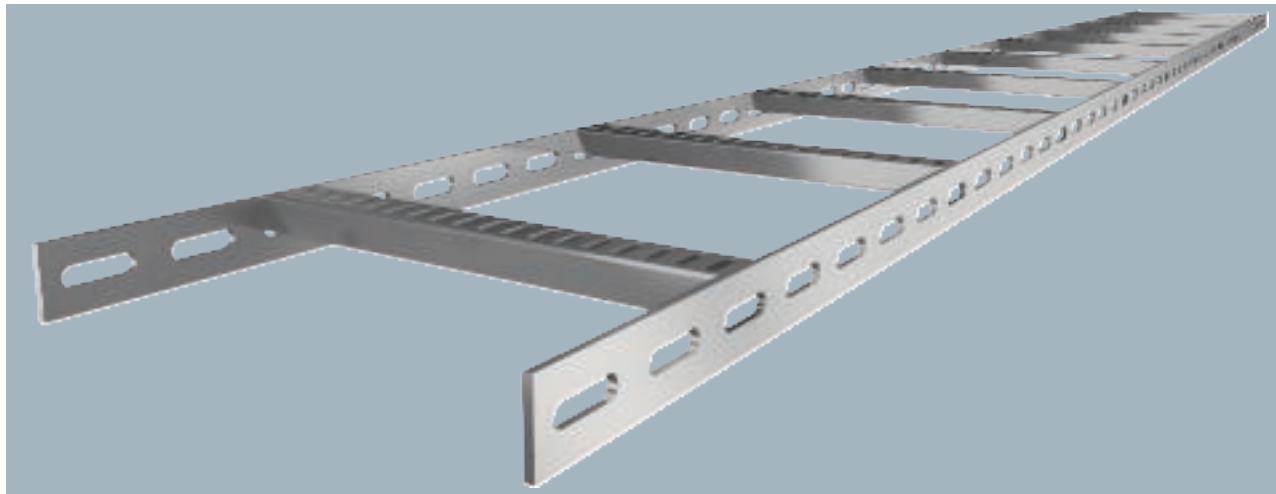

Type	Width mm	Rail thickness mm	Pack m	Weight kg/100 m	Item no.
SL 62 100 A4	100	5	3	299.000	7097358
SL 62 200 A4	200	5	3	332.334	7097360
SL 62 300 A4	300	5	3	365.334	7097362
SL 62 400 A4	400	5	3	398.667	7097364
SL 62 500 A4	500	5	3	432.000	7097366
SL 62 600 A4	600	5	3	465.334	7097368

Shipbuilding cable ladder with perforated side rail of side height 40 mm with welded, perforated trapezoidal rungs which open in a downwards direction. Load tested according to IEC in conjunction with connector, type SLV.

0460 price/m

Type	Length mm	Dimension B mm	Side height mm	Rail thickness mm
SL 62 100 A4	3000	110	40	5
SL 62 200 A4	3000	210	40	5
SL 62 300 A4	3000	310	40	5
SL 62 400 A4	3000	410	40	5
SL 62 500 A4	3000	510	40	5
SL 62 600 A4	3000	610	40	5

Dimensions

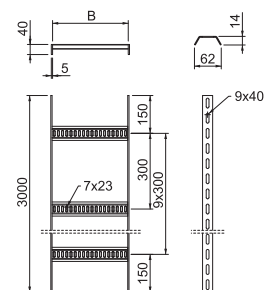

Type	1.5 m kN/m	2.0 m kN/m	2.5 m kN/m	3.0 m kN/m
SL 62 100 A4	2.8	1.2	0.8	0.45
SL 62 200 A4	2.8	1.2	0.8	0.45
SL 62 300 A4	2.8	1.2	0.8	0.45
SL 62 400 A4	2.8	1.4	0.8	0.55
SL 62 500 A4	2.8	1.4	0.8	0.55
SL 62 600 A4	2.8	1.4	0.8	0.55

Load

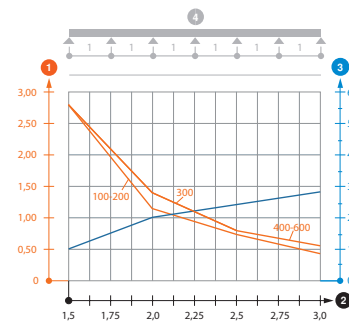

Load diagram, cable ladder SL62

- 1 Permitted cable tray/ladder load in kN/m without man load
- 2 Support width in m
- 3 Rail bend in mm at permitted kN/m
- Load curve with cable tray/ladder width in mm
- Strut bend curve according to support width
- 4 Load scheme during testing

VA Stainless steel, rustproof 1.4571

Connector 40

Type	Pack Piece	Weight kg/100 pc.	Item no.
SLV 62 A4	10	14.600	7103594

0460

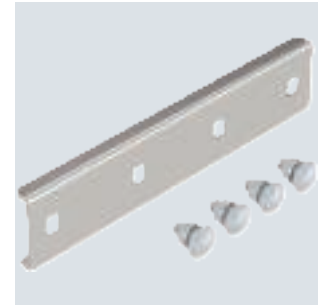
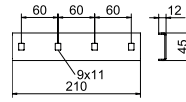

Straight connector to connect cable ladders and fittings with a side height of 40 mm.

VA Stainless steel, rustproof 1.4571

90° bend with trapezoidal rung, 40

2B Bright, reworked

Type	Width mm	Rail thickness mm	Pack Piece	Weight kg/100 pc.	Item no.
SLB 90 62 100 A4	100	5	1	209.000	7099168
SLB 90 62 200 A4	200	5	1	265.000	7099170
SLB 90 62 300 A4	300	5	1	321.000	7099172
SLB 90 62 400 A4	400	5	1	376.000	7099174
SLB 90 62 500 A4	500	5	1	432.000	7099176
SLB 90 62 600 A4	600	5	1	488.000	7099178

0460 /pc.

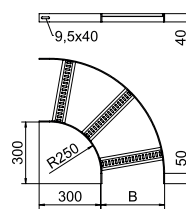

Connectors should be ordered separately and in the appropriate quantity.

Cable ladder with trapezoidal rung, 40

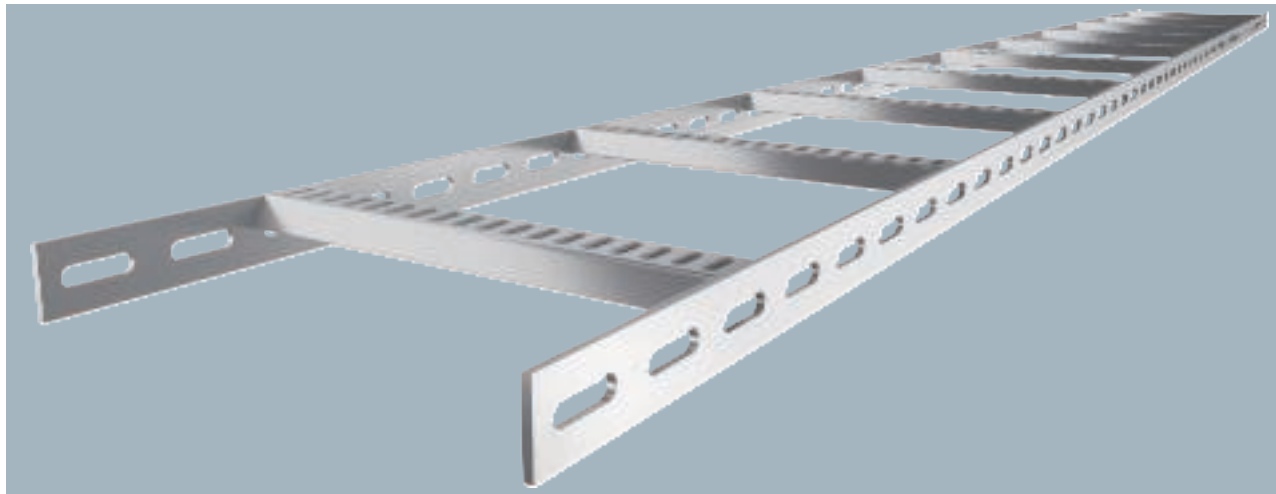

Type	Width mm	Rail thickness mm	Pack m	Weight kg/100 m	Item no.
SL 62 100 ALU	100	5	3	99.800	7099752
SL 62 200 ALU	200	5	3	111.067	7099754
SL 62 300 ALU	300	5	3	122.300	7099756
SL 62 400 ALU	400	5	3	133.567	7099758
SL 62 500 ALU	500	5	3	144.833	7099760
SL 62 600 ALU	600	5	3	156.100	7099762

Shipbuilding cable ladder with perforated side rail of side height 40 mm with welded, perforated trapezoidal rungs which open in a downwards direction.

0460 price/m

	Length mm	Dimen- sion B mm	Side height mm	Rail thickness mm
SL 62 100 ALU	3000	110	40	5
SL 62 200 ALU	3000	210	40	5
SL 62 300 ALU	3000	310	40	5
SL 62 400 ALU	3000	410	40	5
SL 62 500 ALU	3000	510	40	5
SL 62 600 ALU	3000	610	40	5

Dimensions

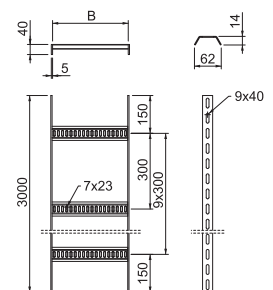

	1.5 m kN/m	2.0 m kN/m	2.5 m kN/m	3.0 m kN/m
SL 62 100 ALU	1.4	0.65	0.35	0.2
SL 62 200 ALU	1.4	0.65	0.35	0.2
SL 62 300 ALU	1.4	0.65	0.35	0.2
SL 62 400 ALU	1.4	0.65	0.35	0.2
SL 62 500 ALU	1.4	0.65	0.35	0.2
SL 62 600 ALU	1.4	0.65	0.35	0.2

Load

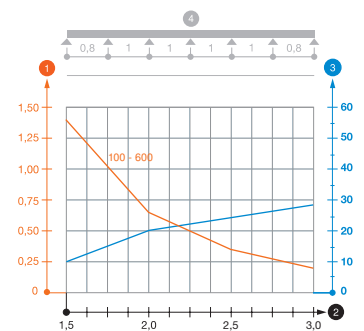

Load diagram, SL 62 cable ladder

- 1 Permitted cable tray/ladder load in kN/m without man load
- 2 Support width in m
- 3 Rail bend in mm at permitted kN/m
- 4 Load scheme during testing
- Load curve with cable tray/ladder width in mm
- Strut bend curve according to support width

Alu Aluminium

Connector 40

Type	Pack Piece	Weight kg/100 pc.	Item no.
SLV 62 ALU	10	7.000	7103586

0460

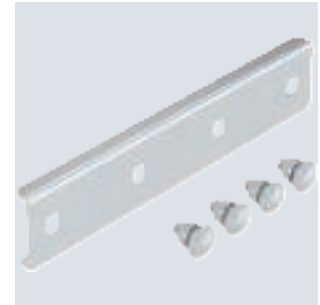
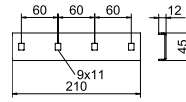

Straight connector to connect cable ladders and fittings with a side height of 40 mm.

Alu Aluminium

90° bend with trapezoidal rung, 40

GB Pickled

Type	Width mm	Rail thickness mm	Pack Piece	Weight kg/100 pc.	Item no.
SLB 90 62 100ALU	100	5	1	69.600	7099186
SLB 90 62 200ALU	200	5	1	88.100	7099188
SLB 90 62 300ALU	300	5	1	106.600	7099190
SLB 90 62 400ALU	400	5	1	125.100	7099192
SLB 90 62 500ALU	500	5	1	143.600	7099194
SLB 90 62 600ALU	600	5	1	162.100	7099196

0460 /pc.

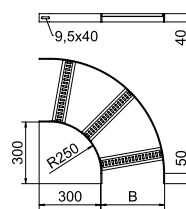

Connectors should be ordered separately and in the appropriate quantity.

Cable ladder with Z rung, 35

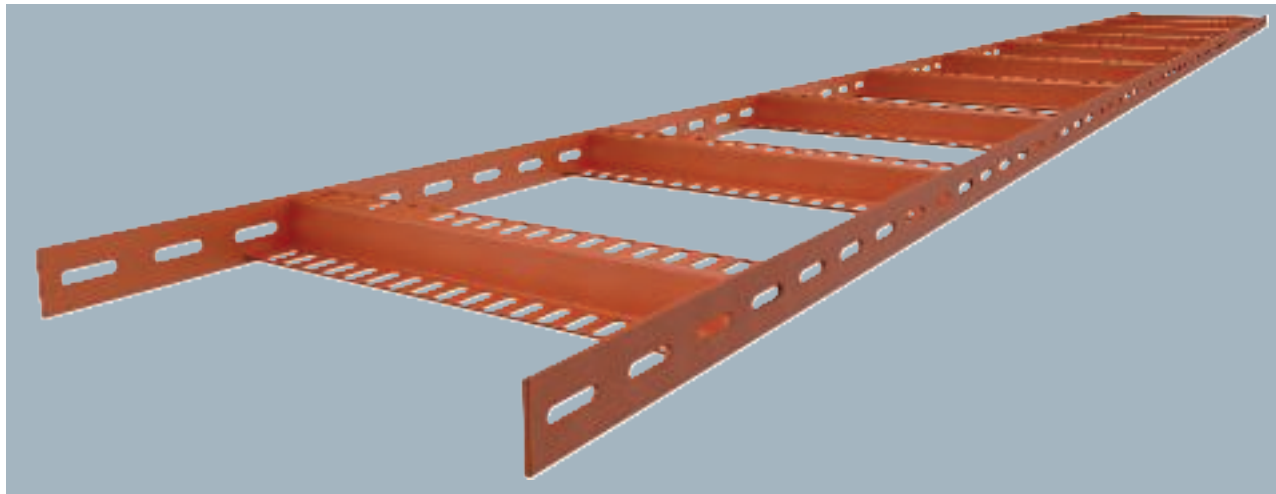

Type	Width mm	Rail thickness mm	Pack m	Weight kg/100 m	Item no.
SLZ L 100 SG	100	3	3	167.000	7098032
SLZ L 200 SG	200	3	3	187.667	7098036
SLZ L 300 SG	300	3	3	208.667	7098038
SLZ L 400 SG	400	3	3	229.334	7098040
SLZ L 500 SG	500	3	3	250.000	7098042
SLZ L 600 SG	600	3	3	270.667	7098044

Light-duty shipbuilding cable ladder with perforated side rail of side height 35 mm with welded, perforated Z rungs. Load tested according to IEC in conjunction with connector, type SLV. Welding primer type SIGMA-WELD 199, also available in white.

0460 price/m

Type	Length mm	Dimension B mm	Side height mm	Rail thickness mm
SLZ L 100 SG	3000	106	35	3
SLZ L 200 SG	3000	206	35	3
SLZ L 300 SG	3000	306	35	3
SLZ L 400 SG	3000	406	35	3
SLZ L 500 SG	3000	506	35	3
SLZ L 600 SG	3000	606	35	3

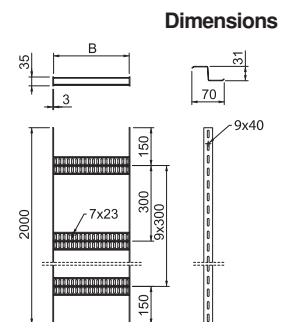

Type	1.5 m kN/m	2.0 m kN/m	2.5 m kN/m	3.0 m kN/m
SLZ L 100 SG	1.5	0.85	0.35	0.25
SLZ L 200 SG	1.5	0.85	0.35	0.25
SLZ L 300 SG	1.5	0.85	0.35	0.25
SLZ L 400 SG	1.5	0.85	0.35	0.25
SLZ L 500 SG	1.5	0.85	0.35	0.25
SLZ L 600 SG	1.5	0.85	0.35	0.25

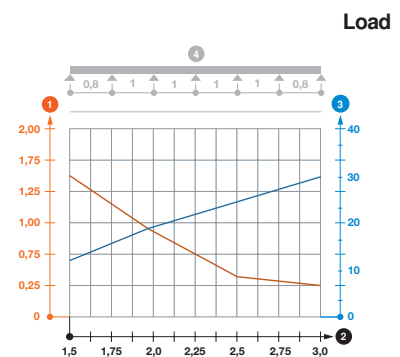

Load diagram, cable ladder SLZ L

- 1 Permitted cable tray/ladder load in kN/m without man load
- 2 Support width in m
- 3 Rail bend in mm at permitted kN/m
- Load curve with cable tray/ladder width in mm
- Strut bend curve according to support width
- 4 Load scheme during testing

St Steel
SG Welding primed

90° bend with Z rung, 35

Type	Width mm	Rail thickness mm	Pack Piece	Weight kg/100 pc.	Item no.
SLZB L 90 100 SG	100	3	1	111.000	7099201
SLZB L 90 200 SG	200	3	1	143.000	7099203
SLZB L 90 300 SG	300	3	1	174.000	7099205
SLZB L 90 400 SG	400	3	1	206.000	7099208
SLZB L 90 500 SG	500	3	1	237.000	7099210
SLZB L 90 600 SG	600	3	1	269.000	7099212

0460 /pc.

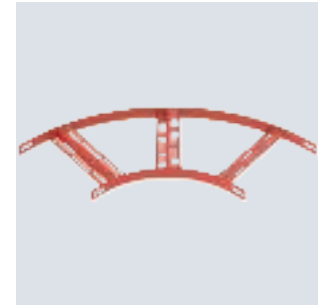
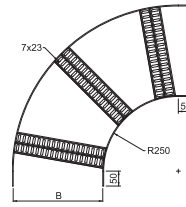

Connectors should be ordered separately and in the appropriate quantity.

Cable ladder with Z rung, 35

St Steel
FT Hot-dip galvanised

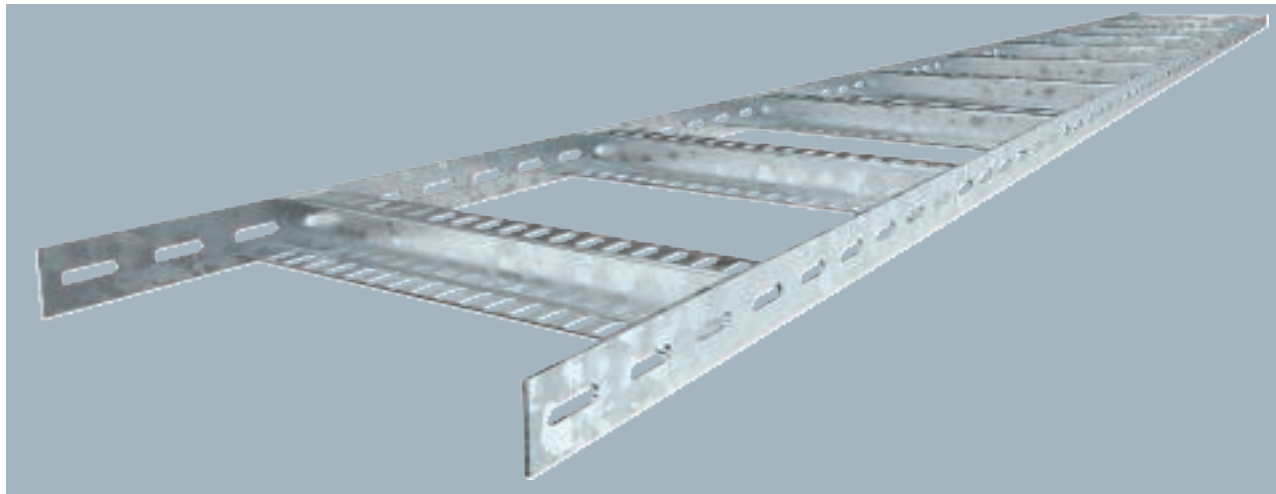

Type	Width mm	Rail thickness mm	Pack m	Weight kg/100 m	Item no.
SLZ L 100 FT	100	3	3	175.334	7098002
SLZ L 200 FT	200	3	3	198.334	7098006
SLZ L 300 FT	300	3	3	221.667	7098008
SLZ L 400 FT	400	3	3	245.000	7098010
SLZ L 500 FT	500	3	3	268.334	7098012
SLZ L 600 FT	600	3	3	291.667	7098014

Light-duty shipbuilding cable ladder with perforated side rail of side height 35 mm with welded, perforated Z rungs. Load tested according to IEC in conjunction with connector, type SLV.

0460 price/m

	Length mm	Dimension B mm	Side height mm	Rail thickness mm
SLZ L 100 FT	3000	106	35	3
SLZ L 200 FT	3000	206	35	3
SLZ L 300 FT	3000	306	35	3
SLZ L 400 FT	3000	406	35	3
SLZ L 500 FT	3000	506	35	3
SLZ L 600 FT	3000	606	35	3

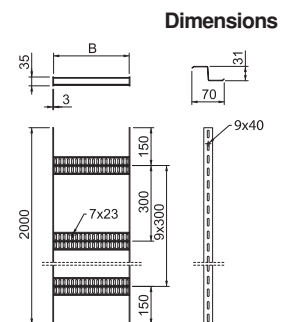

	1.5 m kN/m	2.0 m kN/m	2.5 m kN/m	3.0 m kN/m
SLZ L 100 FT	1.5	0.85	0.35	0.25
SLZ L 200 FT	1.5	0.85	0.35	0.25
SLZ L 300 FT	1.5	0.85	0.35	0.25
SLZ L 400 FT	1.5	0.85	0.35	0.25
SLZ L 500 FT	1.5	0.85	0.35	0.25
SLZ L 600 FT	1.5	0.85	0.35	0.25

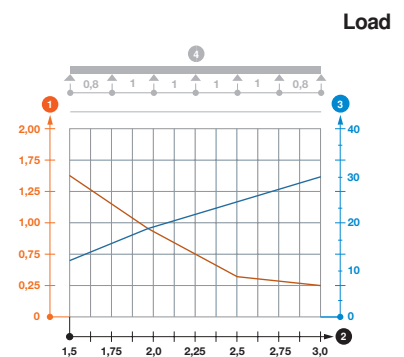

Load diagram, cable ladder SLZ L

- 1 Permitted cable tray/ladder load in kN/m without man load
- 2 Support width in m
- 3 Rail bend in mm at permitted kN/m
- Load curve with cable tray/ladder width in mm
- Strut bend curve according to support width
- 4 Load scheme during testing

VA Stainless steel, rustproof 1.4571

Connector 35

Type	Pack Piece	Weight kg/100 pc.	Item no.
SLV 52 A4	10	14.000	7103592

0460

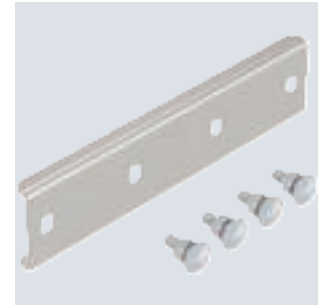
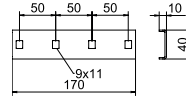

Straight connector to connect cable ladders and fittings with a side height of 35 mm.

St Steel

FT Hot-dip galvanised

90° bend with Z rung, 35

Type	Width mm	Rail thickness mm	Pack Piece	Weight kg/100 pc.	Item no.
SLZB L 90 100 FT	100	3	1	119.400	7099221
SLZB L 90 200 FT	200	3	1	153.300	7099224
SLZB L 90 300 FT	300	3	1	187.200	7099226
SLZB L 90 400 FT	400	3	1	221.000	7099228
SLZB L 90 500 FT	500	3	1	254.900	7099230
SLZB L 90 600 FT	600	3	1	288.800	7099232

0460 /pc.

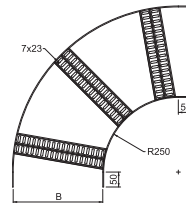

Connectors should be ordered separately and in the appropriate quantity.

Cable ladder with Z rung, 35

VA Stainless steel, rustproof 1.4301

2B Bright, reworked

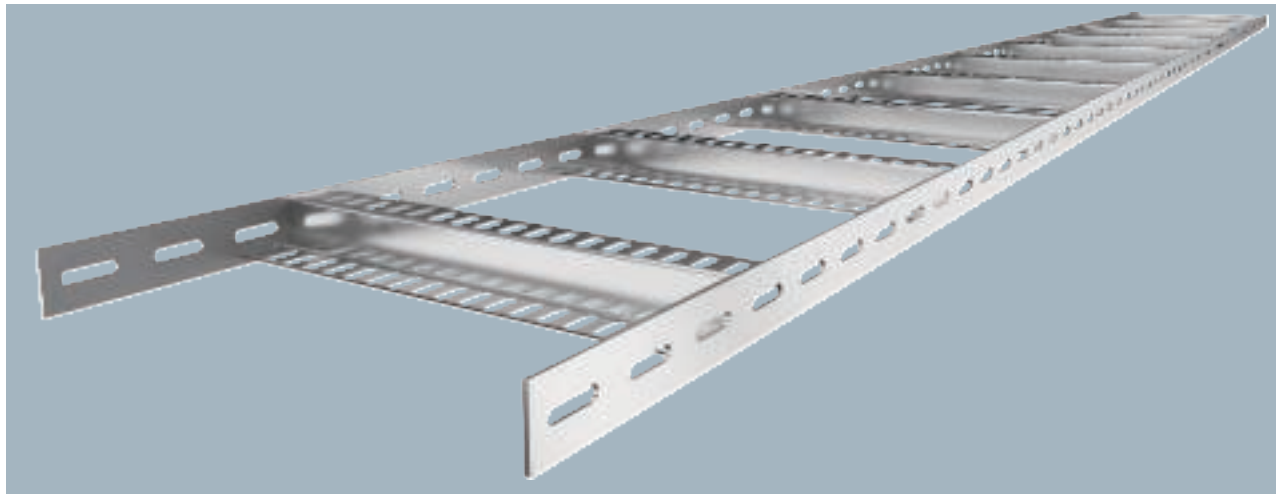

Type	Width mm	Rail thickness mm	Pack m	Weight kg/100 m	Item no.
SLZ L 100 A2	100	3	3	167.000	7098062
SLZ L 200 A2	200	3	3	187.667	7098066
SLZ L 300 A2	300	3	3	208.667	7098068
SLZ L 400 A2	400	3	3	229.167	7098070
SLZ L 500 A2	500	3	3	250.000	7098072
SLZ L 600 A2	600	3	3	270.667	7098074

Light-duty shipbuilding cable ladder with perforated side rail of side height 35 mm with welded, perforated Z rungs. Load tested according to IEC in conjunction with connector, type SLV.

0460 price/m

	Length mm	Dimension B mm	Side height mm	Rail thickness mm
SLZ L 100 A2	3000	106	35	3
SLZ L 200 A2	3000	206	35	3
SLZ L 300 A2	3000	306	35	3
SLZ L 400 A2	3000	406	35	3
SLZ L 500 A2	3000	506	35	3
SLZ L 600 A2	3000	606	35	3

Dimensions

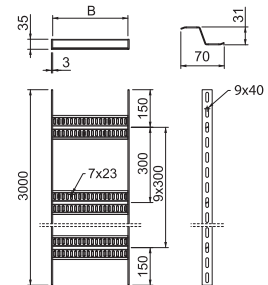

	1.0 m kN/m	1.5 m kN/m	2.0 m kN/m	2.5 m kN/m	3.0 m kN/m
SLZ L 100 A2	2.8	1	0.55	0.35	0.25
SLZ L 200 A2	2.8	1	0.55	0.35	0.25
SLZ L 300 A2	2.8	1	0.55	0.35	0.25
SLZ L 400 A2	2.2	1	0.55	0.25	0.25
SLZ L 500 A2	2.2	1	0.55	0.25	0.25
SLZ L 600 A2	2.2	1	0.55	0.25	0.25

Load

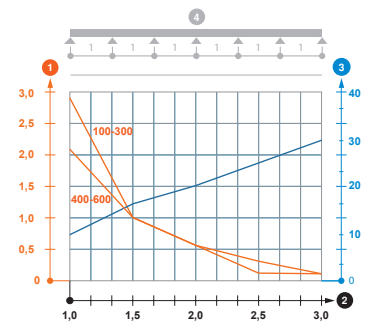

Load diagram, SLZ L cable ladder

- 1 Permitted cable tray/ladder load in kN/m without man load
- 2 Support width in m
- 3 Rail bend in mm at permitted kN/m
- Load curve with cable tray/ladder width in mm
- Strut bend curve according to support width
- 4 Load scheme during testing

VA Stainless steel, rustproof 1.4571

Connector 35

Type	Pack Piece	Weight kg/100 pc.	Item no.
SLV 52 A4	10	14.000	7103592

0460

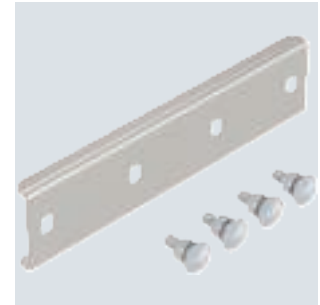
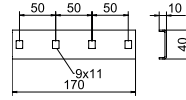

Straight connector to connect cable ladders and fittings with a side height of 35 mm.

VA Stainless steel, rustproof 1.4301

90° bend, 35

2B Bright, reworked

Type	Width mm	Rail thickness mm	Pack Piece	Weight kg/100 pc.	Item no.
SLZB L 90 100 A2	100	3	1	113.000	7099241
SLZB L 90 200 A2	200	3	1	145.000	7099243
SLZB L 90 300 A2	300	3	1	176.000	7099245
SLZB L 90 400 A2	400	3	1	208.000	7099247
SLZB L 90 500 A2	500	3	1	240.000	7099249
SLZB L 90 600 A2	600	3	1	272.000	7099251

0460 /pc.

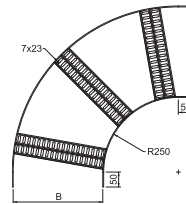

Connectors should be ordered separately and in the appropriate quantity.

Cable ladder with Z rung, 35

VA Stainless steel, rustproof 1.4571

2B Bright, reworked



Type	Width mm	Rail thickness mm	Pack m	Weight kg/100 m	Item no.
SLZ L 100 A4	100	3	3	167.000	7098082
SLZ L 200 A4	200	3	3	187.667	7098086
SLZ L 300 A4	300	3	3	208.667	7098088
SLZ L 400 A4	400	3	3	229.334	7098090
SLZ L 500 A4	500	3	3	250.000	7098092
SLZ L 600 A4	600	3	3	270.667	7098094

Light-duty shipbuilding cable ladder with perforated side rail of side height 35 mm with welded, perforated Z rungs. Load tested according to IEC in conjunction with connector, type SLV.

0460 price/m

	Length mm	Dimension B mm	Side height mm	Rail thickness mm
SLZ L 100 A4	3000	106	35	3
SLZ L 200 A4	3000	206	35	3
SLZ L 300 A4	3000	306	35	3
SLZ L 400 A4	3000	406	35	3
SLZ L 500 A4	3000	506	35	3
SLZ L 600 A4	3000	606	35	3

Dimensions

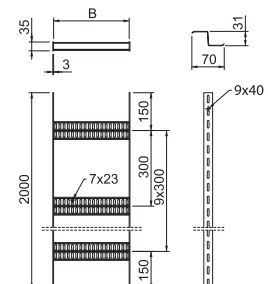

	1.0 m kN/m	1.5 m kN/m	2.0 m kN/m	2.5 m kN/m	3.0 m kN/m
SLZ L 100 A4	2.8	1	0.55	0.35	0.25
SLZ L 200 A4	2.8	1	0.55	0.35	0.25
SLZ L 300 A4	2.8	1	0.55	0.35	0.25
SLZ L 400 A4	2.2	1	0.55	0.25	0.25
SLZ L 500 A4	2.2	1	0.55	0.25	0.25
SLZ L 600 A4	2.2	1	0.55	0.25	0.25

Load

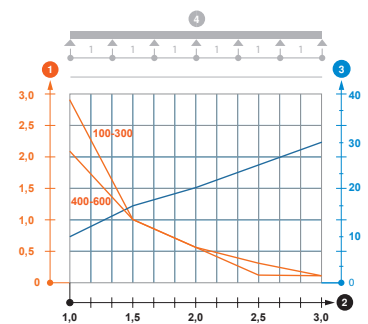

Load diagram, SLZ L cable ladder

- 1 Permitted cable tray/ladder load in kN/m without man load
- 2 Support width in m
- 3 Rail bend in mm at permitted kN/m
- Load curve with cable tray/ladder width in mm
- Strut bend curve according to support width
- 4 Load scheme during testing

VA Stainless steel, rustproof 1.4571

Connector 35

Type	Pack Piece	Weight kg/100 pc.	Item no.
SLV 52 A4	10	14.000	7103592

0460

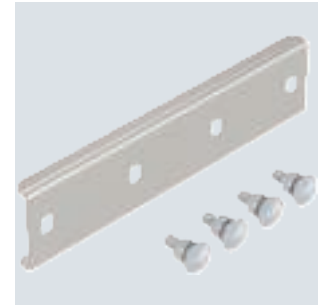
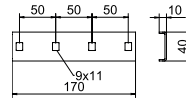

Straight connector to connect cable ladders and fittings with a side height of 35 mm.

VA Stainless steel, rustproof 1.4571

90° bend with Z rung, 35

2B Bright, reworked

Type	Width mm	Rail thickness mm	Pack Piece	Weight kg/100 pc.	Item no.
SLZB L 90 100 A4	100	3	1	114.000	7099261
SLZB L 90 200 A4	200	3	1	146.400	7099263
SLZB L 90 300 A4	300	3	1	178.700	7099265
SLZB L 90 400 A4	400	3	1	211.000	7099268
SLZB L 90 500 A4	500	3	1	243.400	7099270
SLZB L 90 600 A4	600	3	1	275.700	7099272

0460 /pc.

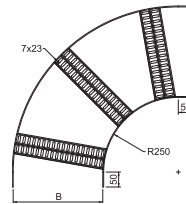

Connectors should be ordered separately and in the appropriate quantity.

Cable ladder with Z rung, 40

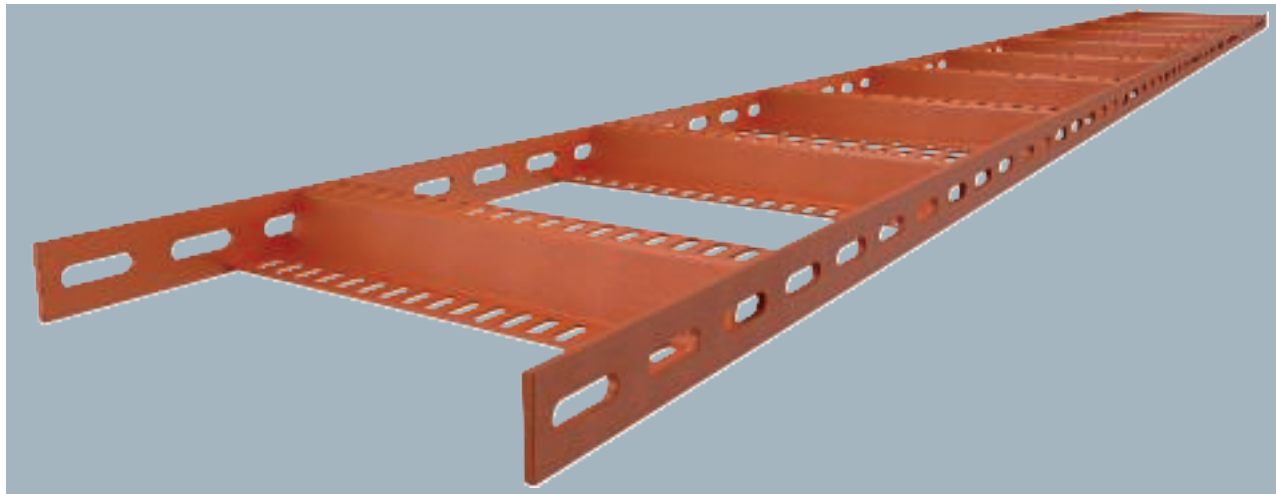

Type	Width mm	Rail thickness mm	Pack m	Weight kg/100 m	Item no.
SLZ 100 SG	100	5	3	319.000	7098162
SLZ 200 SG	200	5	3	372.333	7098164
SLZ 300 SG	300	5	3	425.666	7098166
SLZ 400 SG	400	5	3	479.000	7098168
SLZ 500 SG	500	5	3	532.333	7098170
SLZ 600 SG	600	5	3	585.666	7098172

Shipbuilding cable ladder with perforated side rail of side height 40 mm with welded, perforated Z rungs. Load tested according to IEC in conjunction with connector, type SLV. Welding primer type SIGMA-WELD 199, also available in white.

0460 price/m

Type	Length mm	Dimension B mm	Side height mm	Rail thickness mm
SLZ 100 SG	3000	110	40	5
SLZ 200 SG	3000	210	40	5
SLZ 300 SG	3000	310	40	5
SLZ 400 SG	3000	410	40	5
SLZ 500 SG	3000	510	40	5
SLZ 600 SG	3000	610	40	5

Dimensions

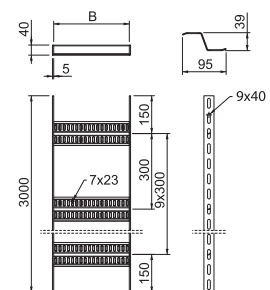

Type	1.5 m kN/m	2.0 m kN/m	2.5 m kN/m	3.0 m kN/m
SLZ 100 SG	2.8	1.75	1	0.6
SLZ 200 SG	2.8	1.75	1	0.6
SLZ 300 SG	2.8	1.75	1	0.6
SLZ 400 SG	2.8	1.75	1	0.6
SLZ 500 SG	2.8	1.75	1	0.6
SLZ 600 SG	2.8	1.75	1	0.6

Load

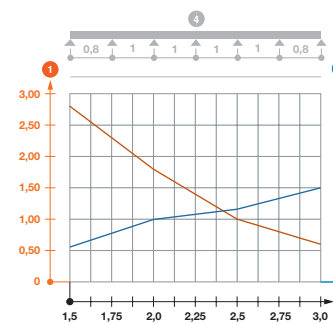

Load diagram, cable ladder SLZ

- 1 Permitted cable tray/ladder load in kN/m without man load
- 2 Support width in m
- 3 Rail bend in mm at permitted kN/m
- Load curve with cable tray/ladder width in mm
- Strut bend curve according to support width
- 4 Load scheme during testing

St Steel
SG Welding primed

90° bend with Z rung, 40

Type	Width mm	Rail thickness mm	Pack Piece	Weight kg/100 pc.	Item no.
SLZB 90 100 SG	100	5	1	222.200	7098976
SLZB 90 200 SG	200	5	1	295.100	7098978
SLZB 90 300 SG	300	5	1	338.600	7098980
SLZB 90 400 SG	400	5	1	441.300	7098982
SLZB 90 500 SG	500	5	1	514.000	7098984
SLZB 90 600 SG	600	5	1	586.600	7098986

0460 /pc.

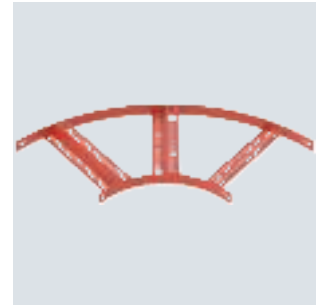
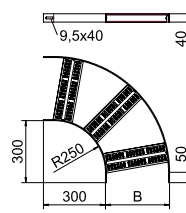

Connectors should be ordered separately and in the appropriate quantity.

Cable ladder with Z rung, 40

St Steel
FT Hot-dip galvanised

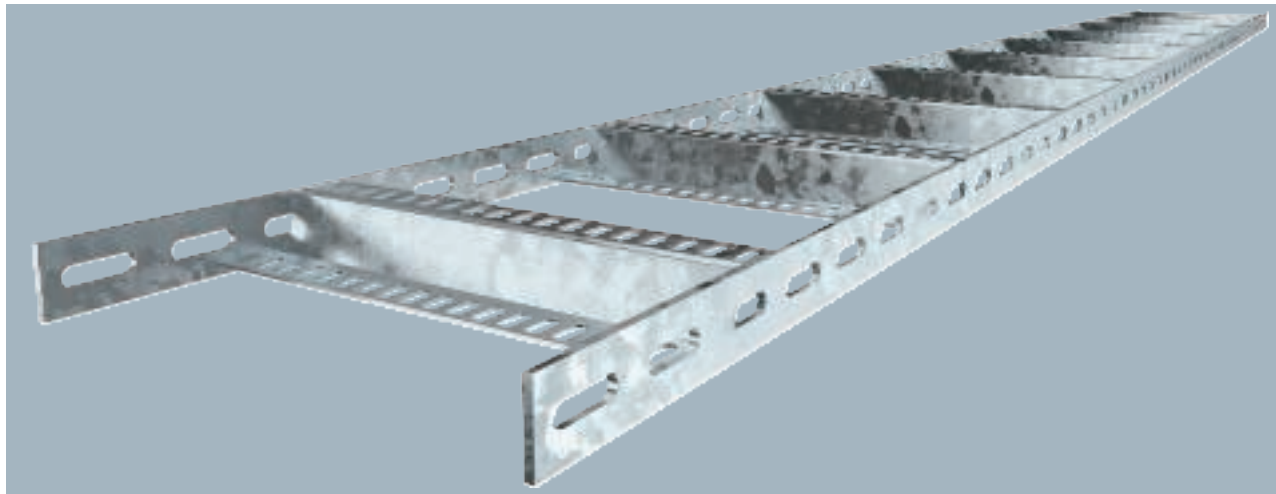

Type	Width mm	Rail thickness mm	Pack m	Weight kg/100 m	Item no.
SLZ 100 FT	100	5	3	328.666	7098132
SLZ 200 FT	200	5	3	385.333	7098134
SLZ 300 FT	300	5	3	441.666	7098136
SLZ 400 FT	400	5	3	498.166	7098138
SLZ 500 FT	500	5	3	554.666	7098140
SLZ 600 FT	600	5	3	611.333	7098142

Shipbuilding cable ladder with perforated side rail of side height 40 mm with welded, perforated Z rungs. Load tested according to IEC in conjunction with connector, type SLV.

0460 price/m

	Length mm	Dimension B mm	Side height mm	Rail thickness mm
SLZ 100 FT	3000	110	40	5
SLZ 200 FT	3000	210	40	5
SLZ 300 FT	3000	310	40	5
SLZ 400 FT	3000	410	40	5
SLZ 500 FT	3000	510	40	5
SLZ 600 FT	3000	610	40	5

Dimensions

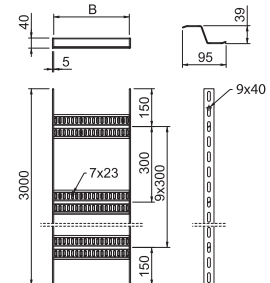

	1.5 m kN/m	2.0 m kN/m	2.5 m kN/m	3.0 m kN/m
SLZ 100 FT	2.8	1.75	1	0.6
SLZ 200 FT	2.8	1.75	1	0.6
SLZ 300 FT	2.8	1.75	1	0.6
SLZ 400 FT	2.8	1.75	1	0.6
SLZ 500 FT	2.8	1.75	1	0.6
SLZ 600 FT	2.8	1.75	1	0.6

Load

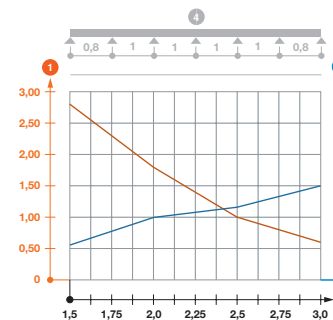

Load diagram, cable ladder SLZ

- ① Permitted cable tray/ladder load in kN/m without man load
- ② Support width in m
- ③ Rail bend in mm at permitted kN/m
- Load curve with cable tray/ladder width in mm
- Strut bend curve according to support width
- ④ Load scheme during testing

Connector 40

St Steel
FT Hot-dip galvanised

Type	Pack Piece	Weight kg/100 pc.	Item no.
SLV 62 FT	10	14.600	7103576

0460

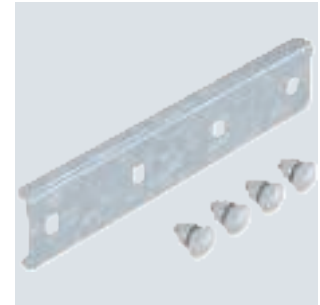
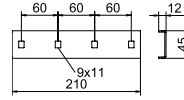

Straight connector to connect cable ladders and fittings with a side height of 40 mm.

St Steel
FT Hot-dip galvanised

90° bend with Z rung, 40

Type	Width mm	Rail thickness mm	Pack Piece	Weight kg/100 pc.	Item no.
SLZB 90 100 FT	100	5	1	228.900	7099000
SLZB 90 200 FT	200	5	1	306.000	7099002
SLZB 90 300 FT	300	5	1	382.000	7099004
SLZB 90 400 FT	400	5	1	458.000	7099006
SLZB 90 500 FT	500	5	1	533.000	7099008
SLZB 90 600 FT	600	5	1	609.000	7099010

0460 /pc.

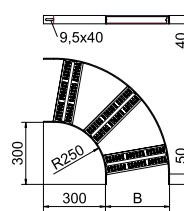

Connectors should be ordered separately and in the appropriate quantity.

Cable ladder with Z rung, 40

VA Stainless steel, rustproof 1.4301

2B Bright, reworked

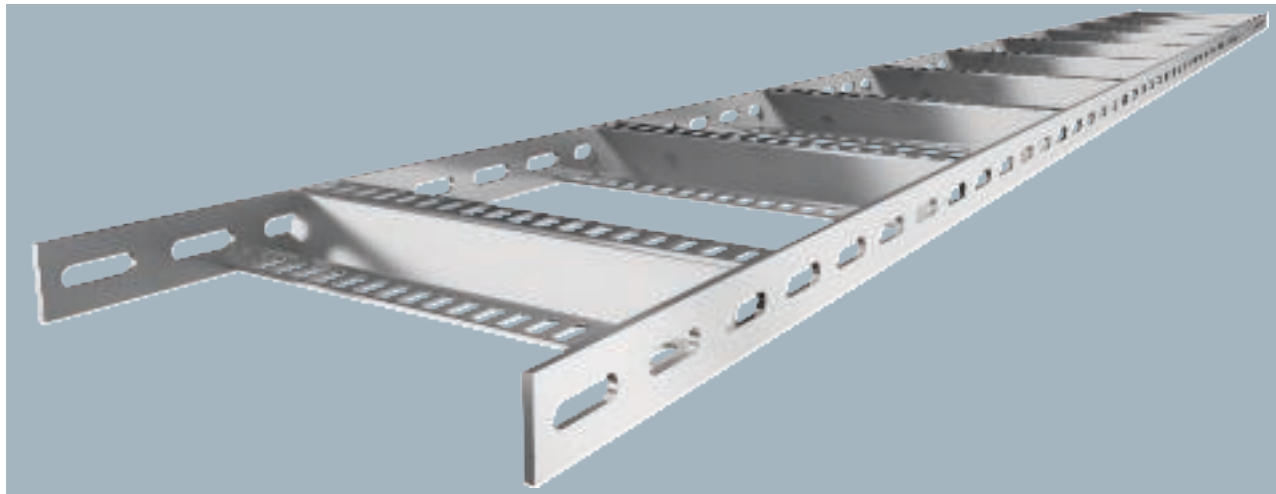

Type	Width mm	Rail thickness mm	Pack m	Weight kg/100 m	Item no.
SLZ 100 A2	100	5	3	319.000	7098192
SLZ 200 A2	200	5	3	372.400	7098194
SLZ 300 A2	300	5	3	425.670	7098196
SLZ 400 A2	400	5	3	479.000	7098198
SLZ 500 A2	500	5	3	532.340	7098200
SLZ 600 A2	600	5	3	585.670	7098202

Shipbuilding cable ladder with perforated side rail of side height 40 mm with welded, perforated Z rungs. Load tested according to IEC in conjunction with connector, type SLV.

0460 price/m

Type	Length mm	Dimension B mm	Side height mm	Rail thickness mm
SLZ 100 A2	3000	110	40	5
SLZ 200 A2	3000	210	40	5
SLZ 300 A2	3000	310	40	5
SLZ 400 A2	3000	410	40	5
SLZ 500 A2	3000	510	40	5
SLZ 600 A2	3000	610	40	5

Dimensions

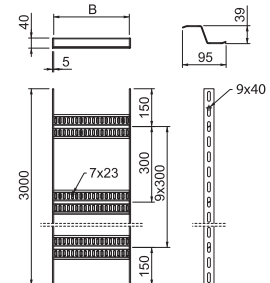

Type	1.5 m kN/m	2.0 m kN/m	2.5 m kN/m	3.0 m kN/m
SLZ 100 A2	2.8	1.5	0.8	0.5
SLZ 200 A2	2.8	1.5	0.8	0.5
SLZ 300 A2	2.8	1.5	0.8	0.5
SLZ 400 A2	2.8	1.5	0.8	0.5
SLZ 500 A2	2.8	1.5	0.8	0.5
SLZ 600 A2	2.8	1.5	0.8	0.5

Load

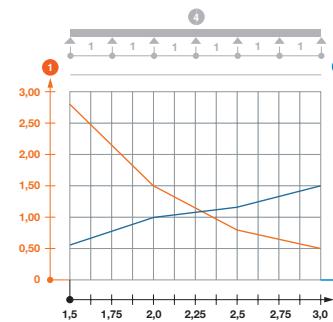

Load diagram, cable ladder SLZ

- 1 Permitted cable tray/ladder load in kN/m without man load
- 2 Support width in m
- 3 Rail bend in mm at permitted kN/m
- Load curve with cable tray/ladder width in mm
- Strut bend curve according to support width
- 4 Load scheme during testing

VA Stainless steel, rustproof 1.4571

Connector 40

Type	Pack Piece	Weight kg/100 pc.	Item no.
SLV 62 A4	10	14.600	7103594

0460

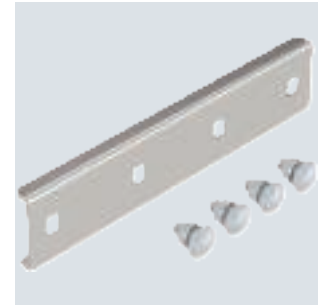
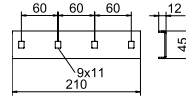

Straight connector to connect cable ladders and fittings with a side height of 40 mm.

VA Stainless steel, rustproof 1.4301

90° bend with Z rung, 40

2B Bright, reworked

Type	Width mm	Rail thickness mm	Pack Piece	Weight kg/100 pc.	Item no.
SLZB 90 100 A2	100	5	1	225.100	7099030
SLZB 90 200 A2	200	5	1	298.300	7099032
SLZB 90 300 A2	300	5	1	371.500	7099034
SLZB 90 400 A2	400	5	1	444.600	7099036
SLZB 90 500 A2	500	5	1	517.700	7099038
SLZB 90 600 A2	600	5	1	590.900	7099040

0460 /pc.

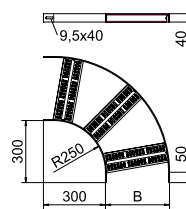

Connectors should be ordered separately and in the appropriate quantity.

Cable ladder with Z rung, 40

VA Stainless steel, rustproof 1.4571

2B Bright, reworked

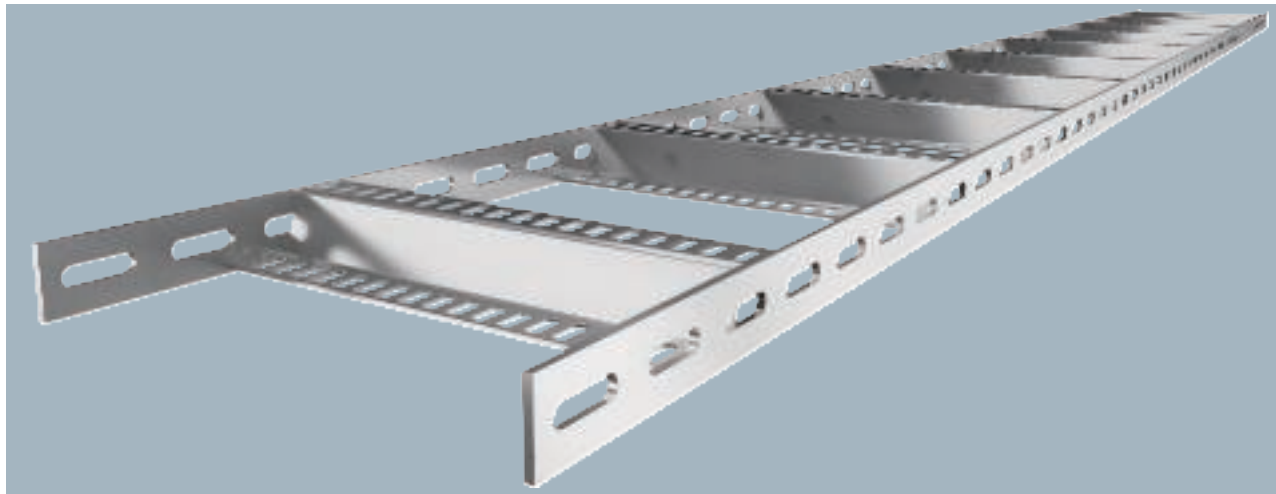

Type	Width mm	Rail thickness mm	Pack m	Weight kg/100 m	Item no.
SLZ 100 A4	100	5	3	319.000	7098222
SLZ 200 A4	200	5	3	372.340	7098224
SLZ 300 A4	300	5	3	427.670	7098226
SLZ 400 A4	400	5	3	479.000	7098228
SLZ 500 A4	500	5	3	532.340	7098230
SLZ 600 A4	600	5	3	585.670	7098232

Shipbuilding cable ladder with perforated side rail of side height 40 mm with welded, perforated Z rungs. Load tested according to IEC in conjunction with connector, type SLV.

0460 price/m

Type	Length mm	Dimension B mm	Side height mm	Rail thickness mm
SLZ 100 A4	3000	110	40	5
SLZ 200 A4	3000	210	40	5
SLZ 300 A4	3000	310	40	5
SLZ 400 A4	3000	410	40	5
SLZ 500 A4	3000	510	40	5
SLZ 600 A4	3000	610	40	5

Dimensions

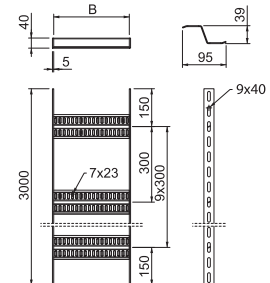

Type	1.5 m kN/m	2.0 m kN/m	2.5 m kN/m	3.0 m kN/m
SLZ 100 A4	2.8	1.5	0.8	0.5
SLZ 200 A4	2.8	1.5	0.8	0.5
SLZ 300 A4	2.8	1.5	0.8	0.5
SLZ 400 A4	2.8	1.5	0.8	0.5
SLZ 500 A4	2.8	1.5	0.8	0.5
SLZ 600 A4	2.8	1.5	0.8	0.5

Load

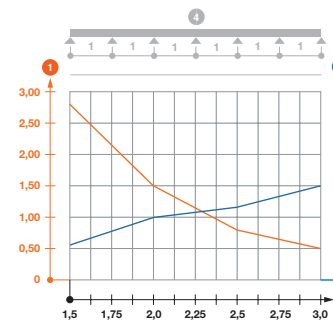

Load diagram, cable ladder SLZ

- 1 Permitted cable tray/ladder load in kN/m without man load
- 2 Support width in m
- 3 Rail bend in mm at permitted kN/m
- Load curve with cable tray/ladder width in mm
- Strut bend curve according to support width
- 4 Load scheme during testing

VA Stainless steel, rustproof 1.4571

Connector 40

Type	Pack Piece	Weight kg/100 pc.	Item no.
SLV 62 A4	10	14.600	7103594

0460

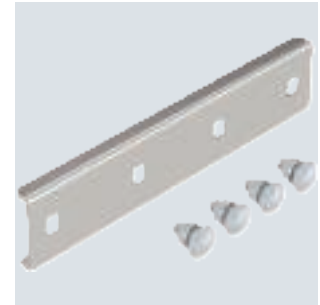
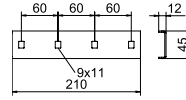

Straight connector to connect cable ladders and fittings with a side height of 40 mm.

VA Stainless steel, rustproof 1.4571

90° bend with Z rung, 40

2B Bright, reworked

Type	Width mm	Rail thickness mm	Pack Piece	Weight kg/100 pc.	Item no.
SLZB 90 100 A4	100	5	1	227.900	7099060
SLZB 90 200 A4	200	5	1	302.100	7099062
SLZB 90 300 A4	300	5	1	376.200	7099064
SLZB 90 400 A4	400	5	1	450.200	7099066
SLZB 90 500 A4	500	5	1	524.300	7099068
SLZB 90 600 A4	600	5	1	598.300	7099070

0460 /pc.

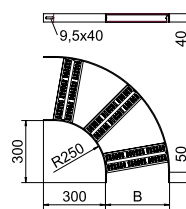

Connectors should be ordered separately and in the appropriate quantity.

Cable ladder with Z rung, 40



Type	Width mm	Rail thickness mm	Pack m	Weight kg/100 m	Item no.
SLZ 100 ALU	100	5	3	106.600	7099772
SLZ 200 ALU	200	5	3	124.667	7099774
SLZ 300 ALU	300	5	3	142.734	7099776
SLZ 400 ALU	400	5	3	160.767	7099778
SLZ 500 ALU	500	5	3	178.834	7099780
SLZ 600 ALU	600	5	3	196.900	7099782

Shipbuilding cable ladder with perforated side rail of side height 40 mm with welded, perforated Z rungs.

0460 price/m

Type	Length mm	Dimension B mm	Side height mm	Rail thickness mm
SLZ 100 ALU	3000	110	40	5
SLZ 200 ALU	3000	210	40	5
SLZ 300 ALU	3000	310	40	5
SLZ 400 ALU	3000	410	40	5
SLZ 500 ALU	3000	510	40	5
SLZ 600 ALU	3000	610	40	5

Dimensions

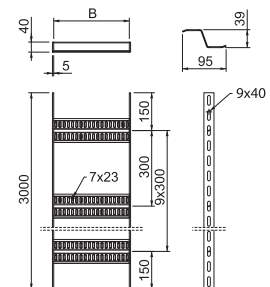

Type	1.5 m kN/m	2.0 m kN/m	2.5 m kN/m	3.0 m kN/m
SLZ 100 ALU	1.4	0.65	0.35	0.2
SLZ 200 ALU	1.4	0.65	0.35	0.2
SLZ 300 ALU	1.4	0.65	0.35	0.2
SLZ 400 ALU	1.4	0.65	0.35	0.2
SLZ 500 ALU	1.4	0.65	0.35	0.2
SLZ 600 ALU	1.4	0.65	0.35	0.2

Load

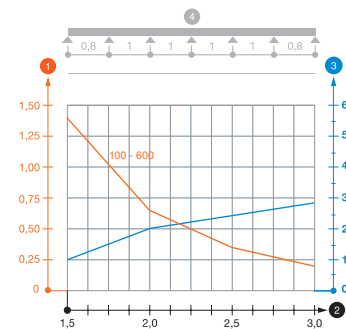

Load diagram, SLZ cable ladder

- 1 Permitted cable tray/ladder load in kN/m without man load
- 2 Support width in m
- 3 Rail bend in mm at permitted kN/m
- 4 Load scheme during testing
- Load curve with cable tray/ladder width in mm
- Strut bend curve according to support width

Alu Aluminium

Type	Pack Piece	Weight kg/100 pc.	Item no.
SLV 62 ALU	10	7.000	7103586

0460

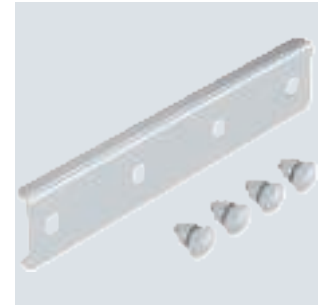
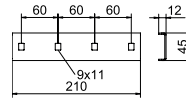

Connector 40

Straight connector to connect cable ladders and fittings with a side height of 40 mm.

Alu Aluminium

GB Pickled

Type	Width mm	Rail thickness mm	Pack Piece	Weight kg/100 pc.	Item no.
SLZB 90 100 ALU	100	5	1	75.800	7099090
SLZB 90 200 ALU	200	5	1	100.400	7099092
SLZB 90 300 ALU	300	5	1	125.100	7099094
SLZB 90 400 ALU	400	5	1	149.700	7099096
SLZB 90 500 ALU	500	5	1	174.300	7099098
SLZB 90 600 ALU	600	5	1	198.900	7099100

0460 /pc.

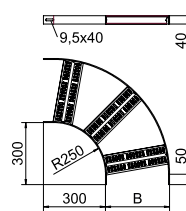

90° bend with Z rung, 40

Connectors should be ordered separately and in the appropriate quantity.

SL42 construction and suspension profile

- St** Steel
- VA** Stainless steel, rustproof 1.4301
- VA** Stainless steel, rustproof 1.4571
- SG** Welding primed
- FT** Hot-dip galvanised
- 2B** Bright, reworked



Rail profile of 25 mm side height for welding in trapezoidal rungs.
The rail profile is available in unpainted steel on request.

Type	Dimension mm	Length mm	Pack m	Weight kg/100 m	Item no.
SLH 42 2000 SG	25x3	2000	2	50.000	7103603
SLH 42 2000 FT	25x3	2000	2	51.500	7103611
SLH 42 2000 A2	25x3	2000	2	50.000	7103620
SLH 42 2000 A4	25x3	2000	2	50.000	7103626

0460 price/m

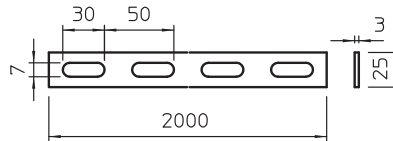

Construction and suspension profile, SL62

- St** Steel
- VA** Stainless steel, rustproof 1.4301
- VA** Stainless steel, rustproof 1.4571
- SG** Welding primed
- FT** Hot-dip galvanised
- 2B** Bright, reworked



Rail profile of 25 mm side height for welding in trapezoidal rungs.
The rail profile is available in unpainted steel on request.

Type	Dimension mm	Length mm	Pack m	Weight kg/100 m	Item no.
SLH 62 3000 SG	40x5	3000	3	133.000	7103635
SLH 62 3000 FT	40x5	3000	3	135.700	7103643
SLH 62 3000 A2	40x5	3000	3	133.000	7103650
SLH 62 3000 A4	40x5	3000	3	133.000	7103656

0460 price/m

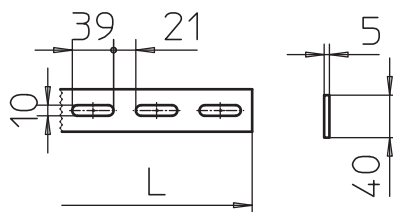

Construction and suspension profile FESP L BK

- St** Steel
- BK** Bright
- FT** Hot-dip galvanised

Type	Dimension mm	Length mm	Pack m	Weight kg/100 m	Item no.
FESP L 50 4 BK	50x4	3000	3	116.000	7104960
FESP L 50 4 FT	50x4	3000	3	118.900	7105002

0460 price/m

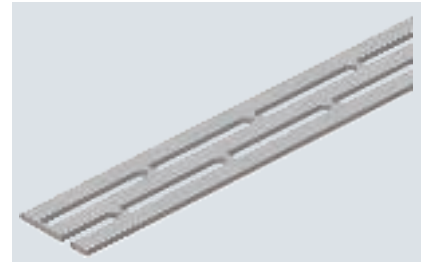
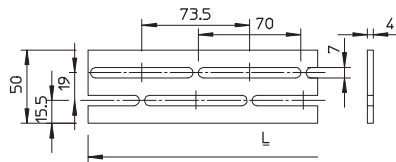

Flat iron profile with double, offset longitudinal hole row for creation of suspension and support constructions.

Construction and suspension profile FESP Q SG

- St** Steel
- SG** Welding primed
- FT** Hot-dip galvanised

Type	Dimension mm	Length mm	Pack m	Weight kg/100 m	Item no.
FESP Q 40 5 SG	40x5	3000	3	123.300	7104358
FESP Q 40 5 FT	40x5	3000	3	130.000	7104356

0460 price/m

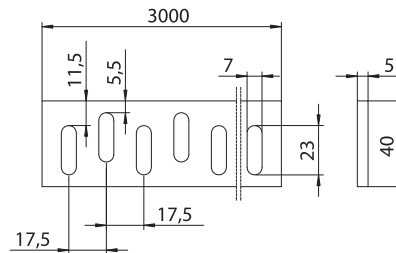

Flat iron profile with double, side-offset slot row to create suspension and support constructions.

Construction and suspension profile FESP Q BK

- St** Steel
- BK** Bright

Type	Length mm	Metal thickness mm	Pack m	Weight kg/100 m	Item no.
FESP Q 50 5 BK	3000	5.00	3	166.367	7104367

0460 price/m

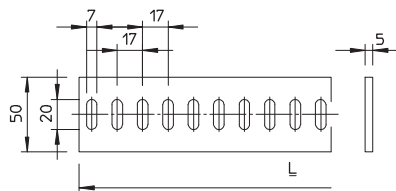

Flat iron profile with slots to create suspensions and support constructions.

Construction and suspension profile FESP QL BK

St Steel
BK Bright



Flat iron profile with transverse and lengthwise slots to create suspended and support constructions.

Type	Length mm	Metal thickness mm	Pack m	Weight kg/100 m	Item no.
FESP QL 50 4 BK	3000	4.00	3	118.567	7104669

0460 price/m

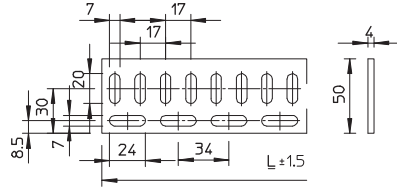

WESP 50 BK angle profile

St Steel
BK Bright

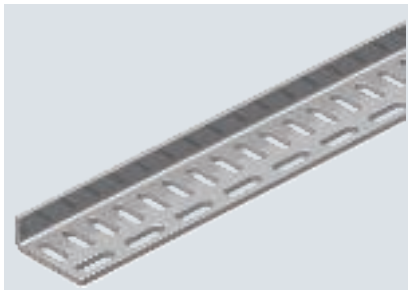

Angle profile with transverse and longitudinal perforation to create suspension and support constructions.

Type	Length mm	Metal thickness mm	Pack m	Weight kg/100 m	Item no.
WESP 50 20 BK	3000	4.00	3	159.000	7105665

0460 price/m

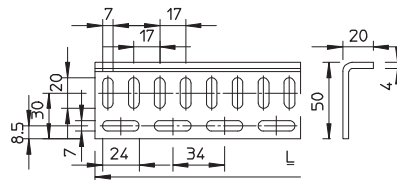

WESP 50 SG angle profile

St Steel
SG Welding primed
FT Hot-dip galvanised



Angle profile with longitudinal perforation row to create suspension and support constructions.

Type	Length mm	Metal thickness mm	Pack m	Weight kg/100 m	Item no.
WESP 50 40 SG	3000	4.00	3	239.340	7105675
WESP 50 40 FT	3000	4.00	3	246.340	7105673

0460 price/m

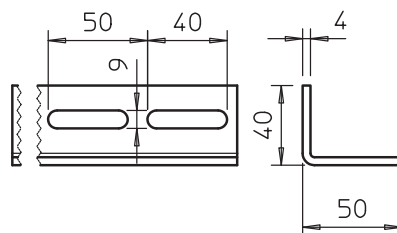

WESP 60 BK angle profile

St Steel
BK Bright

Type	Length mm	Metal thickness mm	Pack m	Weight kg/100 m	Item no.
WESP 60 15 BK	3000	4.00	3	179.000	7105967

0460 price/m

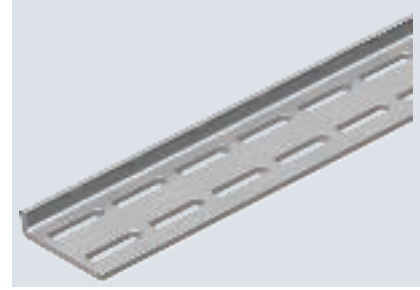
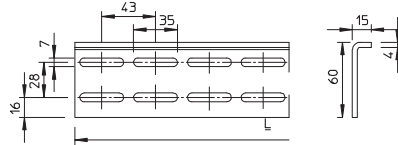

Angle profile with longitudinal perforation to create suspension and support constructions.

St Steel
FT Hot-dip galvanised

Type	Dimension mm	Pack Piece	Weight kg/100 pc.	Item no.
ASW FT	25x50	10	5.700	6015350

0415 /pc.

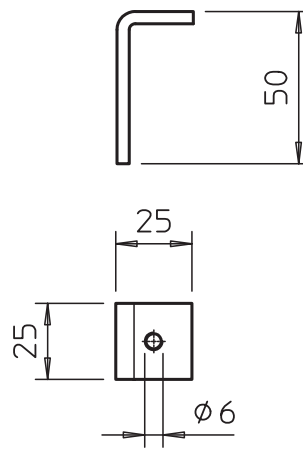

Welding angle for mounting shipbuilding cable ladders and marine trays, for welding to steel structures.

Truss-head bolt with nut and washer

- St** Steel
- VA** Stainless steel, rustproof 1.4301
- F** Hot galvanised

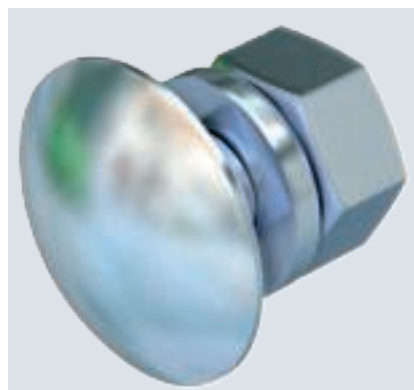

Truss-head bolt with square neck. With washer and hexagonal nut.

Type	Dimension mm	Dimension L mm	Dimension d mm	Dimension D mm	Resistance grade	Pack Piece	Weight kg/100 pc.	Item no.
FRS 8x25 F	M8x25	25	8	20	8.8	50	2.217	6406998
FRS 10x30 F	M10x30	30	10	24	8.8	50	4.187	6407579
FRS 8x25 A2	M8x25	25	8	20	A2-70	50	2.300	6406815
FRS 10x30 A2	M10x30	30	10	24	A2-70	50	4.500	6406726

0415 /100 pc.

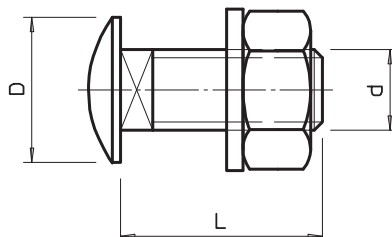

HS M6 hook screw

- A4** Stainless steel, rustproof
- 2B** Bright, reworked



Hook screw for fastening cable tracks on the bracket.

Type	Thread	Pack Piece	Weight kg/100 pc.	Item no.
HS M6x45 A4	M6	25	0.970	1154970
HS M8x60 A4	M8	25	2.330	1154975

0425 /100 pc.

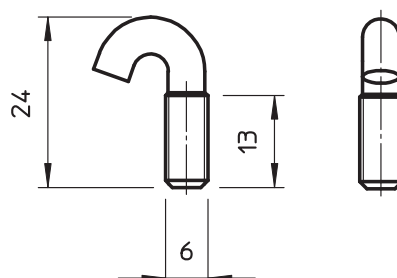

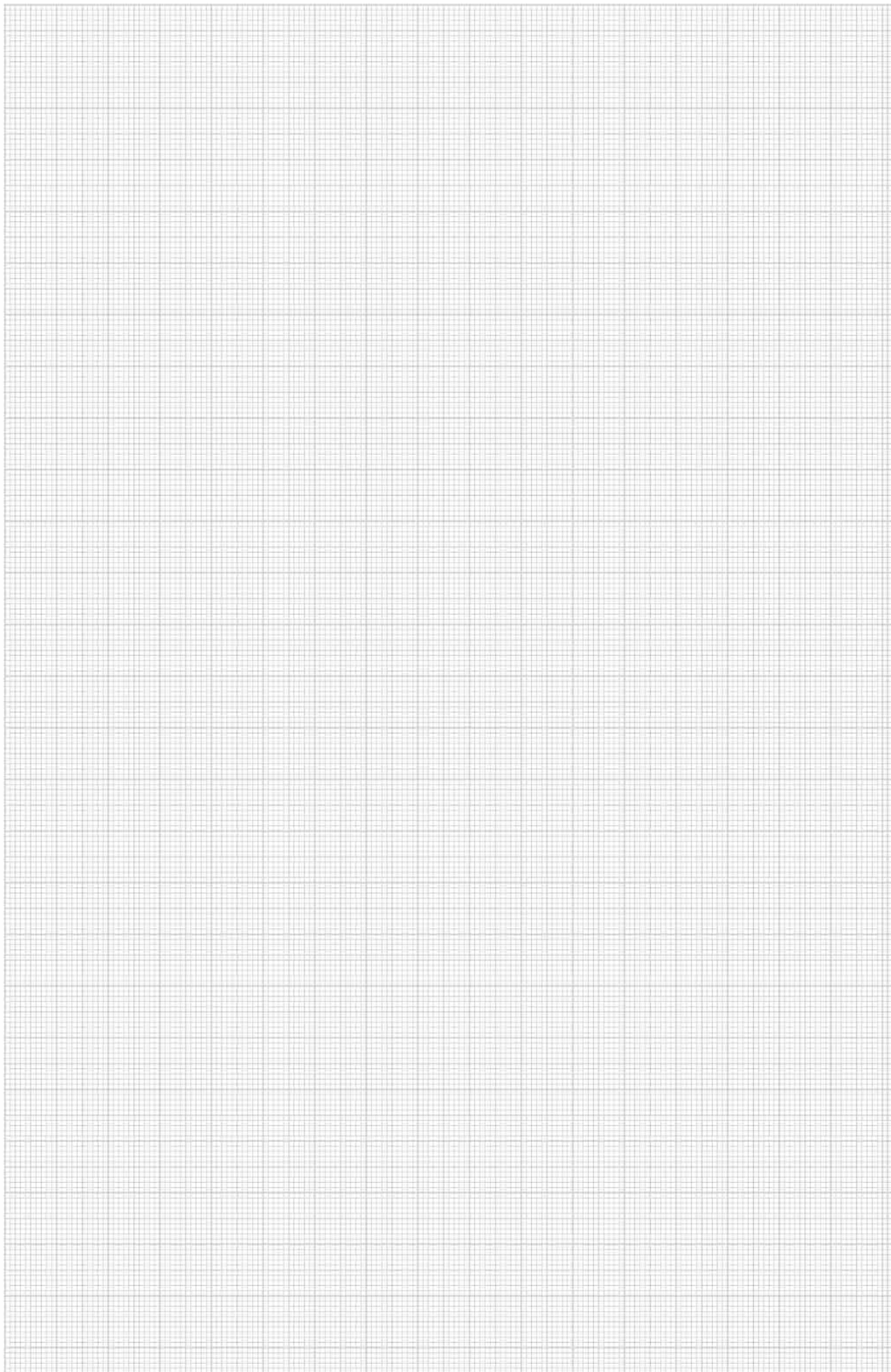

System accessories

Tightening strap

The tightening strap is perfectly suited as a system accessory for the fastening of cables to OBO cable support systems. The strap, which is made of galvanised steel or stainless steel with plastic jacketing, is extremely robust and friction-resistant. It is tested for tensile strength (kN) according to the material (strength) and is available in various colours.



Tightening strap on a roll SBR 8/SBR 15

Widths: 8 mm and 15 mm

Materials: Steel and stainless steel (A2 and A4)

Colours: Stone grey, jet black and chestnut brown

- Made of galvanised steel or stainless steel
- On a roll in a box: 25 m or 40 m
- Can be self-terminated

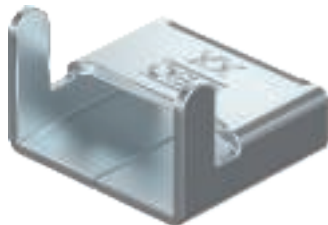

Tightening strap lock SBV 8/SBV 15

Widths: 8 mm and 15 mm

Materials: Steel and stainless steel (A2 and A4)

- Made of galvanised steel or stainless steel with plastic jacketing
- For lacing self-terminated tightening straps
- Quick, easy and safe installation



Tightening strap in fixed length SBF 8/SBF 15

Widths: 8 mm and 15 mm

Materials: Steel and stainless steel (A2 and A4)

Colours: Stone grey, jet black and chestnut brown

- Made of galvanised steel or stainless steel
- For lacing self-terminated tightening straps
- Pre-terminated, with tightening strap lock

FSK**A2K****A4K**

Tightening strap on a roll



Width in mm	FSK Strip galvanised, plastic-coated	A2K Stainless steel, plastic-coated	A4K Stainless steel, plastic-coated
8		●	●
15	●	●	●

Tightening strap lock

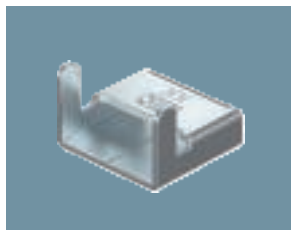

Width in mm	FS Strip galvanised, plastic-coated	A2 Stainless steel, plastic-coated	A4 Stainless steel, plastic-coated
8	●	●	●
15	●	●	●

Tightening strap in fixed length

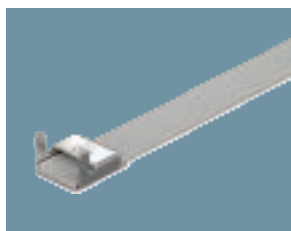

Width in mm	Length in mm	FSK Strip galvanised, plastic-coated	A2K Stainless steel, plastic-coated	A4K Stainless steel, plastic-coated
8	200	●	●	●
8	300	●	●	●
8	400	●	●	●
8	500	●	●	●
8	600	●	●	●
15	200	●	●	●
15	300	●	●	●
15	400	●	●	●
15	500	●	●	●
15	600	●	●	●
15	700	●	●	●
15	800	●	●	●
15	900	●	●	●
15	1,440	●	●	●

Mounting aid, spring chuck, type 575



Cutting the tightening strap to size
Cut the tightening strap to the required length (e.g. using metal cutters).



Tightening strap lock
Apply an appropriate tightening strap lock to the cut-out.

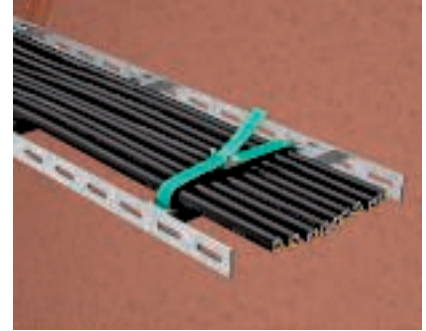

Fixing the tightening strap
Beforehand, fix the cables by hand using the pre-terminated tightening strap.



Tensioning
Insert the end of the cut-out in the spring chuck, type 575 and tension it.



Shortening the tightening strap
Turn the tightening strap over to prevent it from slipping out and shorten it as required (e.g. using metal cutters).



Knock the retaining strap over
Using pliers, knock the retaining straps tight.

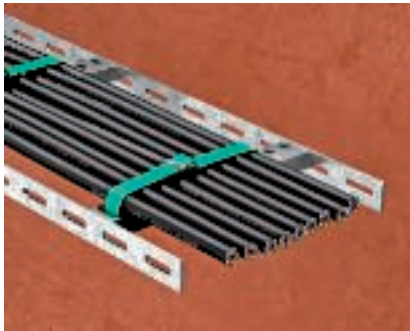

Local fastening
The local fastening of the cables is ensured.

Mounting aid, spring chuck, type 576



Cutting the tightening strap to size
Cut the tightening strap to the required length (e.g. using metal cutters).



Preparing the spring chuck
Prepare/adjust the spring chuck for installation.



Tightening strap lock
Apply an appropriate tightening strap lock to the cut-out.

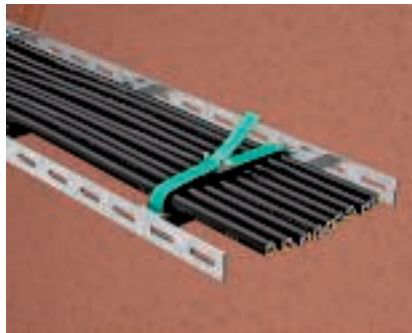

Fixing the tightening strap
Beforehand, fix the cables by hand using the pre-terminated tightening strap.



Tensioning
Insert the end of the cut-out in the spring chuck, type 576, and tension it.

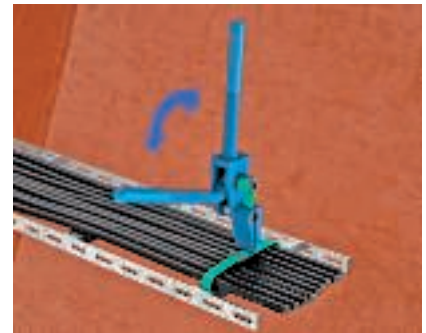

Shortening the tightening strap
Turn the tightening strap over to prevent it from slipping out and shorten it by pushing the spring chuck together.

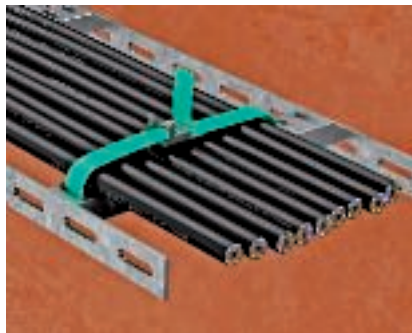

Turning the tightening strap
Turn the protruding end into the retaining straps provided.

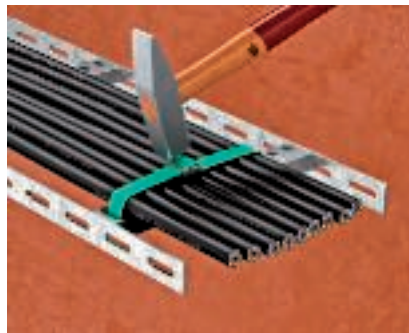

Knock the retaining strap over
Using a hammer, knock the retaining straps tight.

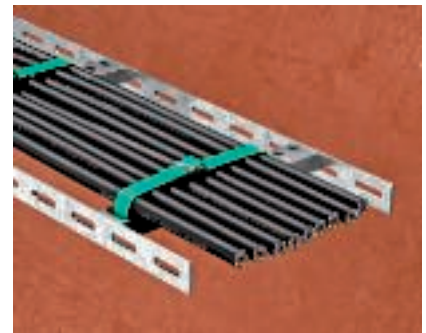

Local fastening
The local fastening of the cables is ensured.

SBR 8 tightening strap

- VA Stainless steel, rustproof 1.4301
- VA Stainless steel, rustproof 1.4571
- Plastic-coated



Type	Avg. breaking load kN	Colour	Pack m	Weight kg/100 m	Item no.
SBR 8 A2K	1.16	Jet black	40	2.840	6490192
SBR 8 A4K	1.09	Chestnut brown	40	2.840	6490194

0460

Tightening strap made of rustproof steel with plastic jacketing to fasten cables on cable support systems.

Dimensions

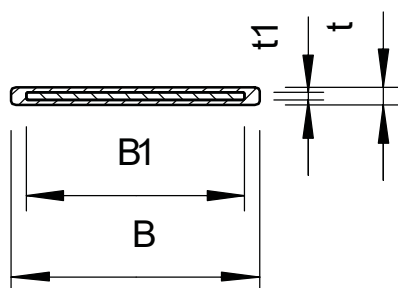

Type	Dimen- sion B mm	Dimen- sion t mm	Dimen- sion B1 mm	Dimen- sion t1 mm
SBR 8 A2K	9.3	1	8	0.3

SBV 8 tightening strap lock

- St Steel
- VA Stainless steel, rustproof 1.4301
- VA Stainless steel, rustproof 1.4404
- FS Strip galvanised
- 2B Bright, reworked

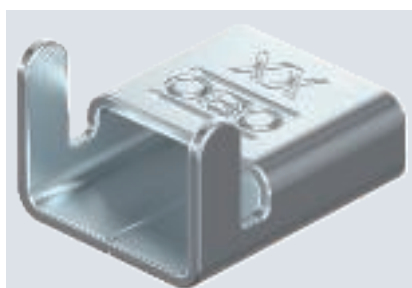

Type	Pack Piece	Weight kg/100 pc.	Item no.
SBV 8 FS	100	0.250	6490940
SBV 8 A2	100	0.250	6490942
SBV 8 A4	100	0.250	6490944

0460 /100 pc.

Tightening strap lock made of strip-galvanised steel, suitable for portfolio with 8 mm width.

SBR 15 tightening strap

- St** Steel
- VA** Stainless steel, rustproof 1.4301
- VA** Stainless steel, rustproof 1.4571
- FSK** Strip galvanised/powder-coated
- Plastic-coated

Type	Avg. breaking load kN	Colour	Pack m	Weight kg/100 m	Item no.
SBR 15 FSK	2.5	Stone grey	25	7.628	6490280
SBR 15 A2K	4.19	Jet black	25	7.628	6490282
SBR 15 A4K	3.93	Chestnut brown	25	7.628	6490284

0460 price/100 m



Tightening strap made of strip-galvanised steel with plastic jacketing to fasten cables on cable support systems.

Type	Dimen- sion B mm	Dimen- sion t mm	Dimen- sion B1 mm	Dimen- sion t1 mm
SBR 15 FSK	17	1.2	15	0.5

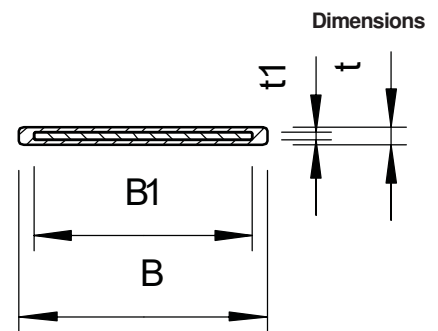

12 LSB Lösungskatalog Schiffbau International 2020 / en / 2020/11/24 10:37:22 (LLExpert_02803) / 2020/11/24 10:38:06

- St** Steel
- VA** Stainless steel, rustproof 1.4301
- VA** Stainless steel, rustproof 1.4404
- FS** Strip galvanised
- 2B** Bright, reworked

SBV 15 tightening strap lock

Type	Pack Piece	Weight kg/100 pc.	Item no.
SBV 15 FS	100	0.560	6490950
SBV 15 A2	100	0.564	6490964
SBV 15 A4	100	0.560	6490972

0460 /100 pc.

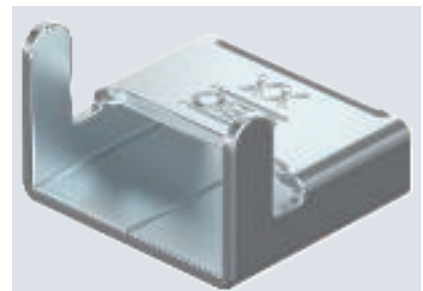

Tightening strap lock made of strip-galvanised steel, suitable for a range of products with a 15 mm width.

SBF 8 tightening strap in fixed lengths

VA Stainless steel, rustproof 1.4301

VA Stainless steel, rustproof 1.4571

Plastic-coated

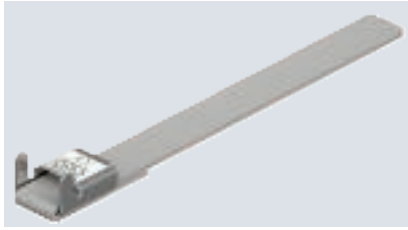

Pre-terminated tightening strap made of rustproof steel with plastic jacketing and tightening strap lock.

Type	Length mm	Avg. breaking load kN	Colour	Pack Piece	Weight kg/100 pc.	Item no.
SBF 8-200 A2K	200	1.16	Jet black	25	0.700	6490210
SBF 8-300 A2K	300	1.16	Jet black	25	1.000	6490214
SBF 8-400 A2K	400	1.16	Jet black	25	1.300	6490218
SBF 8-500 A2K	500	1.16	Jet black	25	1.600	6490222
SBF 8-600 A2K	600	1.16	Jet black	25	1.800	6490226
SBF 8-200 A4K	200	1.09	Chestnut brown	25	0.700	6490240
SBF 8-300 A4K	300	1.09	Chestnut brown	25	1.000	6490244
SBF 8-400 A4K	400	1.09	Chestnut brown	25	1.300	6490248
SBF 8-500 A4K	500	1.09	Chestnut brown	25	1.600	6490252
SBF 8-600 A4K	600	1.09	Chestnut brown	25	1.800	6490256

0460 /100 pc.

Dimensions

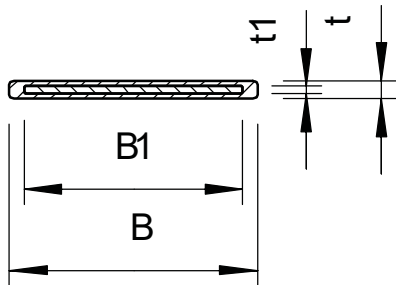

Type	Dimen- sion B mm	Dimen- sion t mm	Dimen- sion B1 mm	Dimen- sion t1 mm
SBF 8-200 A2K	9.3	1	8	0.3
SBF 8-300 A2K	9.3	1	8	0.3
SBF 8-400 A2K	9.3	1	8	0.3
SBF 8-500 A2K	9.3	1	8	0.3
SBF 8-600 A2K	9.3	1	8	0.3

SBF 15 tightening strap in fixed lengths

- St** Steel
- VA** Stainless steel, rustproof 1.4301
- VA** Stainless steel, rustproof 1.4571
- FSK** Strip galvanised/powder-coated
- Plastic-coated

Type	Length mm	Avg. breaking load kN	Colour	Pack Piece	Weight kg/100 pc.	Item no.
SBF 15-300 FSK	300	2.5	Stone grey	25	2.600	6490300
SBF 15-400 FSK	400	2.5	Stone grey	25	3.300	6490304
SBF 15-500 FSK	500	2.5	Stone grey	25	4.100	6490308
SBF 15-600 FSK	600	2.5	Stone grey	25	4.800	6490312
SBF 15-700 FSK	700	2.5	Stone grey	25	5.500	6490316
SBF 15-800 FSK	800	2.5	Stone grey	25	6.200	6490320
SBF 15-900 FSK	900	2.5	Stone grey	25	6.900	6490324
SBF 15-1000 FSK	1000	2.5	Stone grey	25	7.600	6490328
SBF 15-300 A2K	300	4.19	Jet black	25	2.600	6490340
SBF 15-500 A2K	500	4.19	Jet black	25	4.100	6490348
SBF 15-600 A2K	600	4.19	Jet black	25	4.800	6490352
SBF 15-700 A2K	700	4.19	Jet black	25	5.500	6490356
SBF 15-800 A2K	800	4.19	Jet black	25	6.200	6490360
SBF 15-900 A2K	900	4.19	Jet black	25	6.900	6490364
SBF 15-1000 A2K	1000	4.19	Jet black	25	7.600	6490368
SBF 15-300 A4K	300	3.93	Chestnut brown	25	2.600	6490380
SBF 15-400 A4K	400	3.93	Chestnut brown	25	3.300	6490384
SBF 15-500 A4K	500	3.93	Chestnut brown	25	4.100	6490388
SBF 15-600 A4K	600	3.93	Chestnut brown	25	4.800	6490392
SBF 15-700 A4K	700	3.93	Chestnut brown	25	5.500	6490396
SBF 15-800 A4K	800	3.93	Chestnut brown	25	6.200	6490400
SBF 15-900 A4K	900	3.93	Chestnut brown	25	6.900	6490404
SBF 15-1000 A4K	1000	3.93	Chestnut brown	25	7.600	6490408



Pre-terminated tightening strap made of strip-galvanised steel with plastic jacketing and tightening strap lock.

0460 /100 pc.

Type	Dimension B mm	Dimension t mm	Dimension B1 mm	Dimension t1 mm
SBF 15-300 FSK	17	1.2	15	0.5
SBF 15-400 FSK	17	1.2	15	0.5
SBF 15-500 FSK	17	1.2	15	0.5
SBF 15-600 FSK	17	1.2	15	0.5
SBF 15-700 FSK	17	1.2	15	0.5
SBF 15-800 FSK	17	1.2	15	0.5
SBF 15-900 FSK	17	1.2	15	0.5
SBF 15-1000 FSK	17	1.2	15	0.5

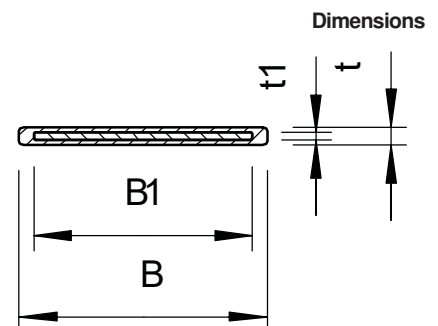

Spring chuck

St Steel



Type	Pack Piece	Weight kg/100 pc.	Item no.
575	1	29.700	6498019

0460 /pc.

Clamping tool for all OBO tightening straps in conjunction with appropriate tightening strap locks. Simple spring chuck without ratchet function and shortening unit. With ergonomically shaped grips.

Spring chuck

St Steel



Type	Pack Piece	Weight kg/100 pc.	Item no.
576	1	132.000	6498027

0460 /pc.

Clamping tool for all OBO tightening straps in conjunction with appropriate tightening strap locks. With high clamping force, ratchet function, shortening unit and round grips for pleasant handling.

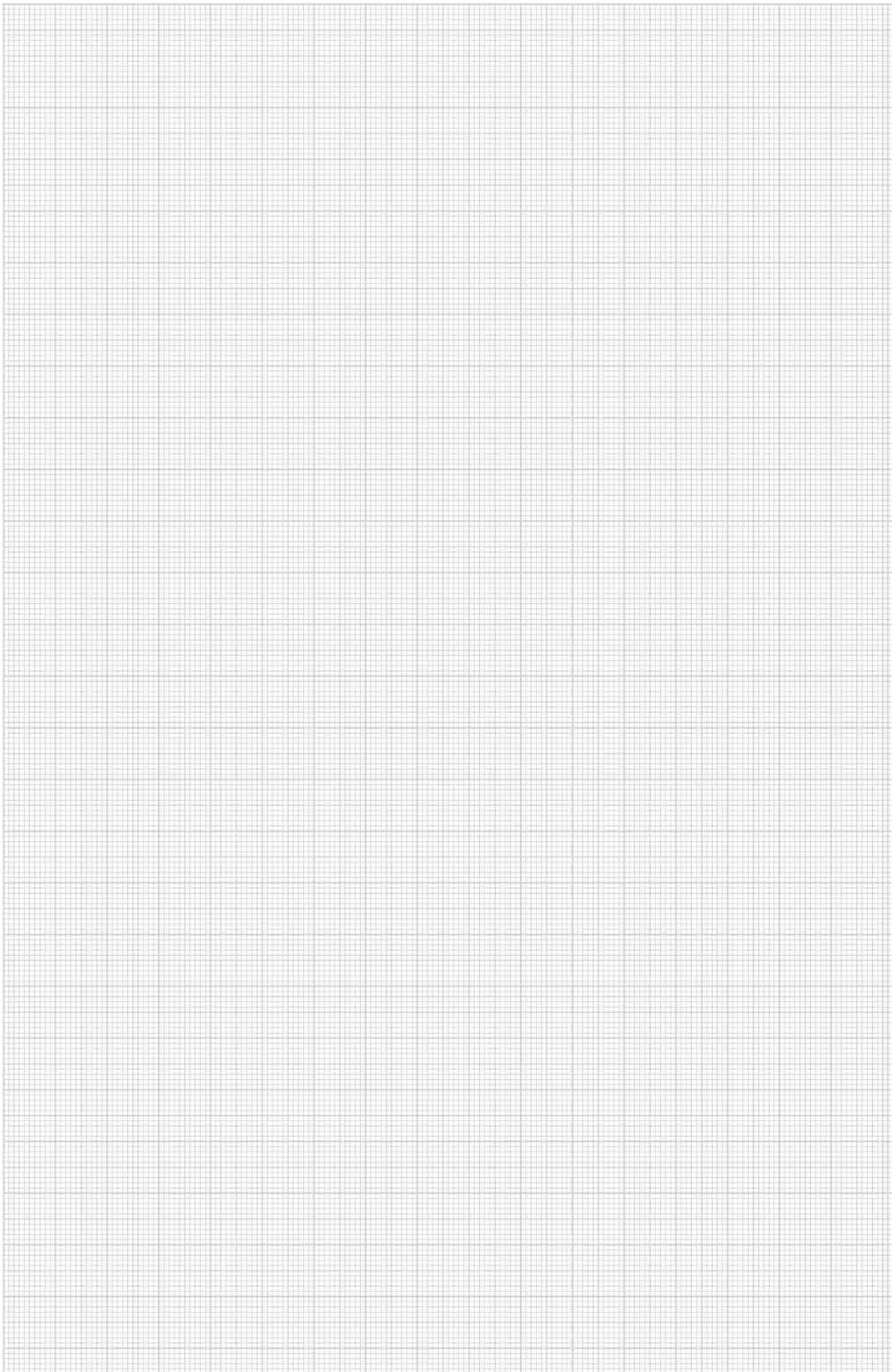

Certified? Certainly!

The shipbuilding cable ladder systems, together with their accessories, are certified according to the classification rules of the DNV GL – Maritime standards. The OBO systems can be installed, without restriction, for use in all ships and offshore units according to the DNV GL classification. A test according to the regulations for safety, reliability and environmental protection requirements for operation in international waters is therefore no problem.

DNV·GL

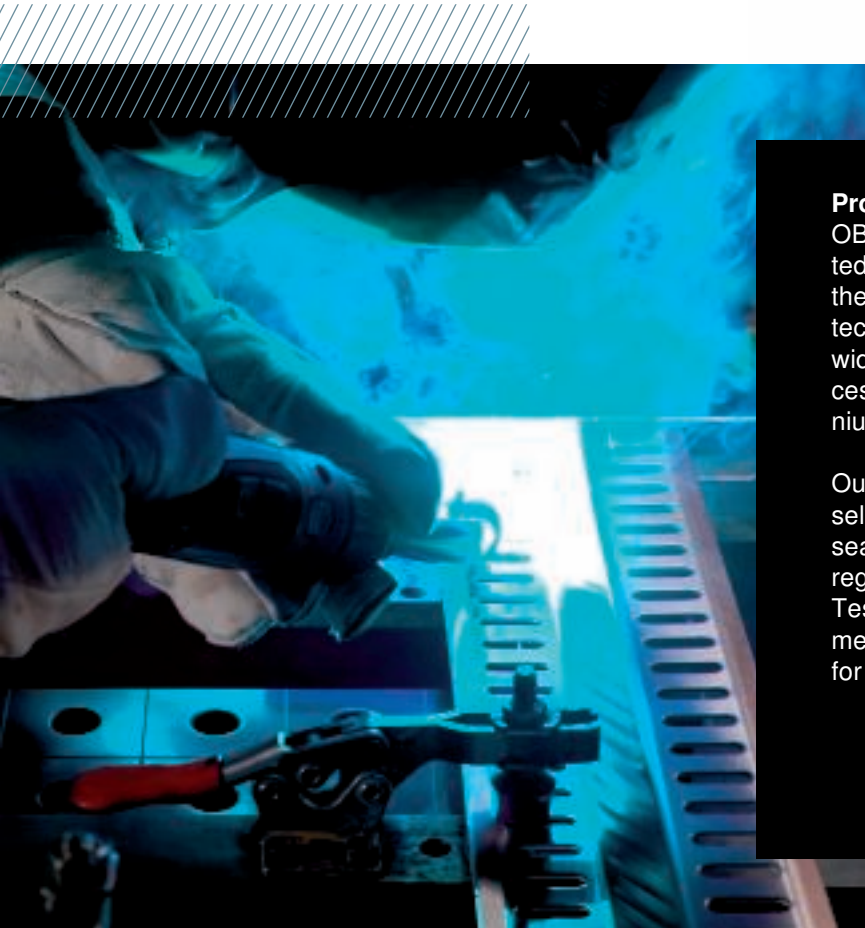

Produced with state-of-the-art technology

OBO cable ladder systems for shipbuilding are created in a fully automated production process, in which the latest robot technology is used. The high-quality technical equipment guarantees an end product with a wide range of materials, as the welding robot can process not just steel, but also stainless steel and aluminium.

Our shipbuilding cable ladders are also welded precisely by specialist personnel. The continuous throat seam ensures the highest level of stability, which we regularly check and have certified through our BET Test Centre. This highly corrosive welding connection means that OBO shipbuilding cable ladders are ready for the toughest offshore requirements.

Welding operation for the shipbuilding cable ladder

BET Test Centre

Quality assurance



The special testing systems in the BET Test Centre allow comprehensive product tests and guarantee the OBO Bettermann quality. Thanks to continuous further developments and adaptations to the latest requirements, the prescribed DIN tests can be carried out and documented.

Conductivity test

Electrically conductive cable support systems are tested according to DIN EN 61537 and electrically conductive electrical installation duct systems are tested according to DIN EN 50085. The conductivity is tested at connection points with an AC current of 25 A. The impedance (measured voltage/AC) may not exceed 5 m Ω /m along the length of a cable support. The impedance may not exceed 50 m Ω across a connection.

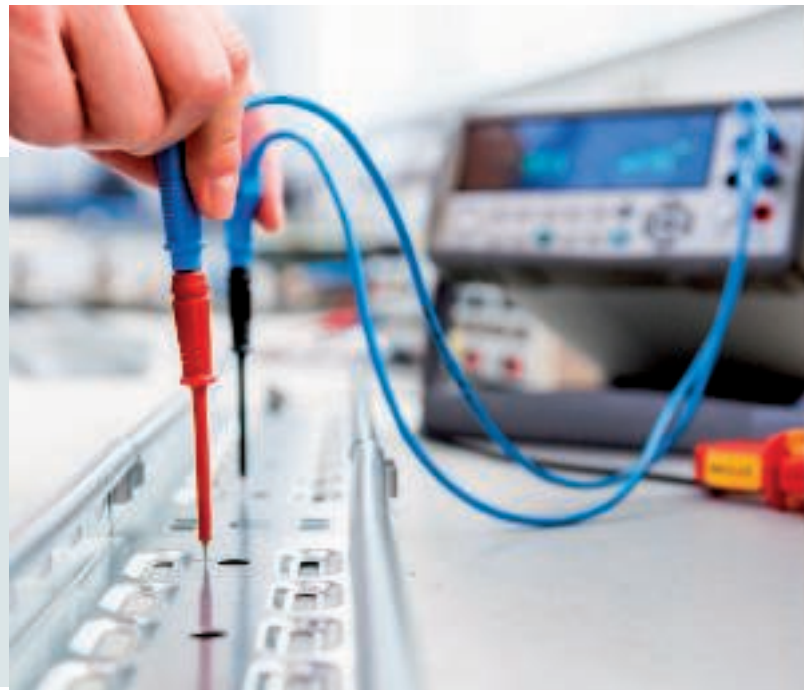

IK classification

The IK classification to EN 50102 grades the mechanical stability of electrical installation duct systems. K09 ensures the requirements for the highest impact resistance are fulfilled.



IP protection rating

The IP protection rating describes the protection provided by the housing, such as touch and moisture protection, and the protection of the installation against foreign bodies. This test is carried out according to EN 60529.



Safe working load

The safe working loads (SWL), and therefore the reliable load-bearing capacities of the systems, are tested according to DIN EN 61537.

OBO Bettermann Vertrieb Deutschland GmbH Co. KG

Langer Brauck 25
58640 Iserlohn
GERMANY

Customer Service Germany

Tel.: +49 (0)2371 7899-2000
Fax: +49 (0)2371 7899-2500
export@obo.de

www.obo-bettermann.com

Building Connections

